

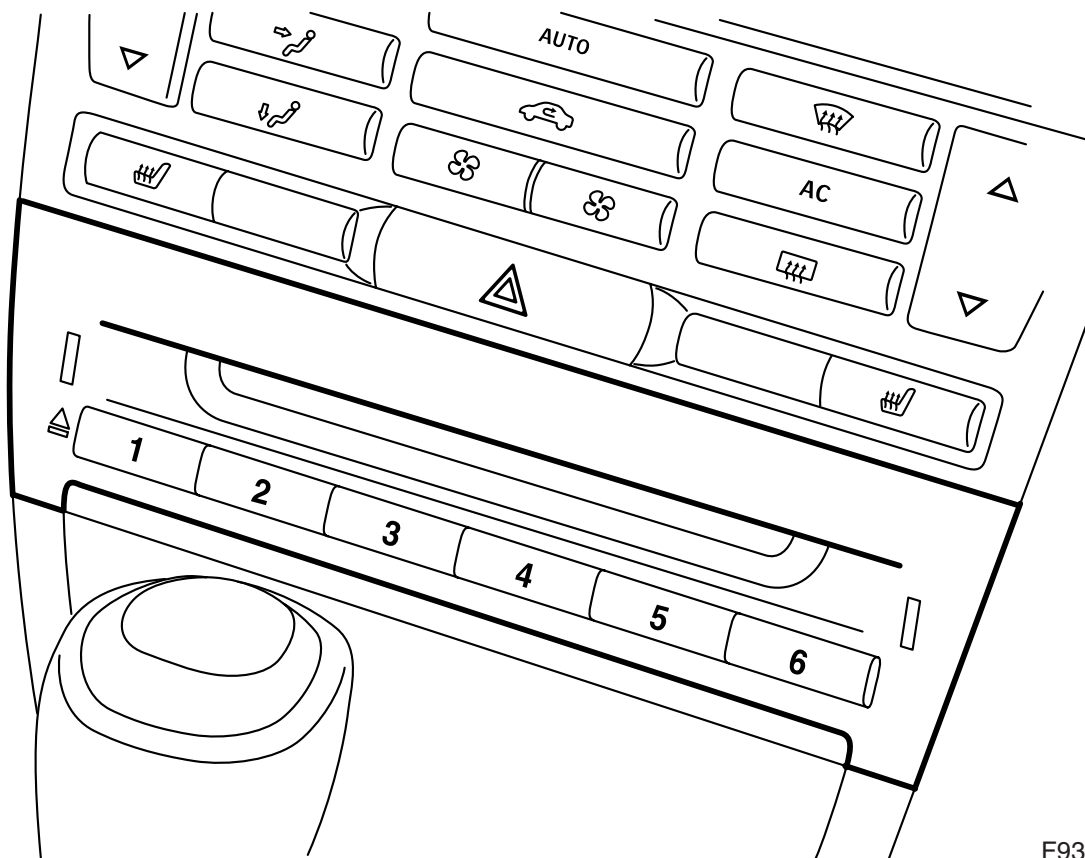

**MONTERINGSANVISNING · INSTALLATION INSTRUCTIONS
MONTAGEANLEITUNG · INSTRUCTIONS DE MONTAGE**

Saab 9-3 M03-
CD player/CD changer

Accessories Part No.	Group	Date	Instruction Part No.	Replaces
12 787 146 12 787 152	9:85-23	Jan 03	12 788 458	12 788 458 Aug 02



F930A055

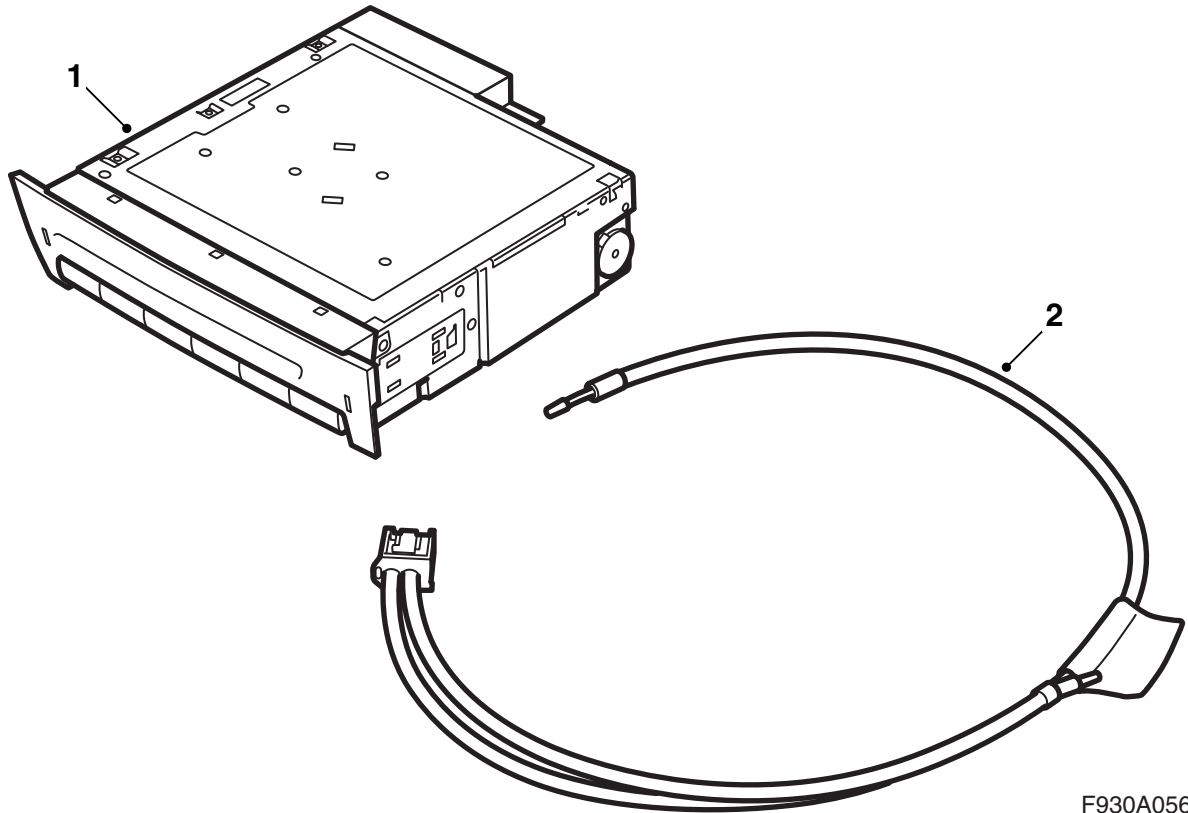

12 787 146 CD changer kit

- 1 CD changer
- 2 Fibre-optic cable

12 787 152 CD player kit

- 1 CD player
- 2 Fibre-optic cable

To fit CD player/CD changer, see page 3

To replace CD player with CD changer, see page 10

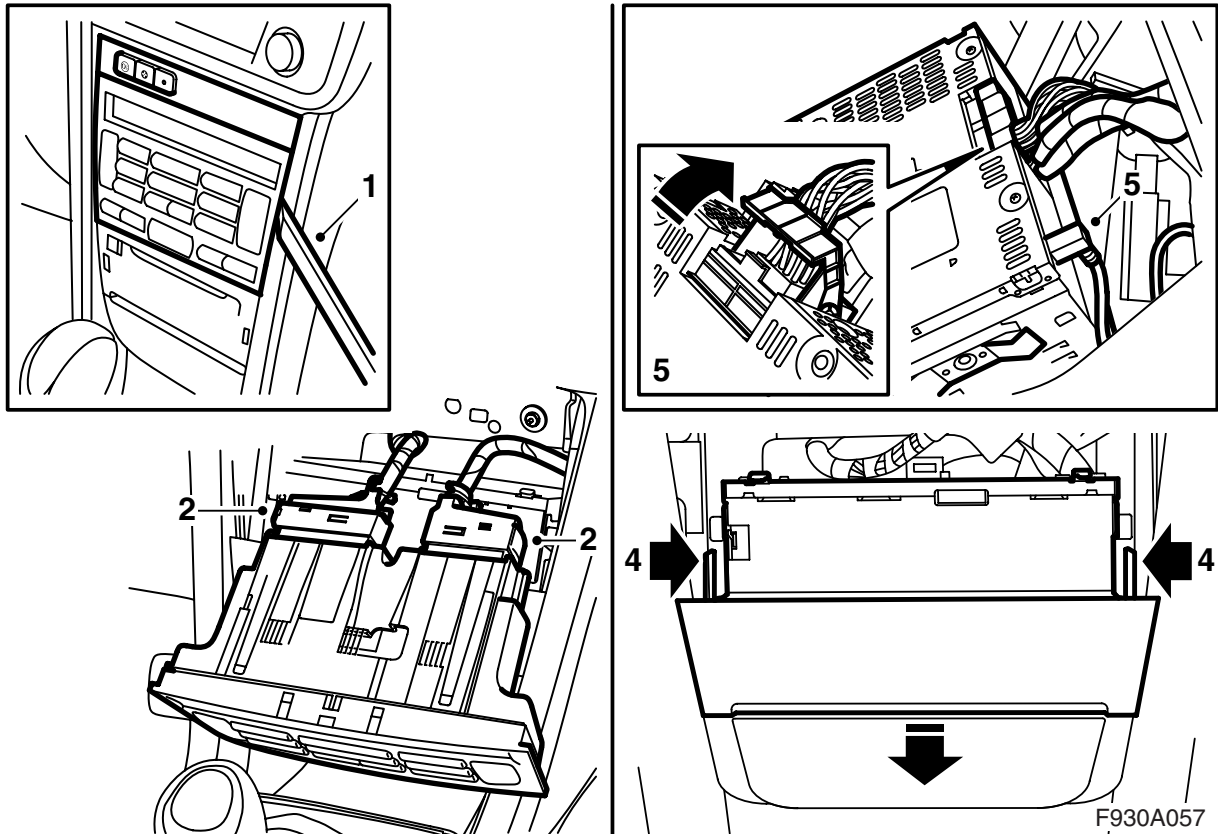

To fit CD player/CD changer

- 1 Remove the climate system control panel by pulling it out carefully. Use removal tool 82 93 474.
- 2 Remove the control panel connectors.
- 3 Remove the cover located below the ACC or MCC unit.
- 4 Remove the entertainment head unit by pushing in the two catches.
- 5 Remove the head unit connectors.

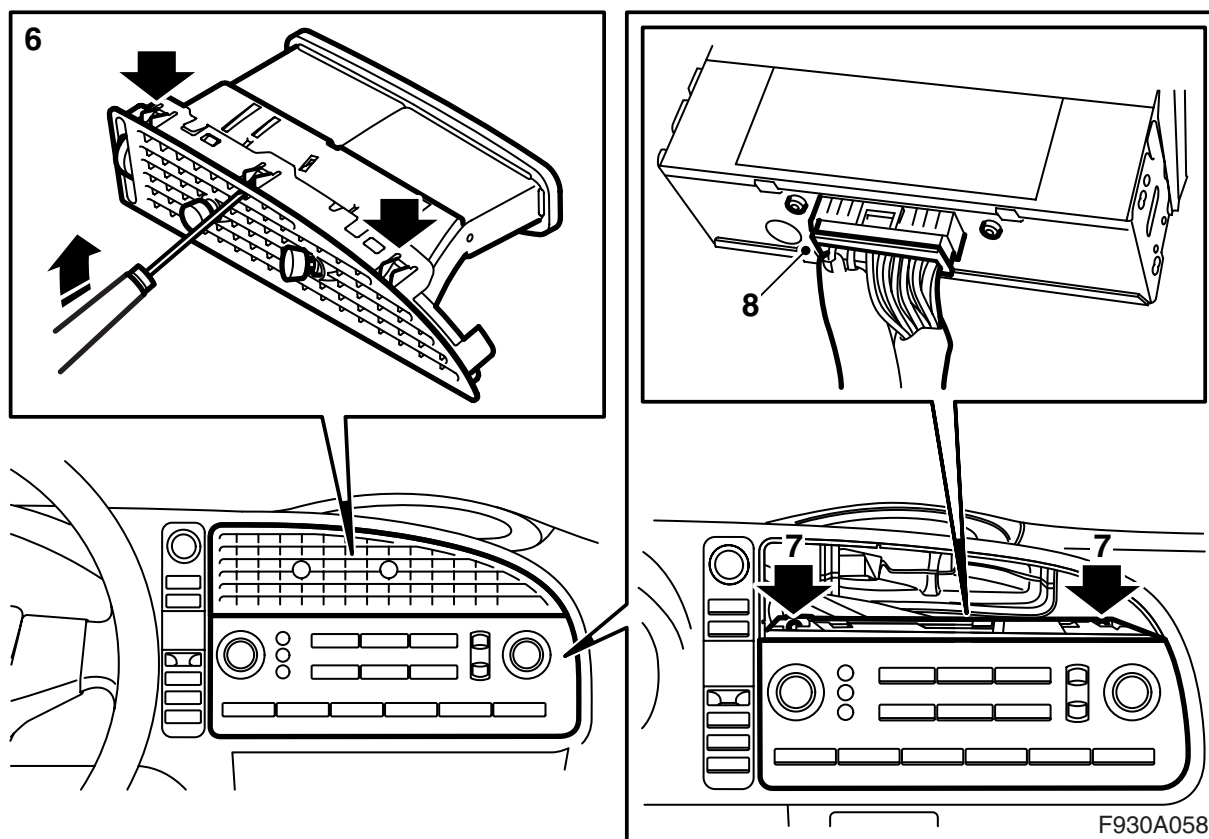

- 6 Remove the centre dashboard vent by carefully bending in the three upper hooks which are accessible through the grille while simultaneously pulling the guide pin straight out.

Important

Take care to bend the correct hooks. Hooks holding together the air outlet are also visible behind the grille.

- 7 Remove the infotainment system control panel.
8 Lift out the control panel and remove the connector.

WARNING

The visible red light is a class 1 laser. Do not look directly into the optical fibre or the control module connector at close range. A distance of less than 20 mm between your eyes and the light source may cause eye injury.

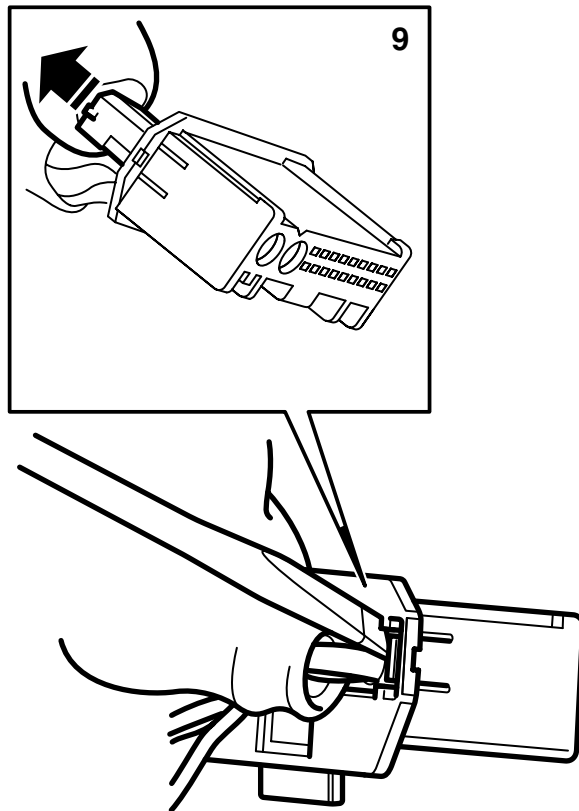

9 Remove the fibre optic cable connector (small connector) from the control panel connector.

Important

Handle the fibre-optic cables with care or the signal may be distorted.

- It is very important that the two leads in the connector are not confused with one another.
- Do not splice the cables.
- Do not bend the cable in a radius smaller than 25 mm.
- Do not expose the cable to temperatures exceeding 85 °C.
- Keep the cable ends free from dirt and grime.
- Do not expose the cable to impact as this may cause the transparent plastic to whiten, thereby reducing the intensity of the light and causing possible communication interruptions.
- The cable should not lie against any sharp edges as this may cause increased signal reduction.

10 Remove the fibre optic cable connected to position 1 by opening the connector locking clip and carefully lifting the hook.

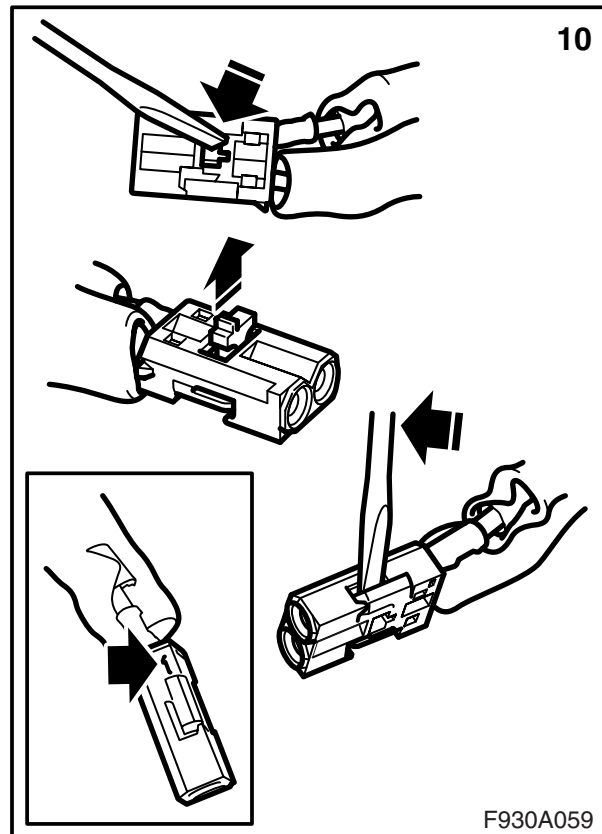

11 Insert the long section of the fibre optic cable in the accessory kit along the car's normal cable harness inside the dashboard.

12 Remove the protective cover from the connection on the accessory kit fibre optic cable.

13 Fit the protective cover onto the removed fibre optic cable connection and carefully move the fibre optic cable aside in order to prevent damage.

14 Fit the accessory kit fibre optic cable connection in position 1 in the small connector to the control unit. Fit the locking clip.

15 Fit the small connector to the large connector.

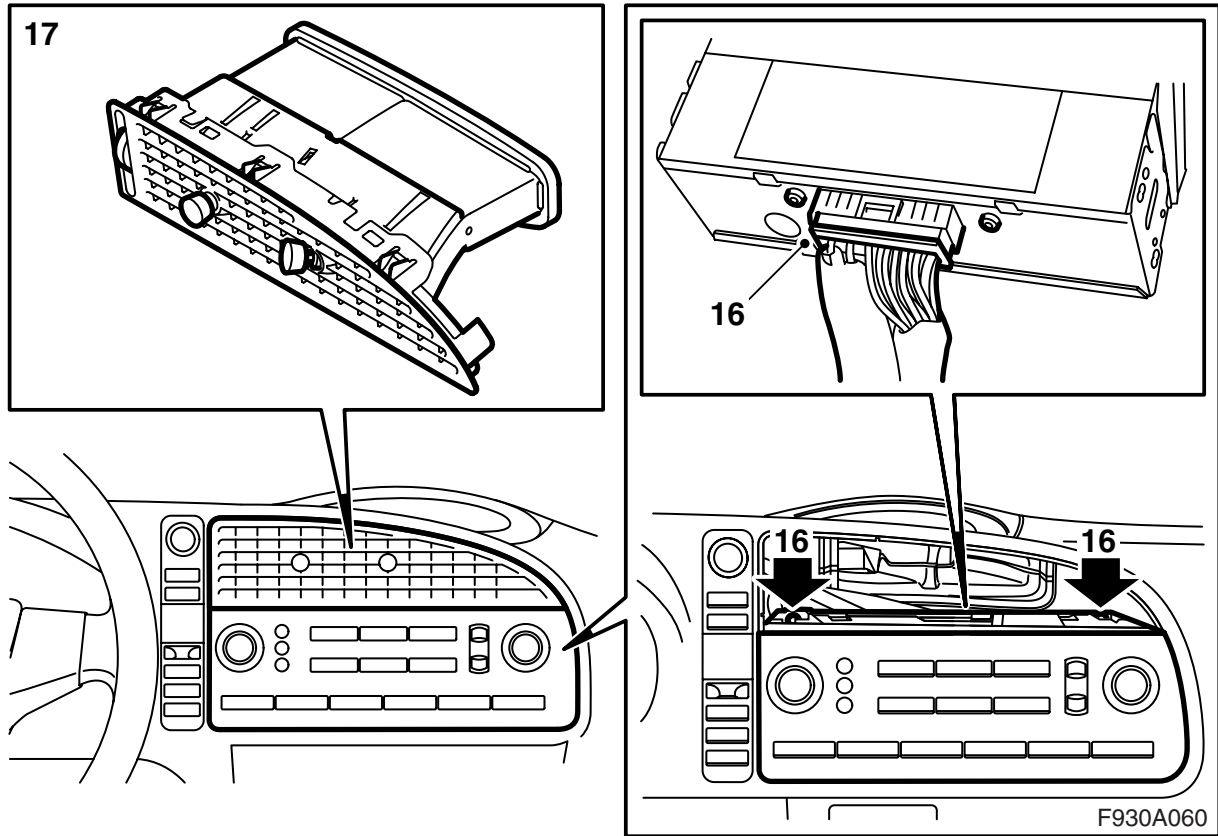

16 Plug in the control panel connector and fit the control panel.

17 Fit the dashboard vent.

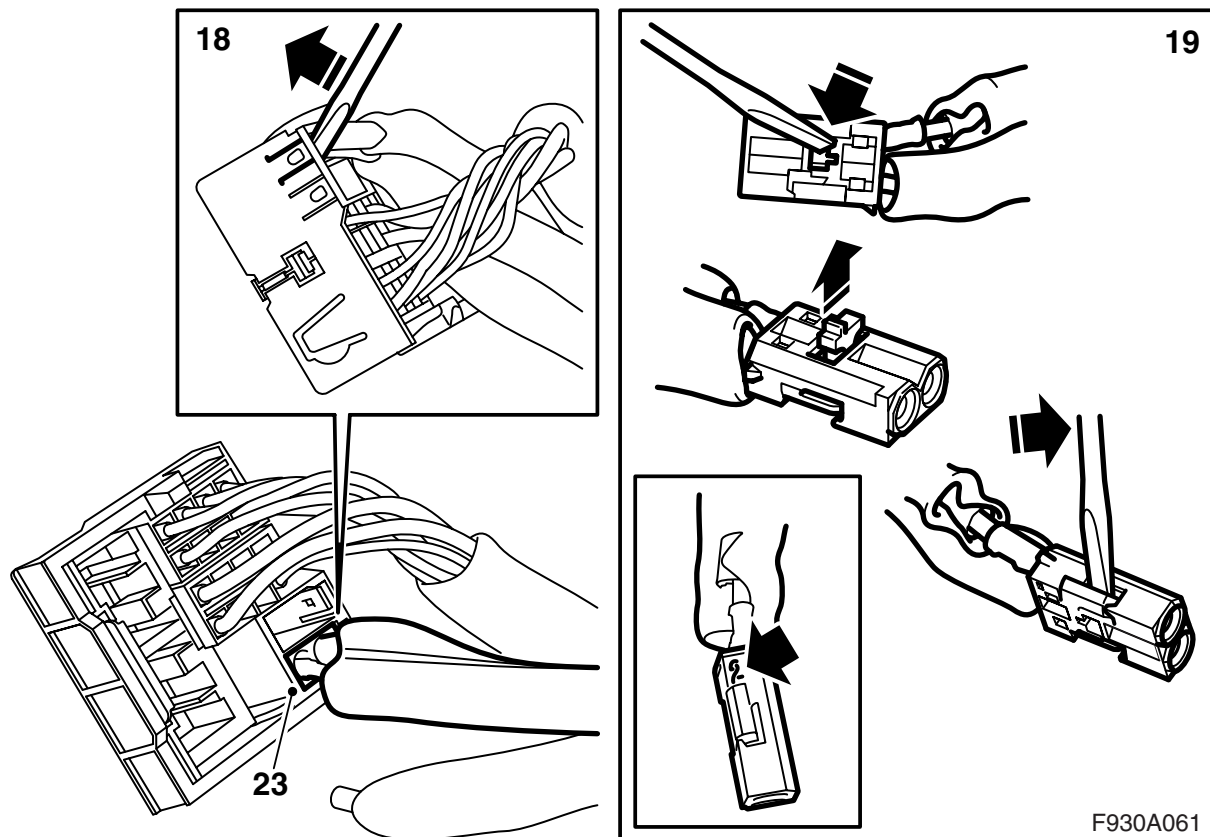

- 18 Remove the small connector from the large connector for the entertainment head unit.

Important

Take note of the location of the small connector since it is possible to fit the connector incorrectly.

- 19 Remove the fibre optic cable which is connected to position 2 by opening the connector locking clip and carefully lifting the hook.
- 20 Remove the protective cover from the connection on the accessory kit fibre optic cable.
- 21 Fit the protective cover onto the removed fibre optic cable connection.
- 22 Fit the connection on the accessory kit fibre optic cable to position 2 in the small connector in the entertainment head unit. Fit the locking clip.
- 23 Fit the small connector to the large connector.

Important

Take note of the small connector location since it is easy to fit the connector incorrectly.

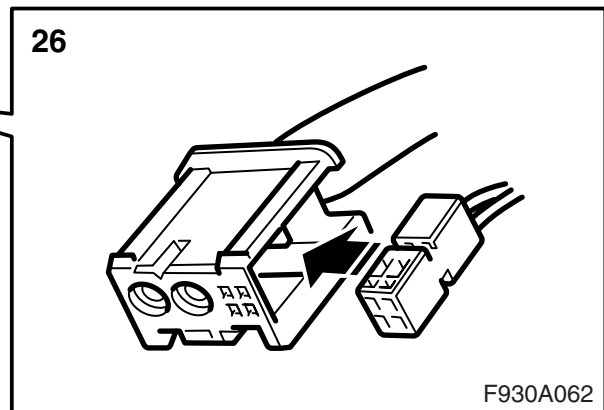
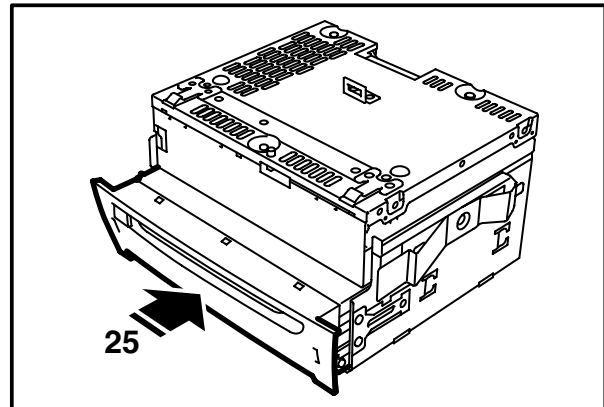
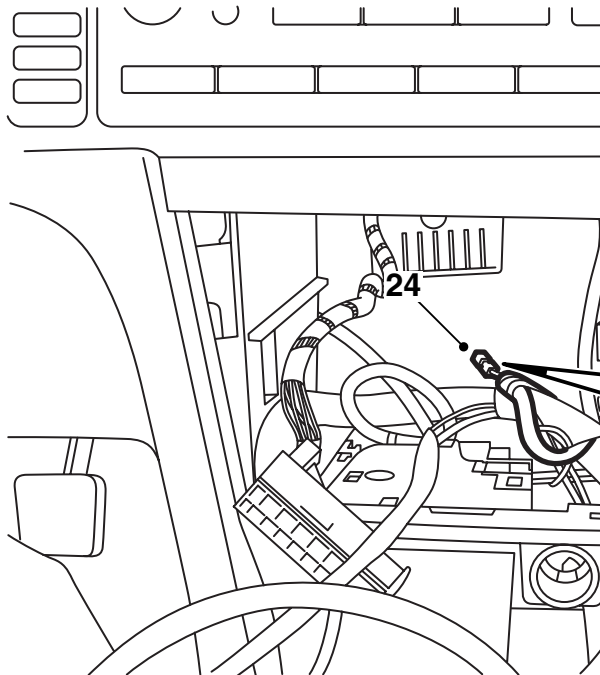

- 24 Find the power supply for the CD player/CD changer in cable harness. The connector is secured with a bit of tape to the cable trunk behind the location for the entertainment head unit. Remove the bit of tape and pull the cable harness forwards.
- 25 Remove the transport fuse placed on the top side of the CD player/CD changer. Insert and fit the CD player/CD changer in the entertainment head unit bracket.
- 26 Fit the connector for CD player/CD changer power supply in the connector for the accessory kit fibre optic cable.

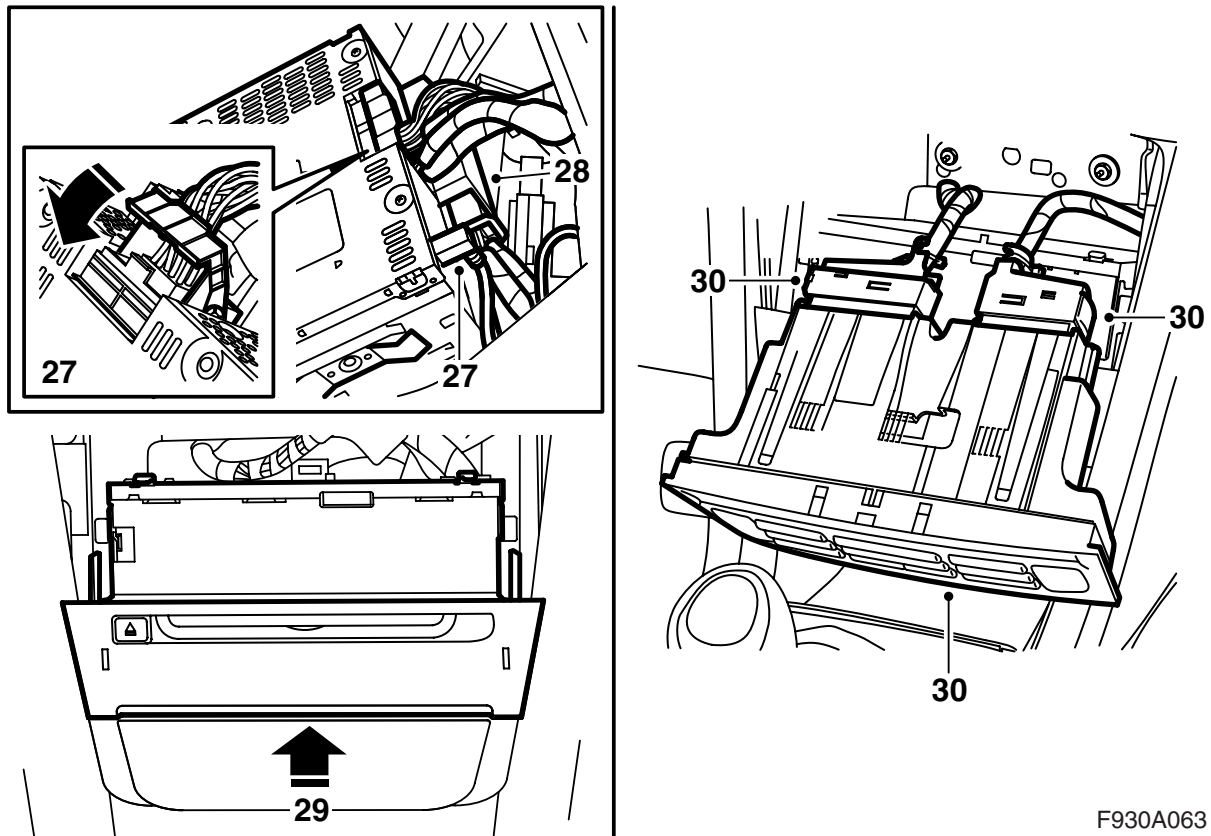

- 27 Plug in the connector to the entertainment head unit.
- 28 Plug in the connector to the CD player/CD changer.
- 29 Fit the entertainment head unit.
- 30 Connect and fit the climate system control panel.
- 31 Connect the diagnostic tool, select car and model year, select "All", select "Add/Remove", select the accessory and then "Add".
- 32 Check CD player/CD changer function.

F930A063

Switch from CD player to CD changer.

- Connect the diagnostic tool, select car and model year, select “All”, select “Add/Remove”, select the accessory and then “Remove”.
- Perform steps 1-5 in this installation instruction.
- Remove the connector from the CD player.
- Remove the CD player with removal tool 84 71 203.
- Perform step 25 and steps 27-32 in this installation instruction.
- Connect the diagnostic tool, select car and model year, select “All”, select “Add/Remove”, select the accessory and then “Add”.