



**MONTERINGSANVISNING · INSTALLATION INSTRUCTIONS  
MONTAGEANLEITUNG · INSTRUCTIONS DE MONTAGE**

**Saab 9-3 M03-**

**Hands free kit, mobile phone**

Accessories Part No.	Group	Date	Instruction Part No.	Replaces
12 787 155	9:39-09	Apr 03	12 788 465	12 788 465 Jan 03

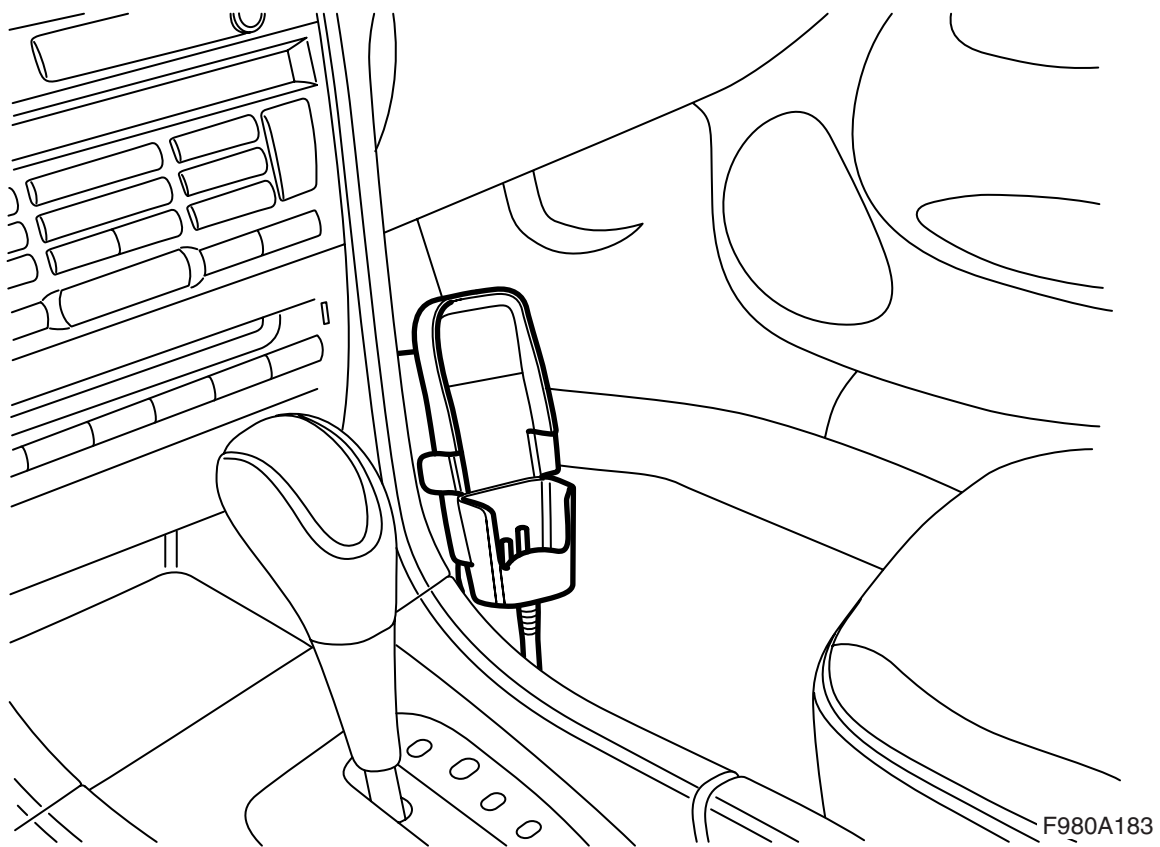

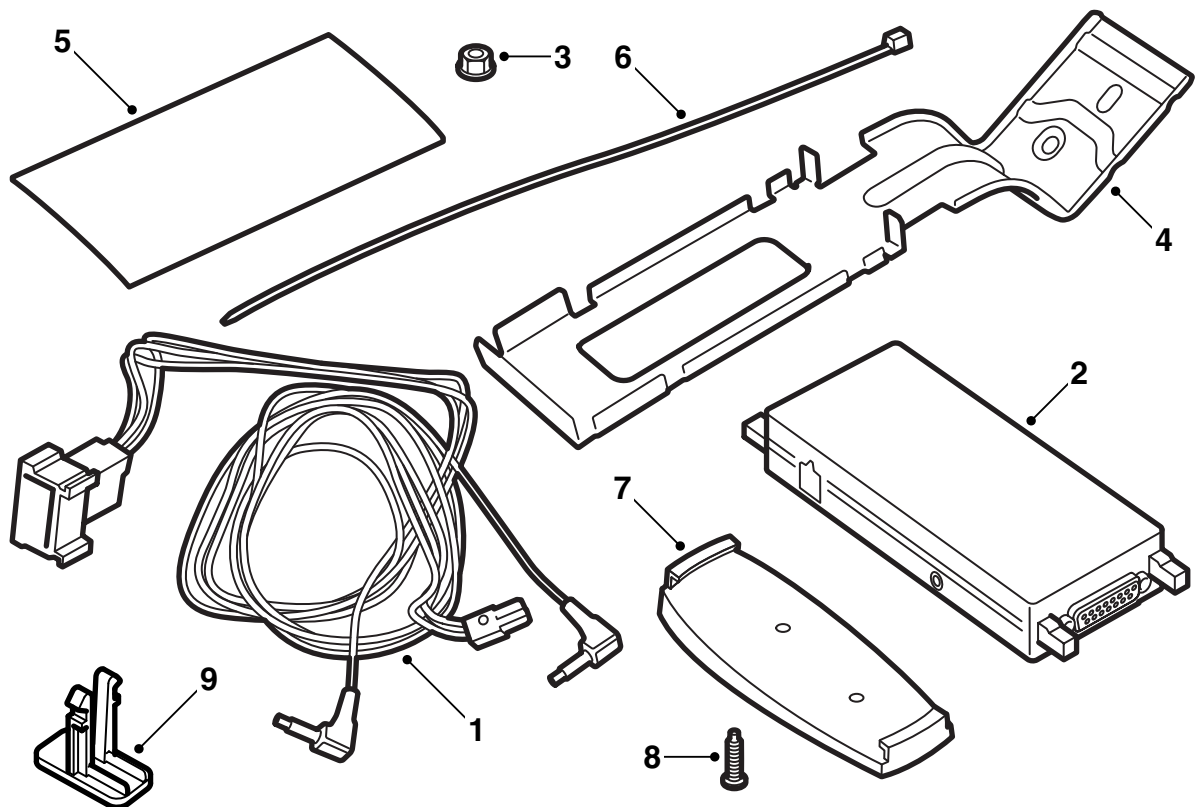

F980A184

- 1 Wiring harness
- 2 Electronic unit
- 3 Nut
- 4 Bracket
- 5 Tape (x2)
- 6 Cable tie (x3)
- 7 Bracket, telephone holder
- 8 Bolt (x2)
- 9 Lock

---

**Important**

The kit can contain four screws which are not used.

---

**In addition, the following items are required (ordered separately)**

- Connection kit for the telephone in question
- Telephone bracket
- Antenna cable (certain models)
- Microphone (certain cars)

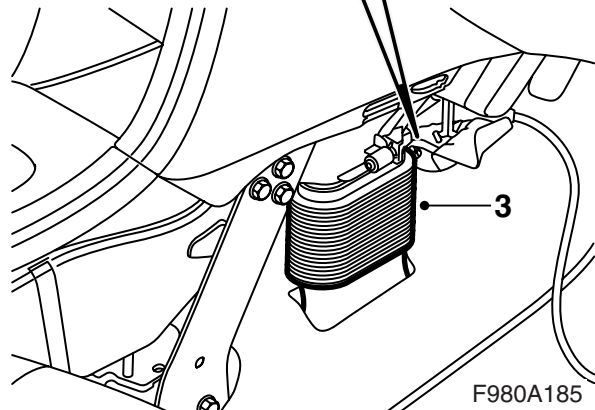
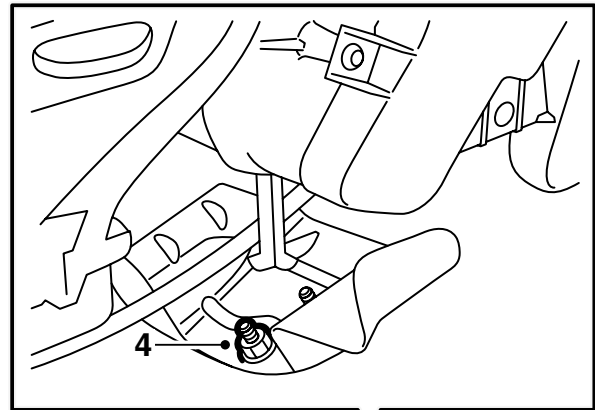
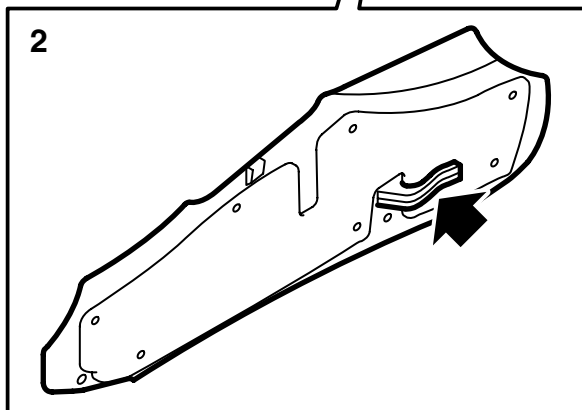
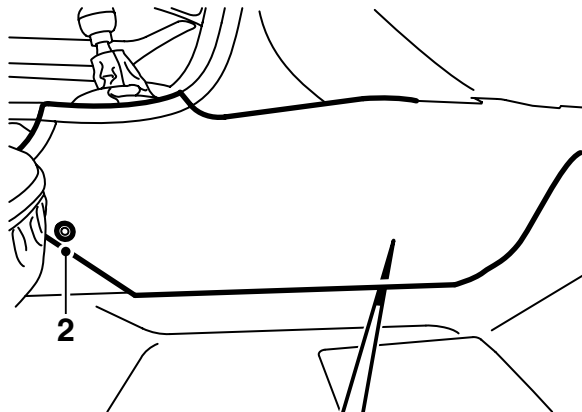

F980A185

- 1 Remove the battery negative cable and take the key from the ignition.
- 2 **LHD:** Remove the centre console right-hand side panel.  
**RHD:** Remove the centre console left-hand side panel.
- 3 **LHD:** Remove the right-hand air duct bellows.  
**RHD:** Remove the left-hand air duct bellows.
- 4 Remove the M6 nut from the metal bracket securing the centre console side panels.

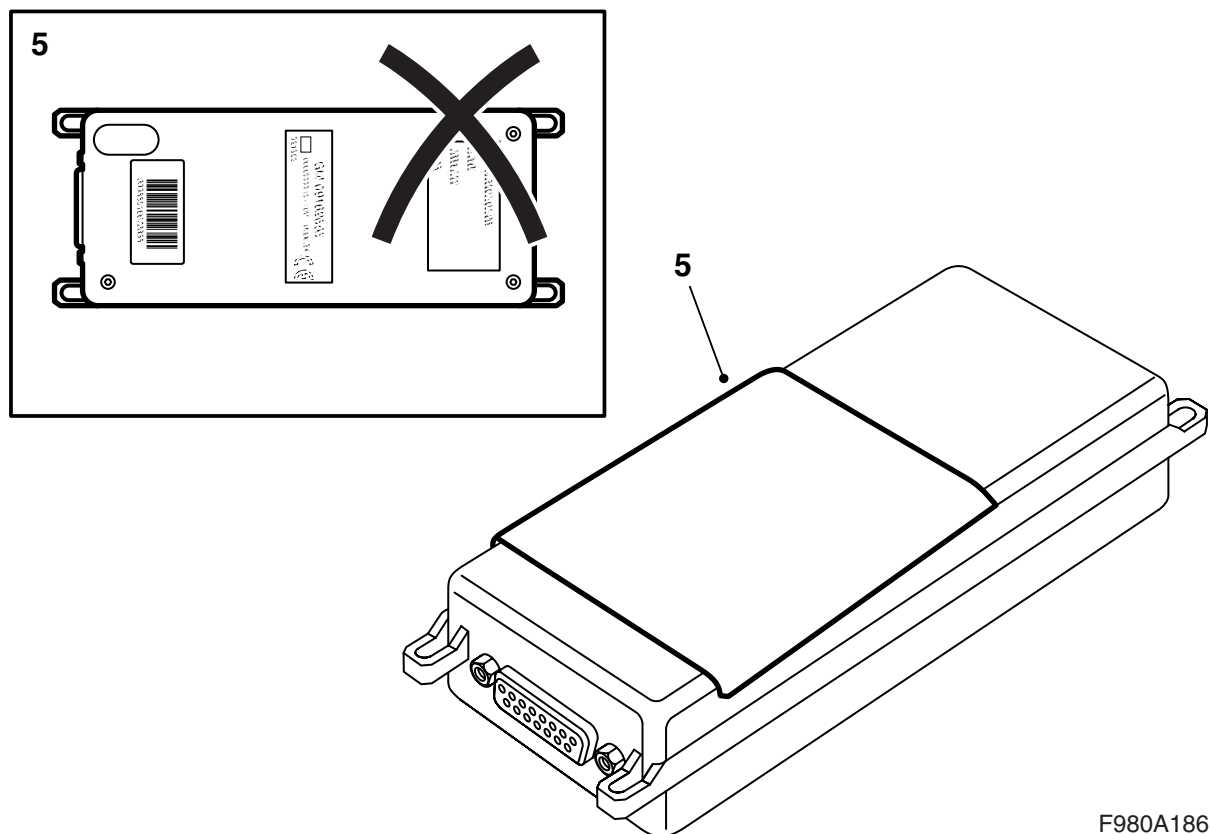

F980A186

5 Cut one protective tape in the centre and fit one of the parts on top of the electronic unit.

---

**Important**

The protective tape must be placed on the top of the electronic unit when the heads of the screws are pointed downwards.

---

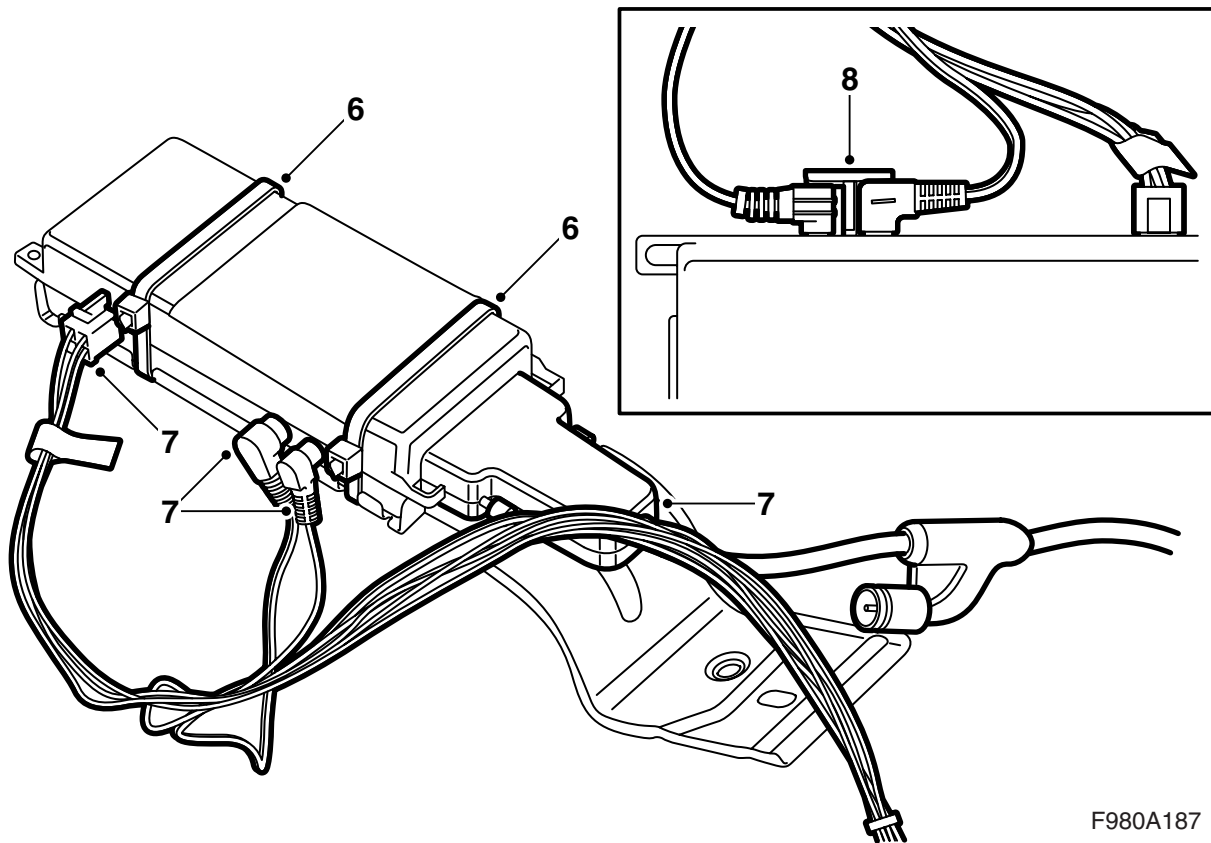

F980A187

- 6 Press the electronic unit into place on the bracket so that the screw heads are facing the bracket. Fit 2 cable ties around the electronic unit and bracket. The large connection must point forwards.
- 7 Connect all contacts to the electronic unit.
- 8 Fit the lock between the angular contacts.

**Note**

The lock is shaped with the size of the angular contacts in mind.

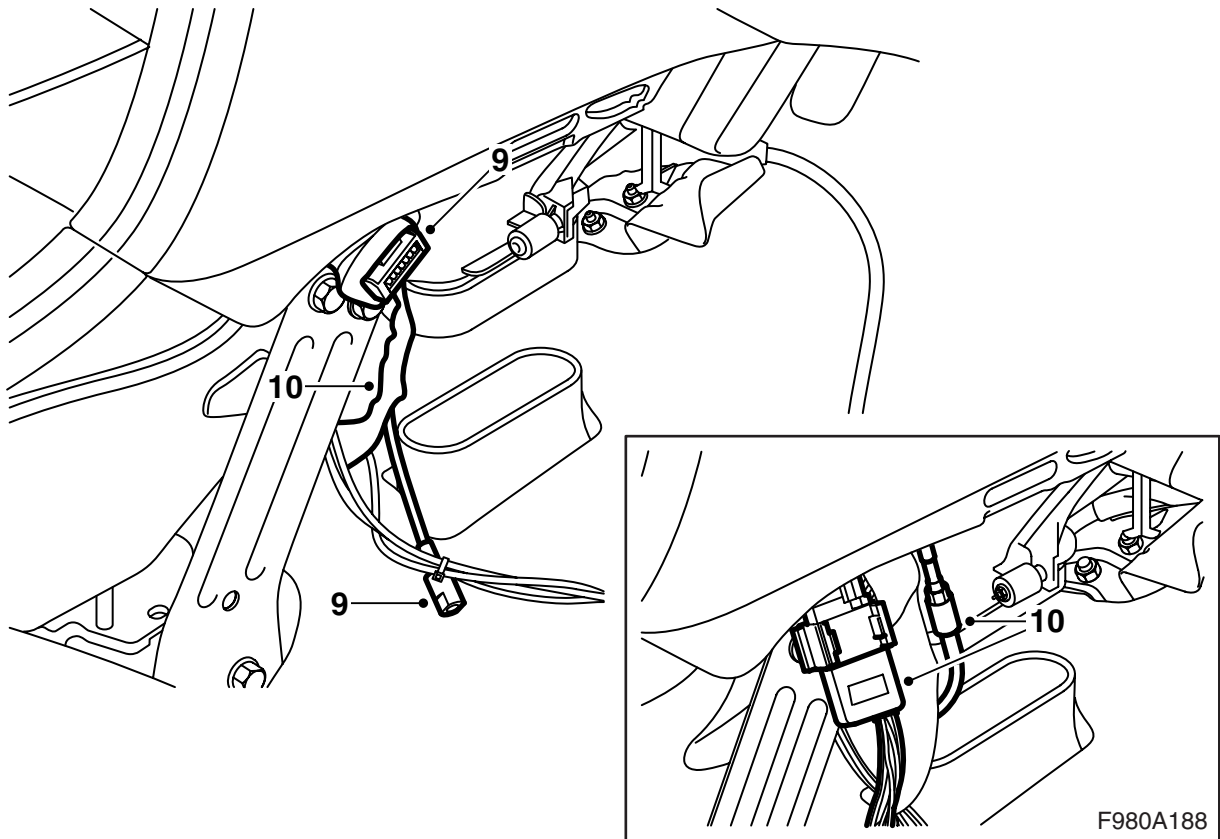

- 9 Locate the installed telephone connection (connector and antenna cable) in front of the instrument panel casing by the right-hand (LHD) or left-hand (RHD) support.
- 10 Remove the anti-rattling tape from the connector and connect the kit's cable to the car's installed telephone connection.

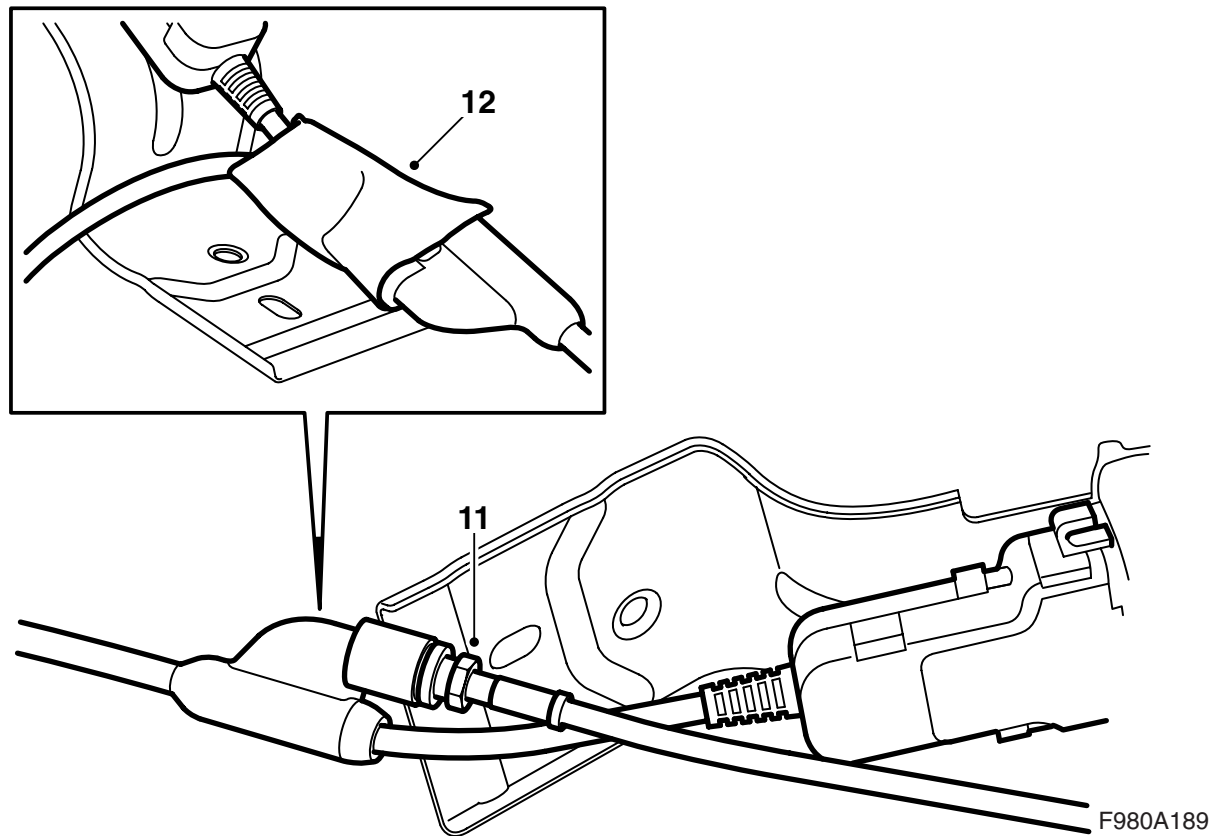

- 11 Run the antenna cable behind the dashboard support and connect it to the telephone holder cable antenna connection. Tighten the nut.

### Important

Certain models require a cable extension between the antenna cable and the telephone holder cable connection. Connect the antenna cable and tighten both nuts.

- 12 Wrap the other half of the split protective tape around the antenna connection on the telephone holder cable.

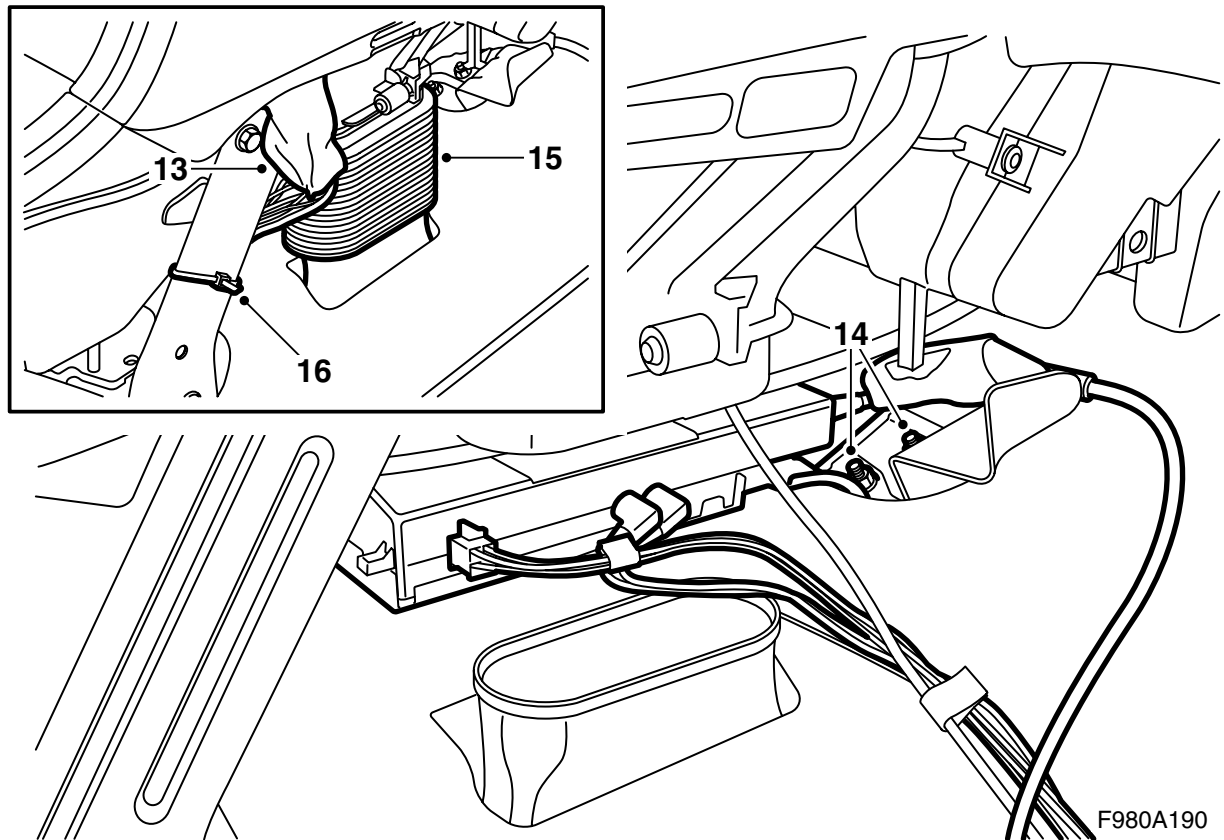

- 13 Tape the other protective tape around the connector which was connected to the telephone installation.
- 14 Fit the electronic unit and its bracket to the bracket for the centre console side panels using two M6 nuts (the previously-fitted nut and the nut from the kit).
- 15 Fit the air bellows.

---

**Important**

The telephone holder cable must be positioned outside the bellows.

- 16 Secure the cable behind the dashboard support using a cable tie.



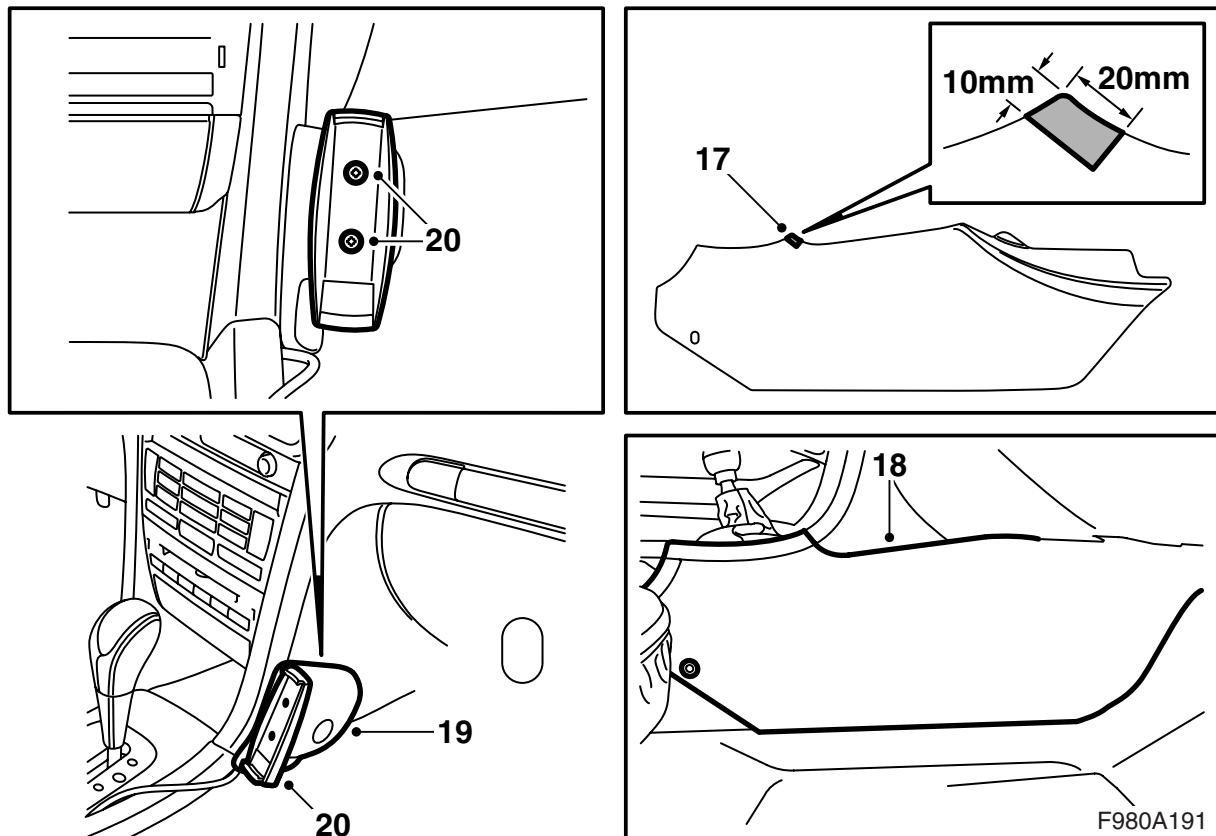

- 17 Make a recess (20 mm x 10 mm) for the telephone cable in the dismantled side panel.
- 18 Fit the side panel at the same time as the telephone holder cable is located into the recess in the side panel.
- 19 Fit the telephone bracket (separate accessory which is fitted as per telephone bracket fitting instructions).
- 20 Fit the telephone holder bracket onto the telephone bracket, drill holes into the telephone bracket (3 mm) using the holder bracket as a template and fit it.

**4D:** Continue with step 21.

**CV:** Continue with step 28.

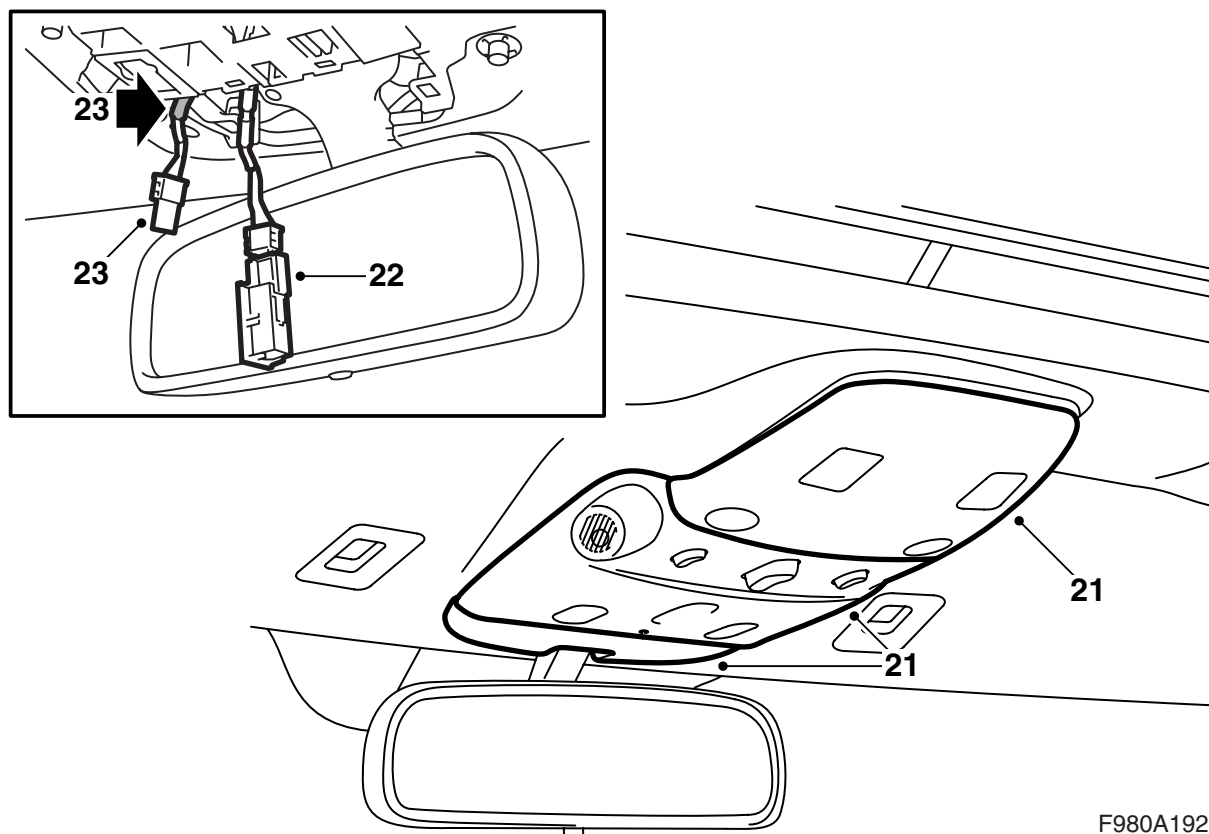

F980A192

- 21 Remove the rear, centre and front sections of the roof lighting cover. Tool 82 93 474 is recommended.

---

### Important

The centre section is fitted with two screws.

---

- 22 Disconnect the connection cable from the microphone in the roof console.
- 23 Locate the new telephone connection, it is marked with yellow tape, and connect it to the microphone.
- 24 Place the previously connected cable onto the location where the cable currently connected was located.

**Cars equipped with navigation system:** The previously connected cable must be connected to a new microphone which is placed to the right (LHD) or the left (RHD) in the roof console.

---

### Important

Do not touch the black felt on the microphone.

---

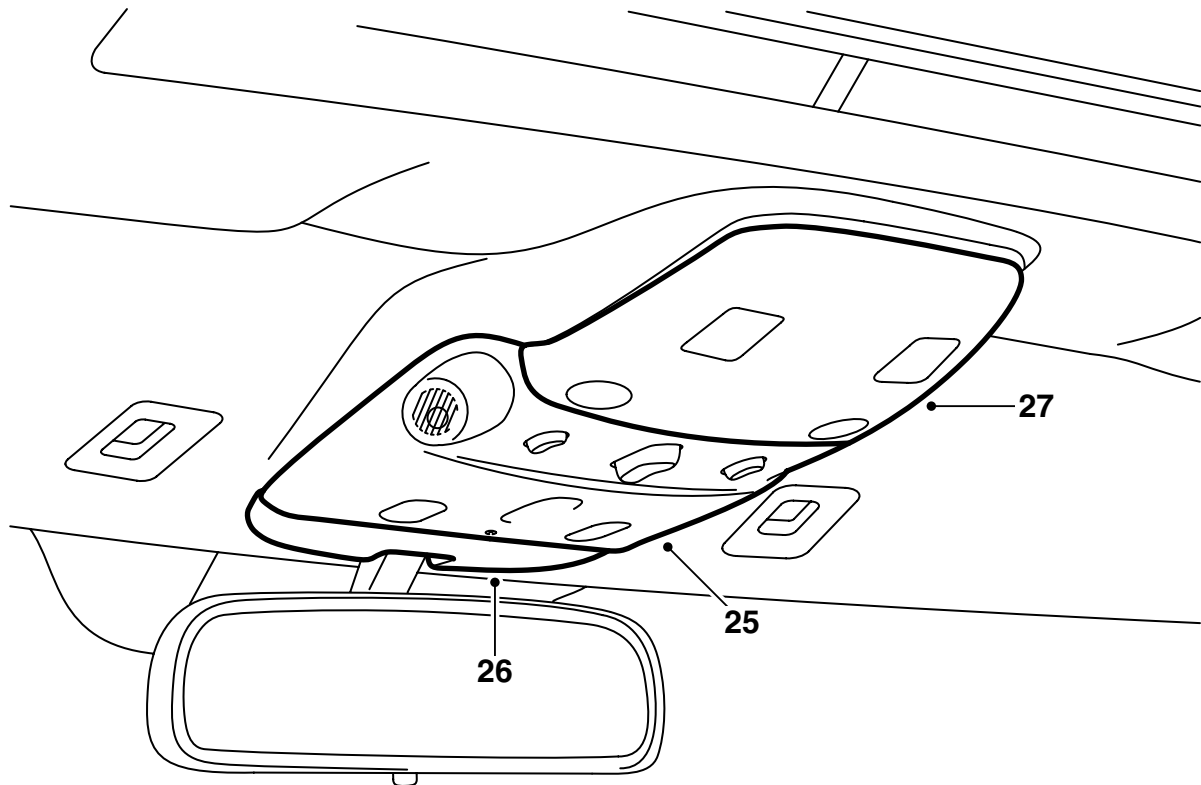

F980A193

- 25 Remove the tape from the opening in the cover where the microphone is located and fit the centre section of the roof lighting cover.
- 26 Fit the front section of the roof lighting cover.
- 27 Fit the rear section of the roof lighting cover.
- 28 Connect the battery negative cable.
- 29 Check that the telephone works.
- 30 Set the time and date.
- 31 Synchronise the remote control code by inserting the key into the ignition.

---

**Important**

Repeat this procedure with all keys. Otherwise, the remote controls will not function.

- 
- 32 Activate window lift pinch protection function by operating the side windows up and down twice. An audible confirmation will sound when activation is complete.