



**MONTERINGSANVISNING · INSTALLATION INSTRUCTIONS  
MONTAGEANLEITUNG · INSTRUCTIONS DE MONTAGE**

## Saab 9-3 M03-

Operating relay, engine heater (cars with MCC)

Accessories Part No.	Group	Date	Instruction Part No.	Replaces
12 798 934	9:87-43	Oct 03	12 800 444	12 800 444 May 03

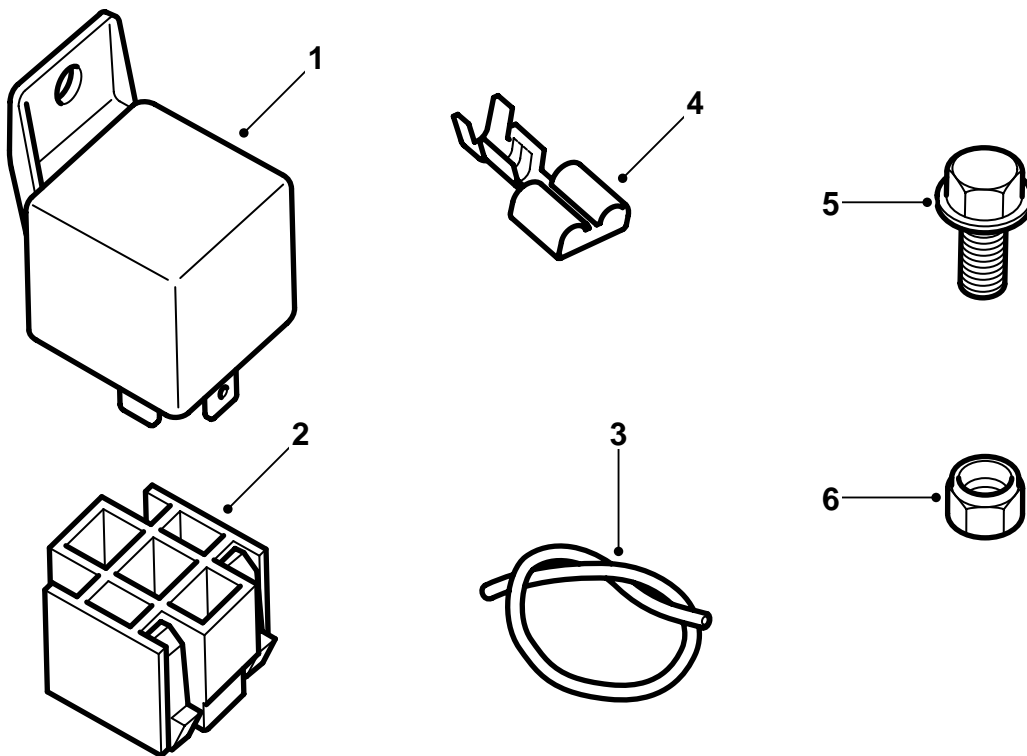

F980A194

- 1 Relay
- 2 Relay socket
- 3 Cable (not used if wiring harness kit 12 805 414 to be fitted)
- 4 Cable terminal (x5) (not used if wiring harness kit 12 805 414 to be fitted)
- 5 Bolt
- 6 Nut

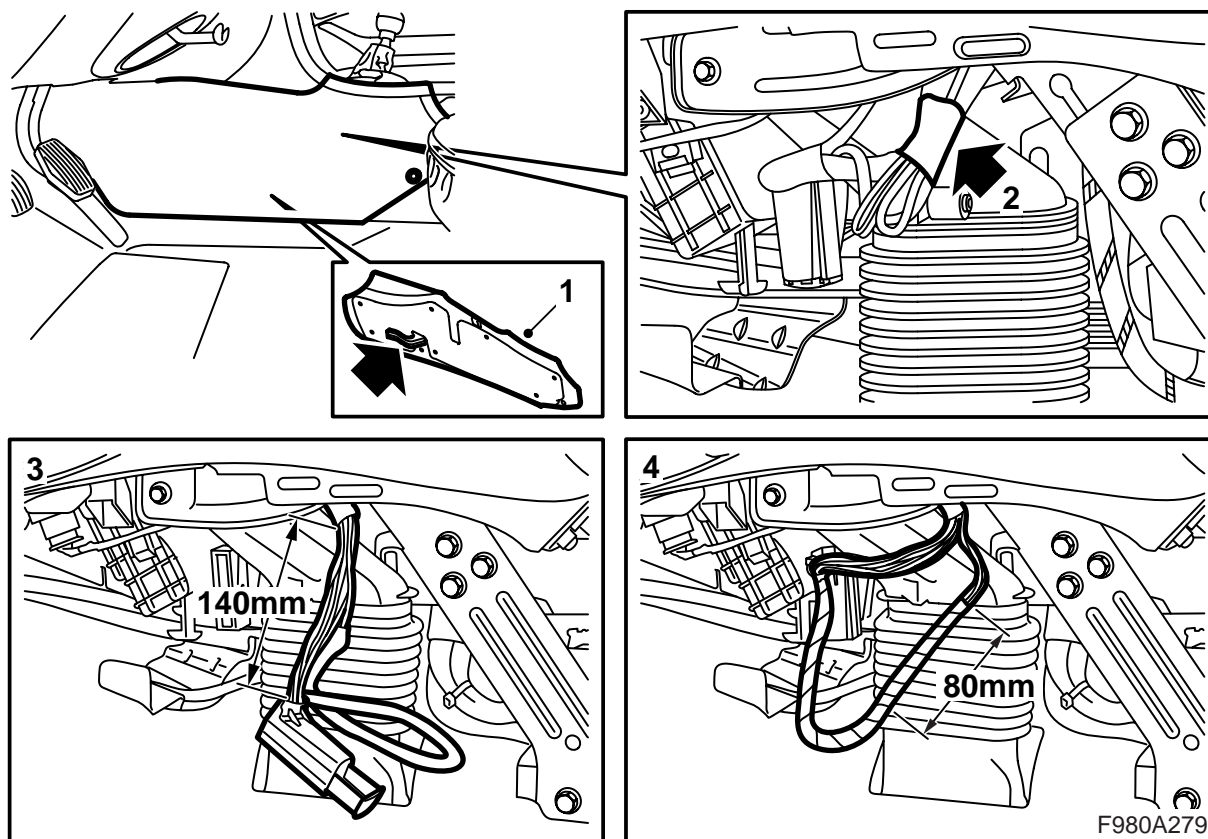

In order to perform this procedure, a cable stripper and cable terminal pliers are required from special tools "Repair kit, wiring harness" (part no. 86 12 079 or 86 12 939).

### Important

If wiring harness kit 12 805 414 is to be fitted, the wiring harness kit installation instructions must be followed instead of these installation instructions.

- 1 Remove the front floor console side pieces on the left-hand side.
- 2 Locate the wiring harness pre-wiring and remove the tape.
- 3 Remove the connector from the heating and ventilation unit and open the tape 140 mm from the edge of the connector.

### WARNING

Exercise caution so that no cable is damaged as this may lead to a short circuit/fire.

Unwind sufficient tape to the connector so that the wiring harness pre-wiring is released.

- 4 Connect the connector to the heating and ventilation unit and unwind tape from an 80 mm length of the wiring harness pre-wiring at the end closest to the MCC panel. Cut off the tape.

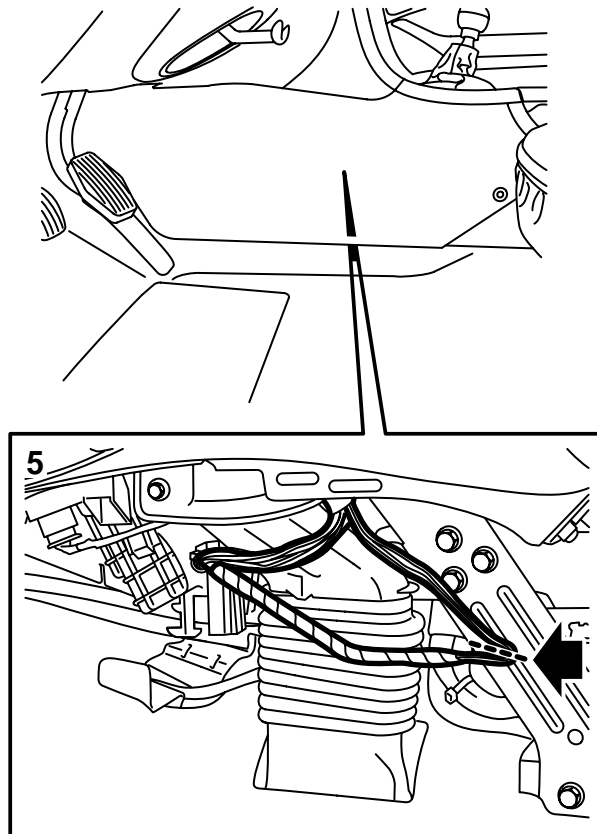

- 5 Stretch the wiring harness pre-wiring to the centre of the support and bend the wiring harness where it is closest to the centre. Cut off all cables in the wiring harness pre-wiring and peel all ends using a cable stripper.

### Important

The red/white (RD/WH) cable which is connected to the connector on the heating and ventilation unit must not be connected but cut off at the edge of the tape.

- 6 Take the kit's orange (OG) cable and peel both of its ends using a cable stripper. Join together one end of the cable with both of the red (RD) cables and fit a cable terminal using a crimp tool.
- Fit cable terminals to all cable ends. Use a crimp tool.

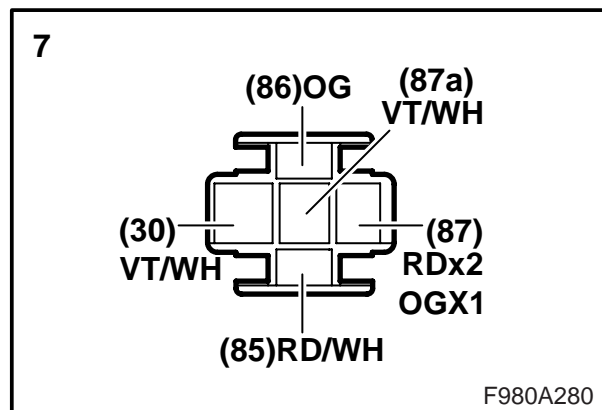
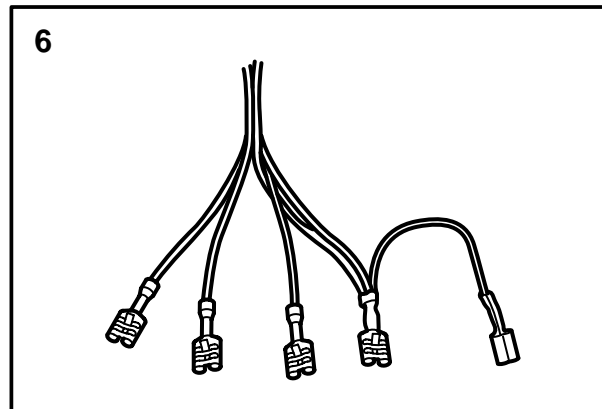

- 7 Fit cable terminals to the relay socket as follows:

Pin	Colour
85	RD/WH
30	VT/WH (the cable connected to the MCC panel)
87a	VT/WH (the cable connected to the heating and ventilation unit)
87	RD (2 cables) and OG (1 cable)
86	OG

Wind tape around the wiring harness.

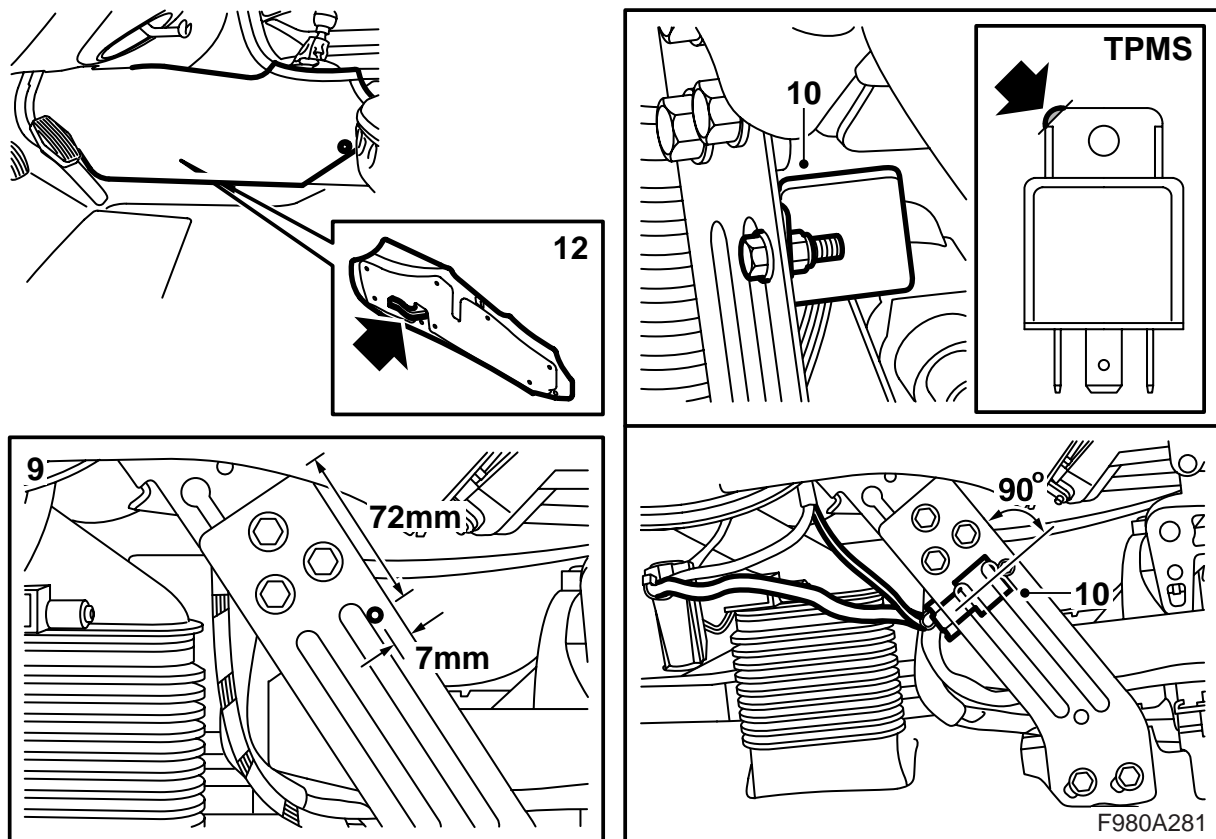

- 8 Fit the relay in the relay socket.
- 9 Drill a 6 mm hole (according to the dimensions) in the dashboard support.

**⚠ WARNING**

Protect the area behind the support so that no cable is damaged as this may lead to a short circuit/fire.

- 10 Fit the relay to the inside of the support. The relay must be mounted at a 90° angle to the edge of the support.

**Cars with tyre pressure monitoring systems (TPMS):** Modify the relay in accordance with the illustration. If necessary, remove the control module with bracket. In such a case, fit the control module with bracket after fitting the relay.

- 11 Check the operation.
- 12 Fit the side piece.

**⚠ WARNING**

Check that no cable can be damaged as this may lead to a short circuit/fire.