



**MONTERINGSANVISNING · INSTALLATION INSTRUCTIONS
MONTAGEANLEITUNG · INSTRUCTIONS DE MONTAGE**

Saab 9-5 4D M06-

Parking assistance (SPA)

Accessories Part No.	Group	Date	Instruction Part No.	Replaces
32 025 686	9:40-06	Sep 05	32 025 688	

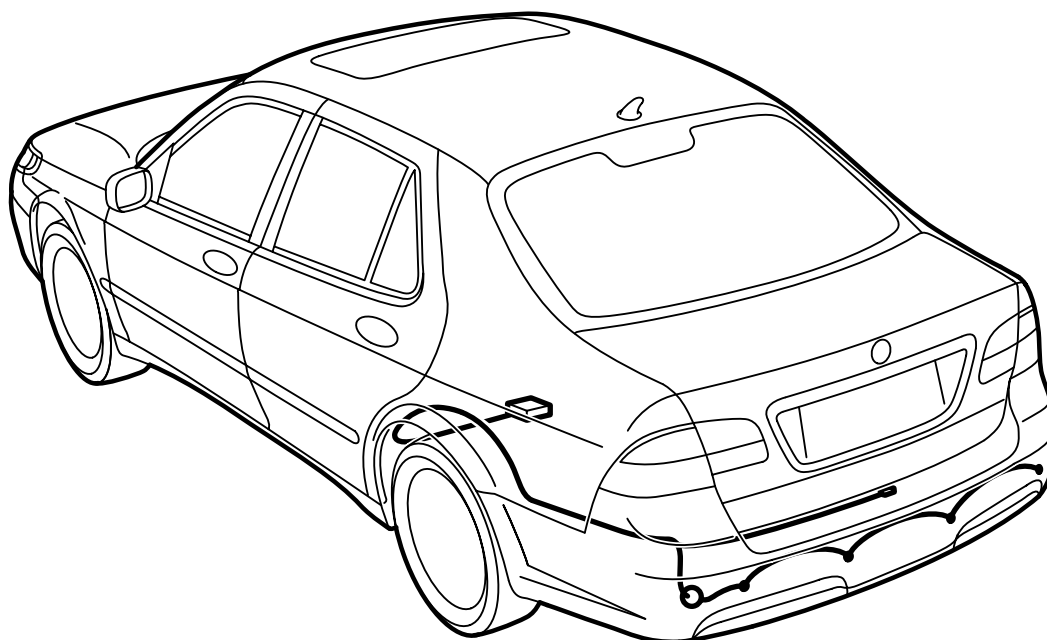

E930A398

Important

To install the kit the car must be equipped with towbar wiring harness provision.

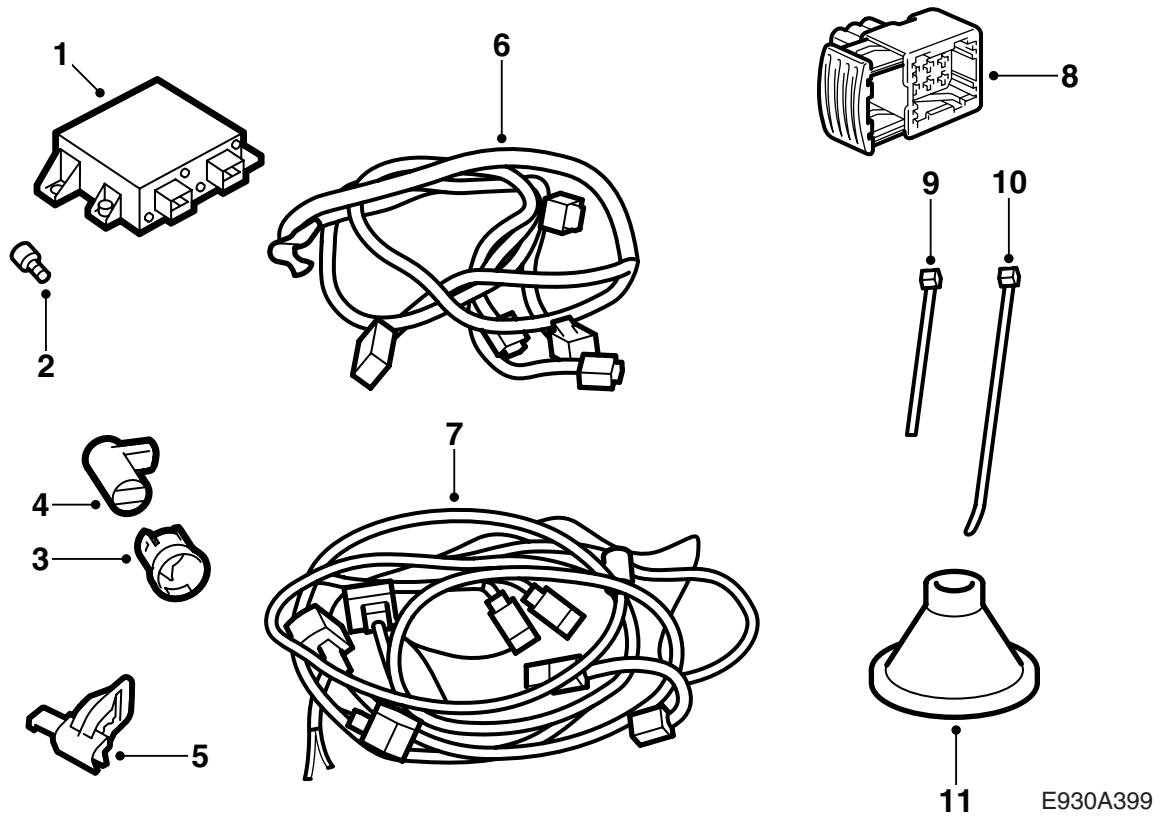

- 1 SPA control module
- 2 Screw (x2)
- 3 Holder (x4)
- 4 Distance sensor (x4)
- 5 Connector bracket
- 6 Wiring harness, distance sensor
- 7 SPA wiring harness
- 8 Connector
- 9 Cable tie (x17)
- 10 Cable tie, rubber grommet
- 11 Rubber grommet

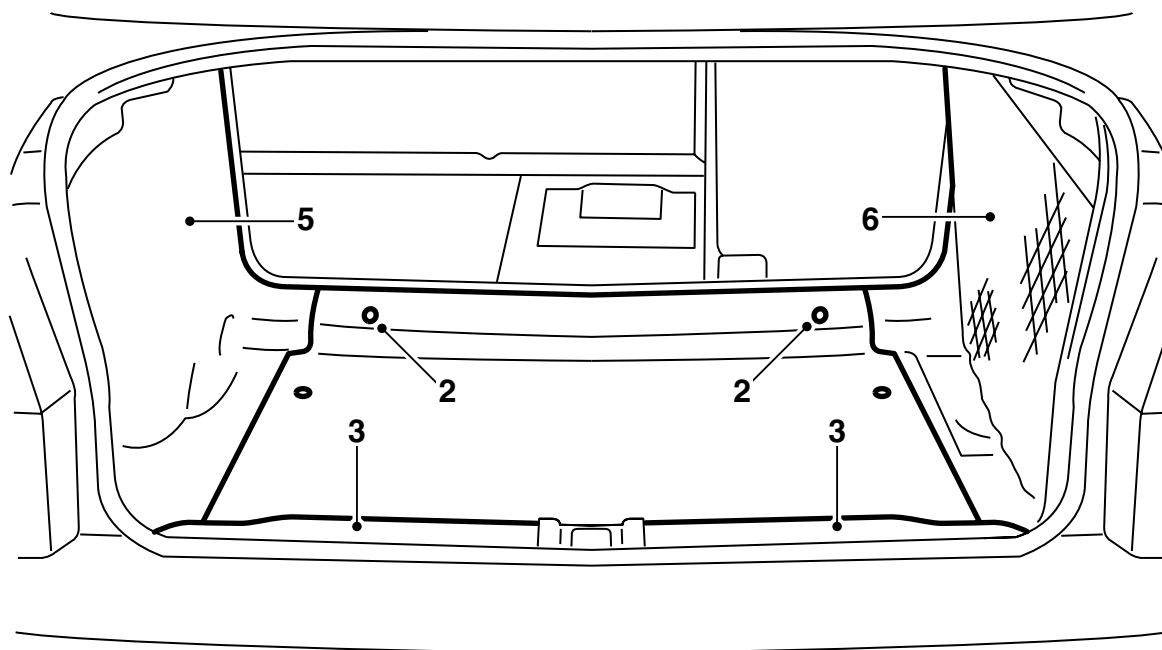

E930A400

Before starting work the visible sections of the distance sensors and holders must be painted in the same colour as the bumper shell.

Important

The layer of paint must not be thicker than 90μ to avoid affecting system functionality.

- 1 Fold forward the rear seat seat cushions and lower the rear seat backrests.
- 2 Open the boot lid and remove the luggage compartment floor.
- 3 Remove the scuff plate.
- 4 **Cars with CD changer:** Remove the CD changer and bracket.
- 5 Detach and fold aside the left-hand trim in the luggage compartment and remove the insulation pads (x2) in the rear of the body. The old ones must be discarded and replaced with new.
- 6 Detach and fold aside the right-hand trim in the luggage compartment and remove the insulation pads (x2) in the rear of the body. The old ones must be discarded and replaced with new.

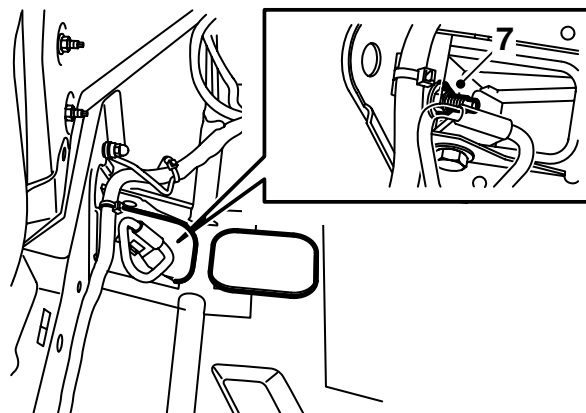
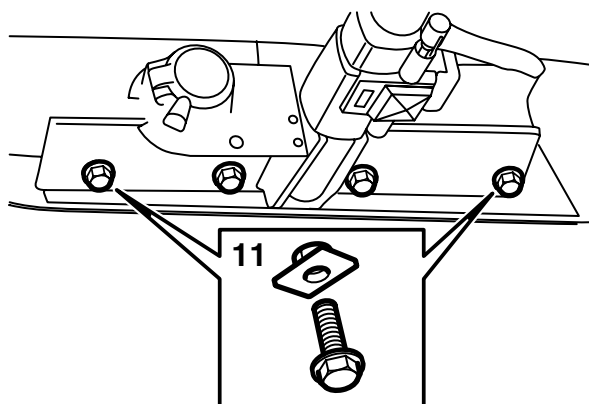

E930A402

- 7 Remove the nuts that hold the bumper. The lower studs only have nuts if the car is equipped with towbar.

Important

Work carefully during removal so that paint damage is avoided.

- 8 **Cars with towbar:** Remove the nuts for both reinforcements.
- 9 Raise the car.
- 10 Remove the bumper bolts at the wheel housings.
- 11 **Cars with towbar:** Detach the connector for the towbar wiring harness and remove the four bolts holding the towbar to the body.

Important

The outer bolts are fitted in loose nut plates.

- 12 Lower the car.
- 13 With help from an assistant, pull the bumper out from the clips. Lift the bumper out backwards.

Important

Place the bumper on a soft, clean surface.

- 14 Remove the bumper rail from the protective shell by detaching the retaining clips.

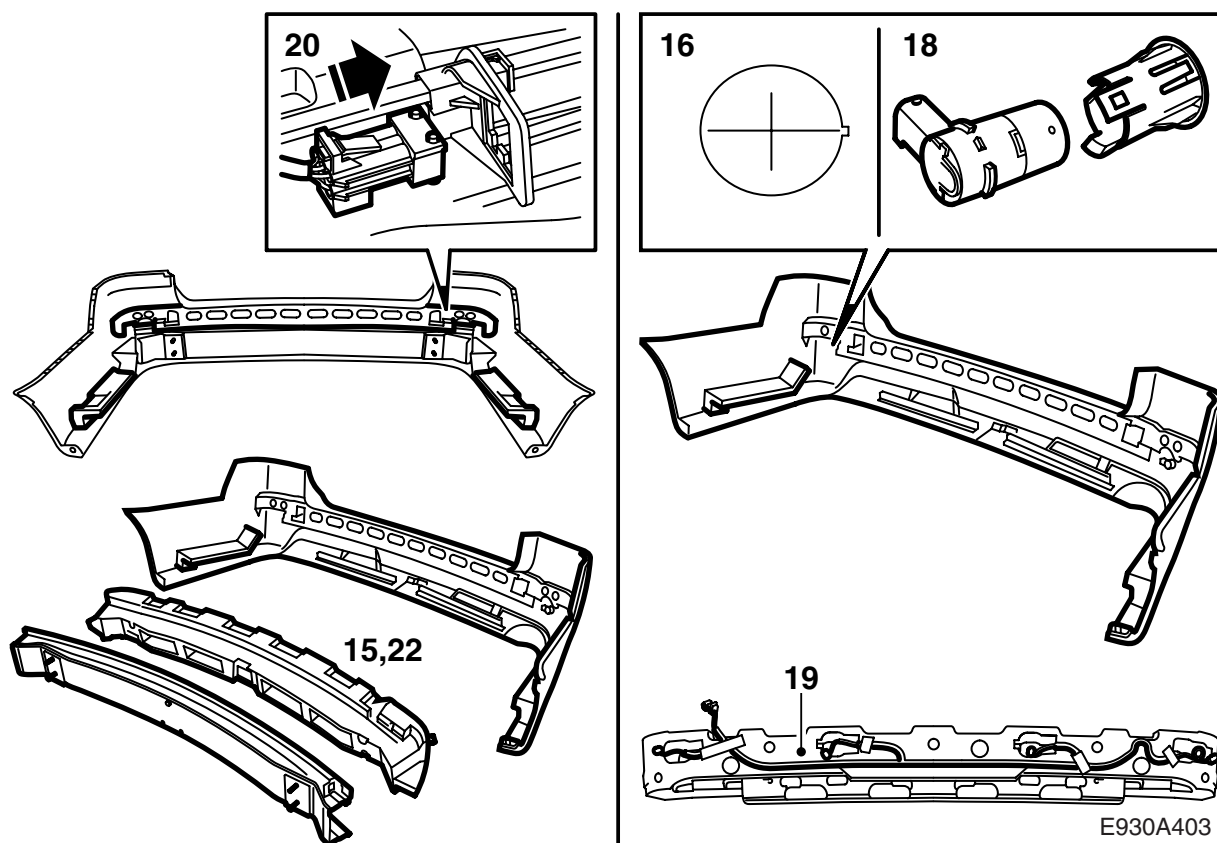

- 15 Remove the cellular block from the bumper shell (wedged into the protective shell's mounting wedges).
- 16 Drill 31 mm holes (x4) in the pre-punched markings in the bumper shell.
- 17 File out the guide groove 1 x 1 mm. The guide groove must be on the side of the hole facing the left-hand side of the bumper shell.

Important

Do not file too far! The cover would then not be over the guide.

- 18 Fit the distance sensors in the holders and then in the bumper shell.
- 19 Pre-route the wiring harness in the centre foam section. The connector comes out on the left-hand side. Connect the wiring harness to the sensors.

WARNING

Check that the wiring harness is not pinched. Incorrect fitting can damage the wiring harness and cause a short-circuit/fire.

- 20 Fit the connector's holder to the left-hand side of the bumper rail.
- 21 Fit the connector in the holder.
- 22 Fit the cellular block with wiring harness in the bumper shell.

- 23 Guide the bumper rail in toward the bumper shell's guide pin. Fit the bumper rail with any reinforcements to the bumper shell.
- 24 Fit the remaining cellular blocks.

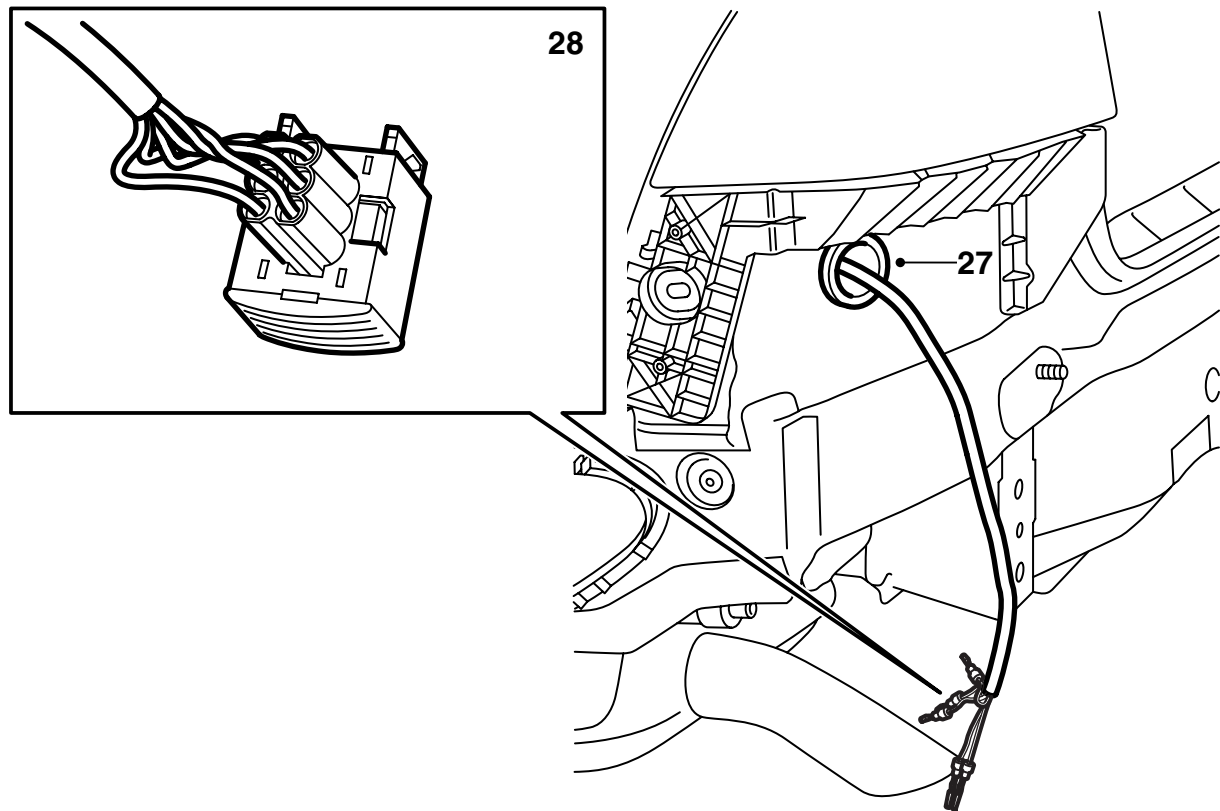

E930A405

- 25 Fit the rubber grommet on the parking assistance system's wiring harness with the funnel-shaped end directed towards the car. The grommet must be located 370 mm from the end of the taping at the cable terminals.
- 26 Remove the rubber plug below the left-hand tail lamp.
- 27 Guide the wiring harness out through the hole and fit the kit's rubber grommet.
- 28 Insert the cable terminals as follows:
 - 1 Black (BK)
 - 2 Brown (BN)
 - 3 Yellow (YE)
 - 4 Blue (BU)
 - 5 Orange (OG)
 - 6 Grey (GY)
- 29 Affix tape and fit a cable tie on the rubber grommet.

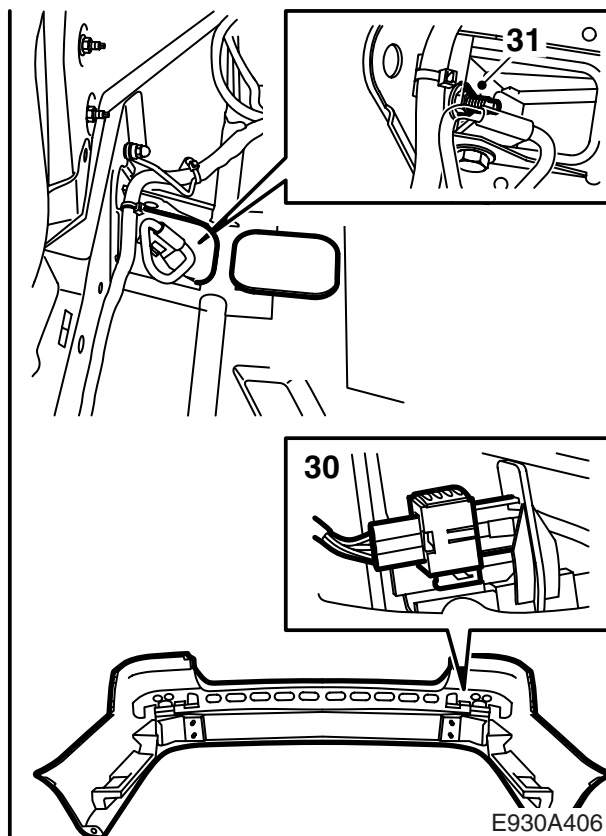
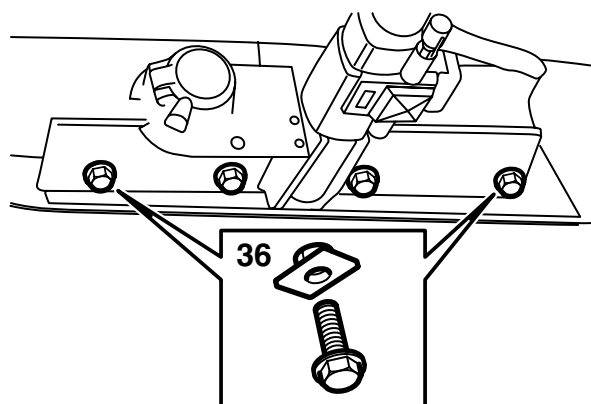

30 Fit in the bumper and plug in the connector.

Important

Work carefully during fitting so that paint damage is avoided.

31 Fit the bumper.

Tightening torque 40 Nm (30 lbf ft)

32 **Cars with towbar:** Screw the reinforcements into the car.

Tightening torque 40 Nm (30 lbf ft)

33 Raise the car.

34 Fit the bumper bolts at the wheel housings.

35 **Cars with towbar:** Fit the connector for the towbar wiring harness.

36 **Cars with towbar:** Fit the bolts and nut plates holding the towbar to the body.

Tightening torque 40 Nm (30 lbf ft)

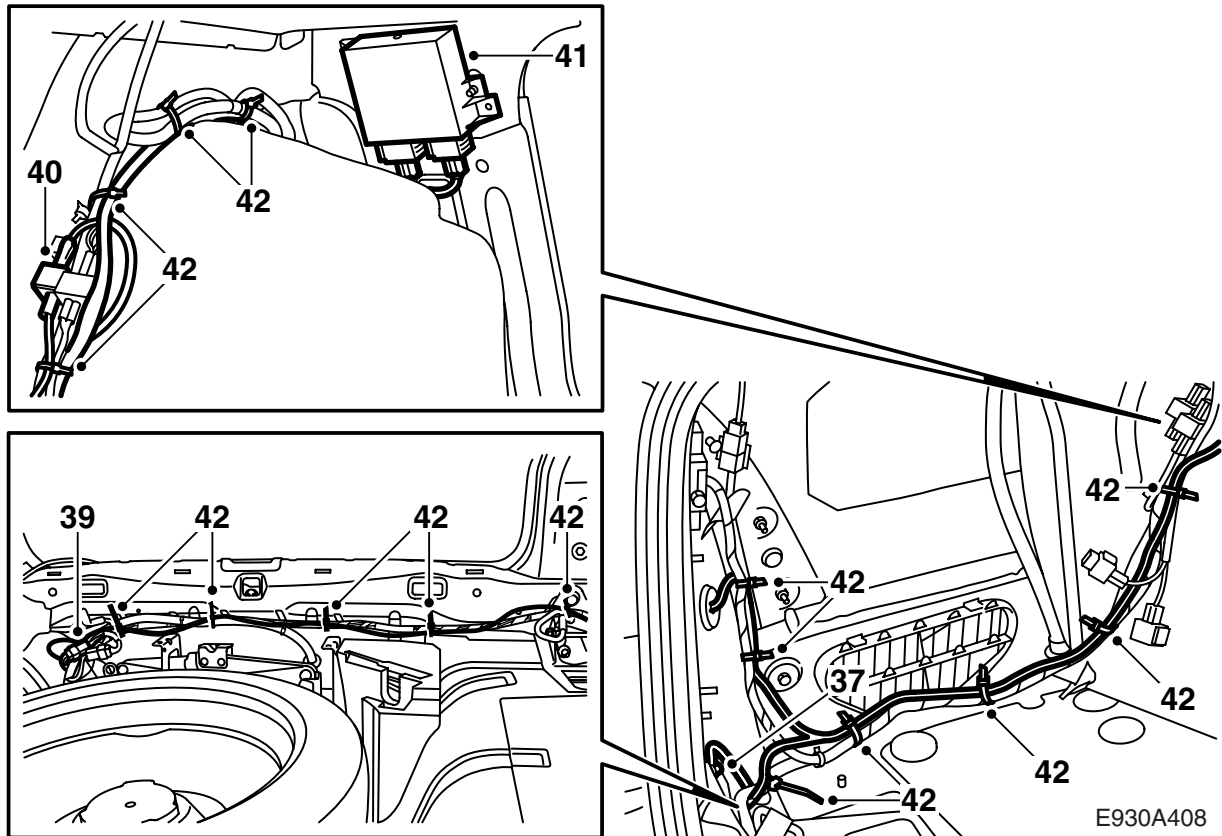

- 37 Attach the ground cable to the grounding point in the luggage compartment below the left-hand tail lamp.
- 38 Run the thicker section of the wiring harness toward the left-hand wheel housing and the thinner section along the luggage compartment sill to the right-hand side of the car.
- 39 Plug the connector into the provision for the towbar wiring harness.
- Cars with towbar:** Unplug the connectors and plug both wiring harness connectors into them.
- 40 Plug the wiring harness connector into the provision for the CD changer and fit the blind plug to the SPA harness connector. Affix anti-rattle tape and secure with a cable tie to avoid rattle.
- Cars with CD changer:** Unplug the connectors and plug each wiring harness connector into them. Affix anti-rattle tape and secure with a cable tie to avoid rattle.
- 41 Insert the screws in the control module holes, connect the wiring harness to the control module, and fit the control module with connectors facing down onto the plate behind the rear seat backrest. Tighten the screws.
- 42 Use cable ties (x17) to secure the wiring harness along its entire route. Gather excess wiring harness and secure it above the wheel housing.

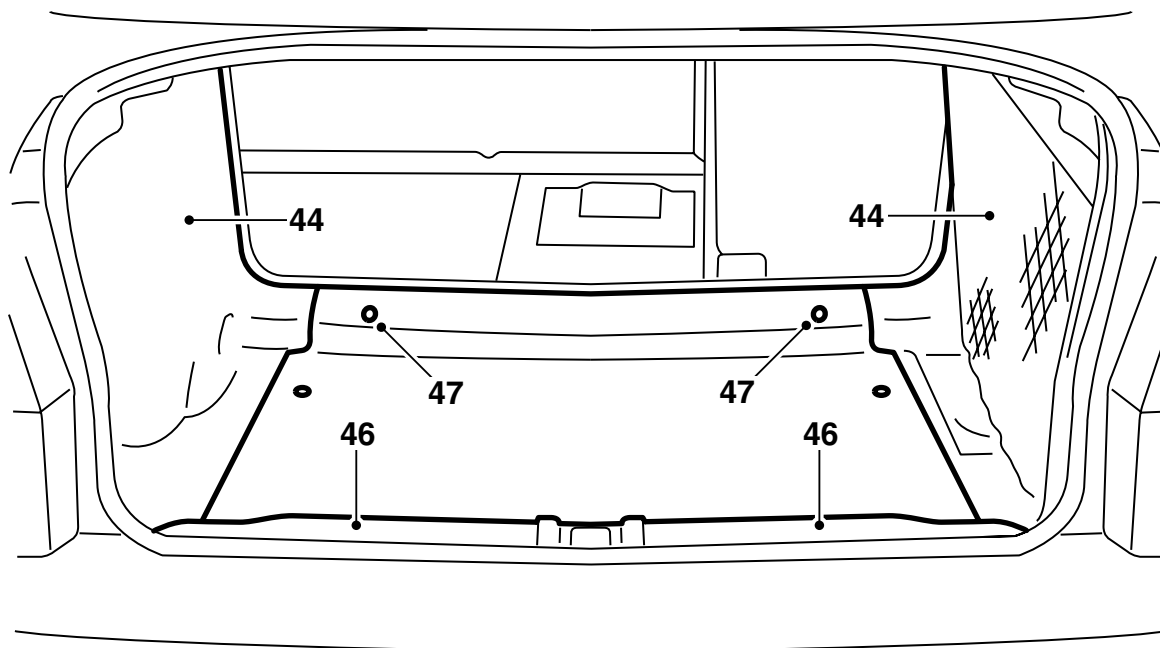

E930A409

- 43 Fit new insulation pads (2 on each side) in the rear edge of the body.
- 44 Fit the side trims.
- 45 **Cars with CD changer:** Fit the CD changer bracket, connect and fit the CD changer.
- 46 Fit the scuff plate.
- 47 Fit the luggage compartment floor.
- 48 Fold back the rear seat backrests and seat cushions and close the boot lid.
- 49 With the ignition key in the ON position and reverse gear engaged, check that the system warns against objects in the rear by using tones. The first tone is given when an object is at a distance of 1.8 metres. The signal then has a frequency of 2 tones per second, but the number of tones per second increases the closer the object becomes to the vehicle and changes as follows:
- 1.8 - 1.3 m: 2 tones/second
 - 1.3 - 0.9 m: 3 tones/second
 - 0.9 - 0.3 m: from 5 to 12 tones/second in close stages
 - 0.3 m: continuous tone