



**MONTERINGSANVISNING · INSTALLATION INSTRUCTIONS
MONTAGEANLEITUNG · INSTRUCTIONS DE MONTAGE**

Saab 9-3, M08-

Timer kit

Accessories Part No.	Date	Instruction Part No.	Replaces
32 026 237	Dec 07	32 026 273	32 026 273 Sep 07

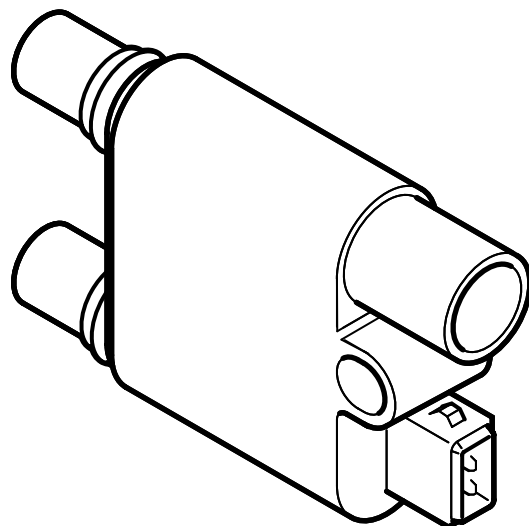

F930A663

Cars with standard front	p. 3
Cars with Aero front	p. 5
Synchronising the remote control code	p. 9
Calibration of pinch protection	p. 9
Setting the clock	p. 10
Adapting the alarm	p. 11
User instructions	p. 13

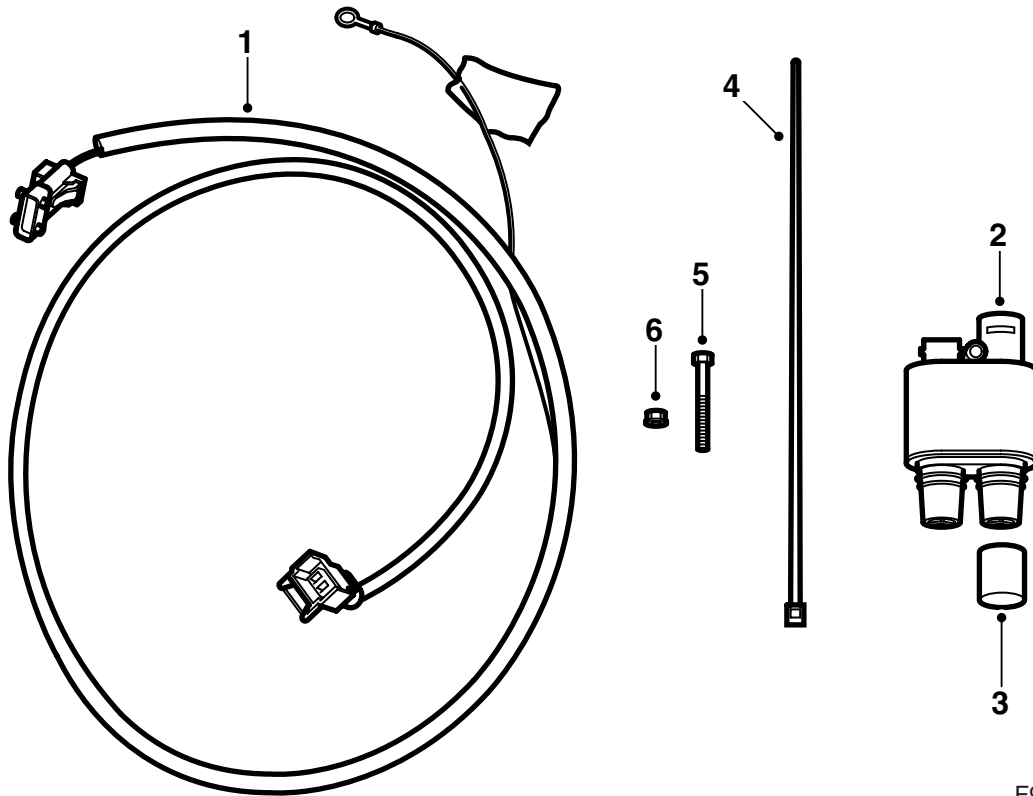

F930A005

- 1 Wiring harness
- 2 Timer relay
- 3 Protective cap
- 4 Cable tie (x7)
- 5 Bolt (not used on cars with std. front)
- 6 Nut (not used on cars with std. front)

Cars with standard front

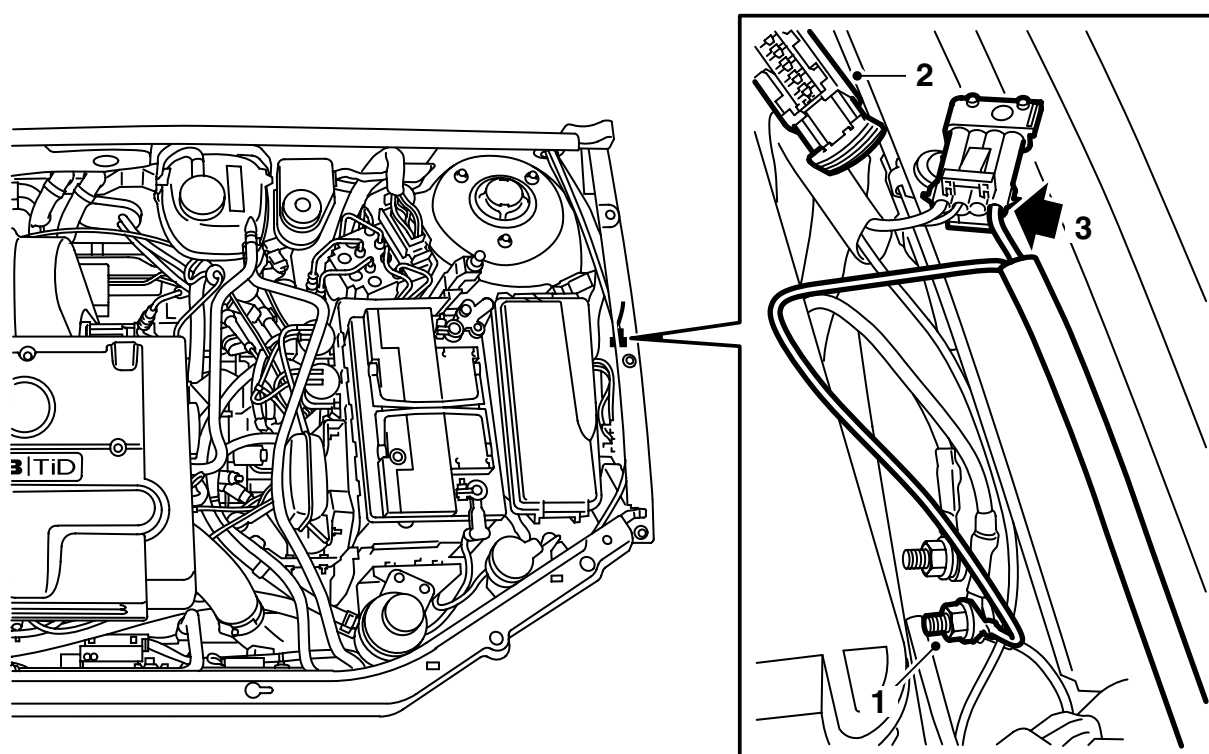

F930A664

- 1 Disconnect the battery's negative cable. Route the wiring harness behind the electrical centre, along the bonnet wire, and connect the ground cable to the front grounding point (G30A) at the engine bay electrical centre.
- 2 Locate the "Pre Acc" outlet between the engine bay electrical centre and the front wing and remove any adhesive tape and dummy connector.
- 3 Connect the wiring harness to the four pole "Pre Acc" outlet.

Important

If the four-pin "Pre Acc" outlet is already in use, connect into the existing connector as follows

- disassemble "Pre Acc"
- remove the seal from the connector for the timer relay's wiring harness and prise out the cable
- insert the cable in the connector previously plugged into "Pre Acc", position 4
- plug the connector into "Pre Acc"

- 4 Secure the wiring harness to the bonnet wire, behind the left-hand headlamp, using 1 cable tie.
- 5 Lower the wiring harness in front of the battery tray behind connector H24-1.
- 6 Raise the car.

- 7 Remove the 3 screws to the left-hand section of the spoiler shield and fold it down.
- 8 Detach all contacts on extension cables/branch contacts and route the block heater's extension cable out from the hole in order to facilitate fitting the wiring harness. Route the wiring harness through the hole where the block heater's extension cable was routed. Route the block heater's extension cable through the hole once again.
Connect all extension cables to the timer relay. Fit the retaining clips, a click can be heard when the retaining clips have been correctly fitted.

WARNING

Check that the wiring harness is not pinched. Incorrect fitting can damage the wiring harness and cause a short-circuit/fire.

- 9 Connect the wiring harness to the timer relay.
- 10 Lower the car.
- 11 Connect the battery's negative cable.

- 12 Connect the diagnostic tool, select car and model year, select "All", select "Add/Remove", select the accessory and then "Add".

Important

The diagnostic tool will on some occasions need to retrieve a security code in TIS. Information on what to do will be displayed on the diagnostic tool display.

-
- 13 Connect the engine block heater to a wall socket.
 - 14 On SIDC, press the button labelled "CUSTOMIZE", select "Engine heater", press "SET", select "Manual control", press "SET", select "Heater On", press "SET" and check that the engine heater starts.
 - 15 Select "Manual control", press "SET", select "Heater Off", press "SET", select "Back" and "Quit".

Cars with Aero front

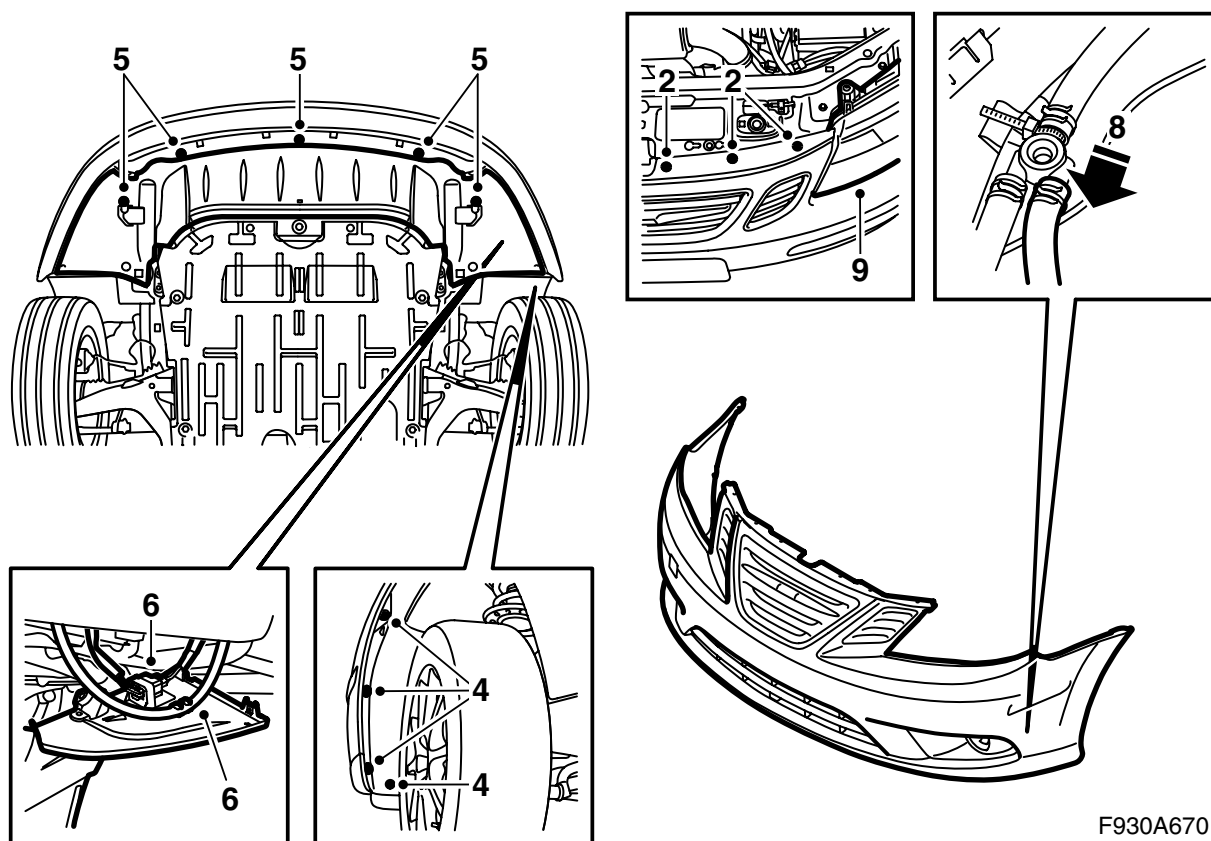

F930A670

- 1 Disconnect the battery's negative cable.
- 2 Remove the bumper shell clip from the upper radiator member.
- 3 Raise the car.
- 4 Remove the bumper's bolts in the wheel housing.
- 5 Remove the spoiler shield.
- 6 Unplug the bumper connector and remove it from the holder on the spoiler shield.

Cars with headlamp washers: Unhook the hose from the spoiler shield.

- 7 Lower the car.
- 8 Pull out the bumper shell side pieces and remove the bumper.

Cars with headlamp washers: Remove the hose from the branching piece and plug the hose with an 8.5 mm drill.

- 9 Remove the left-hand headlamp.

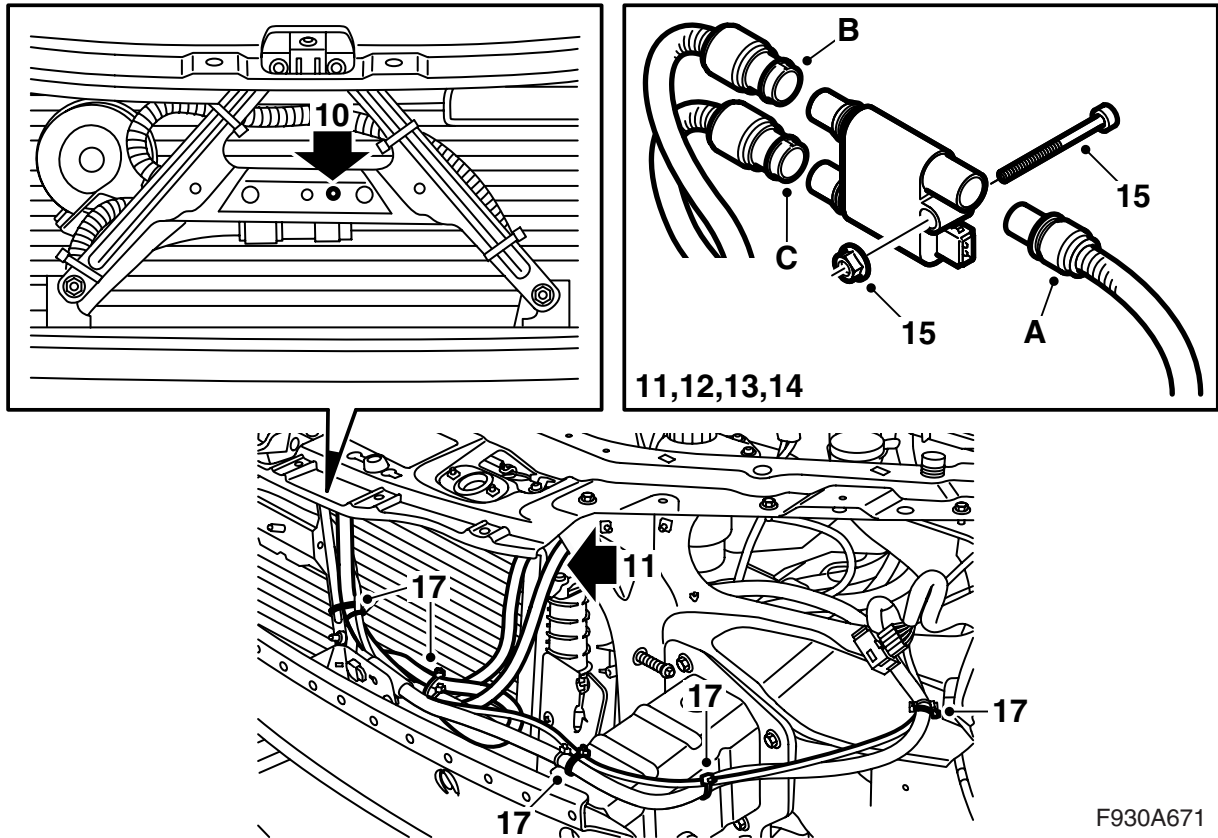

- 10 **Cars without block heater:** Drill a 6 mm hole for the timer relay in the horn bracket.

⚠ WARNING

Pay attention so that the car's wiring harness is not damaged. Damage to the wiring harness may cause short circuits/fire.

- 11 Detach all contacts on extension cables/branch contacts and route the cable back to the upper radiator member without removing the cable tie in the upper radiator mounting. Route the connecting cable under the radiator member, between the left-hand headlamp and the radiator.
- 12 Plug the connecting cable into the timer relay (A).
- 13 Plug the engine block heater's cable into the timer relay's socket (B).
- 14 **Cars with cabin heater:** Plug the cabin socket's cable into the timer relay's socket (C).
- 15 Fit the timer relay to the horn bracket with the relay spacer lugs against the bracket and fit the screw with its head facing the radiator. The extension cable connected to the timer relay socket (B) must be located above the timer relay.

- 16 Fit the lock clips over the connections. A click should be heard when the lock clip is fitted correctly.

- 17 Connect the wiring harness to the timer relay, route the wiring harness along the connecting cable and then let it follow the horn wiring harness down to the bumper member and then the impact sensor wiring harness. Secure the timer relay wiring harness at the same attachment points as the impact sensor wiring harness.

Important

The timer relay wiring harness must be located next to the impact sensor wiring harness in the opening for the headlamp.

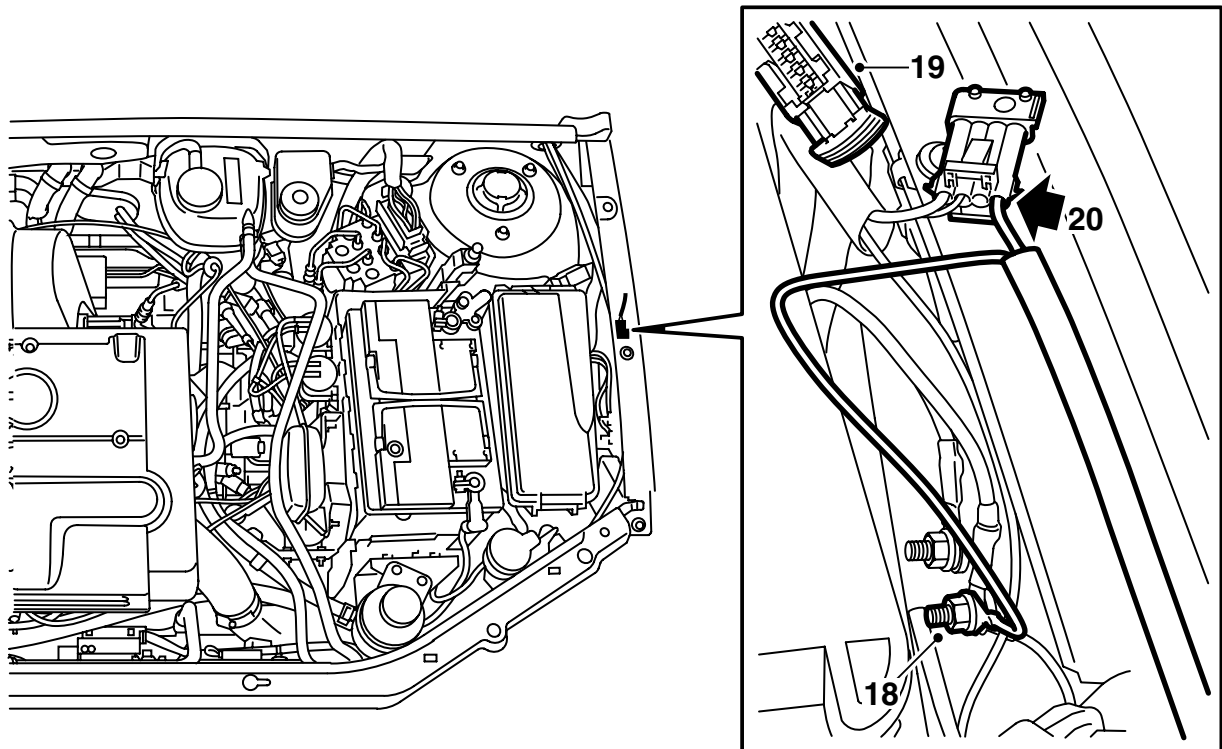

F930A672

- 18 Connect the ground cable to the front grounding point (G30A) at the engine bay electrical centre.
- 19 Locate the "Pre Acc" outlet between the engine bay electrical centre and the front wing and remove any adhesive tape and dummy connector.
- 20 Connect the wiring harness to the four pole "Pre Acc" outlet.

Note

If the four-pole "Pre Acc" socket is already used, connect into the existing connector as follows:

- unplug "Pre Acc"
- remove the seal from the connector on the timer relay wiring harness and extract the cable
- insert the cable into the connector that was plugged into "Pre Acc", position 4
- plug the connector into "Pre Acc"

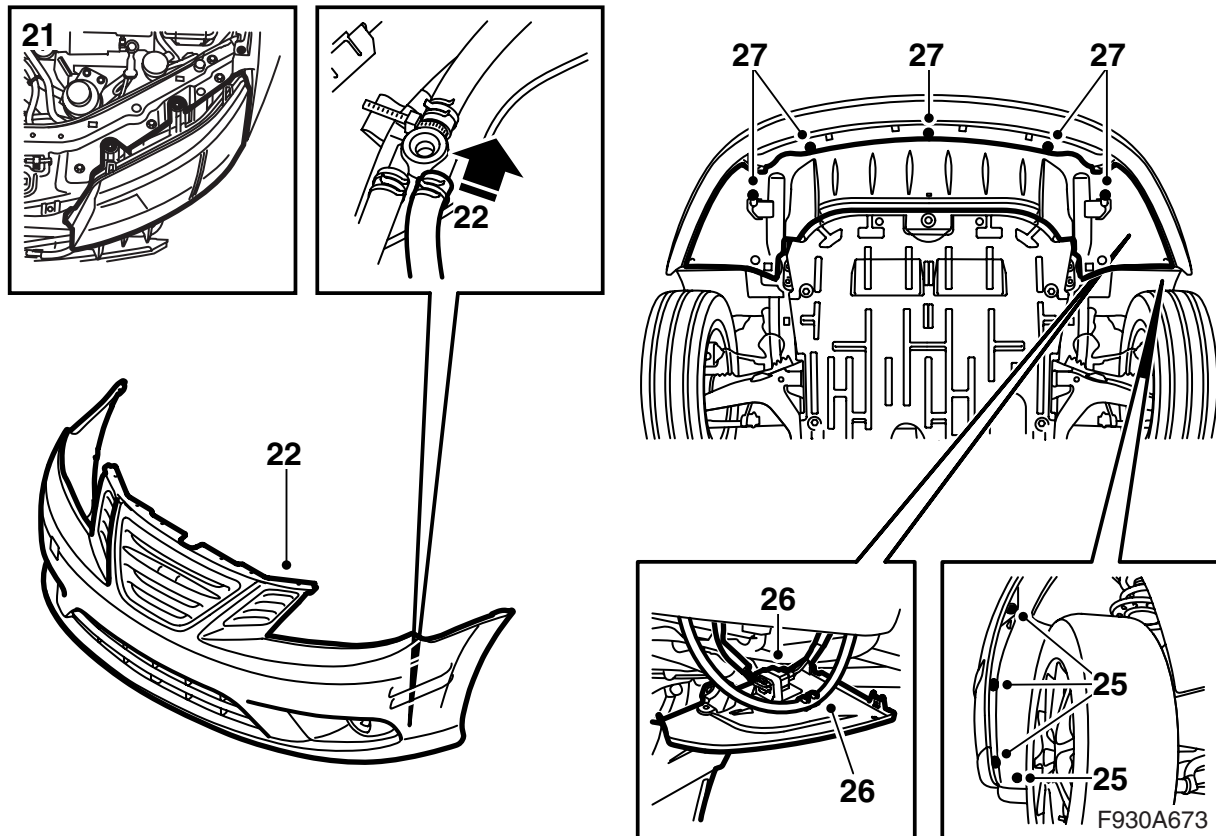

21 Connect and fit the left-hand headlamp.

⚠ WARNING

Check that the wiring harness is not pinched. Incorrect fitting can damage the wiring harness and cause a short-circuit/fire.

22 Lift up the bumper.

⚠ WARNING

Check that the wiring harness is not pinched. Incorrect fitting can damage the wiring harness and cause a short-circuit/fire.

Cars with headlamp washers: Connect the headlamp washer hose to the branching piece.

23 Align the bumper and press the shell back so that it is secured against the holder's mounting.

24 Fit the clips on the upper radiator member.

25 Raise the car and fit the bumper's bolts into the wheel housing.

26 Lift up the spoiler shield, fit the bumper connector into the holder and plug in the connector.

Cars with headlamp washers: Hook the hose onto the spoiler shield.

27 Fit the spoiler shield.

28 Lower the car and check the fit of the bumper.

29 Connect the battery's negative cable.

30 **Cars with headlamp washers:** Check the operation of the headlamp washers.

31 Connect the diagnostic tool, select car and model year, select "All", select "Add/Remove", select the accessory and then "Add".

Note

The diagnostic tool will on some occasions need to retrieve a security code in TIS. Information on what to do will be displayed on the diagnostic tool display.

32 Connect the engine block heater to a wall socket.

33 On SIDC, press the button labelled "CUSTOMIZE", select "Engine heater", press "SET", select "Manual control", press "SET", select "Heater On", press "SET" and check that the engine heater starts.

34 Select "Manual control", press "SET", select "Heater Off", press "SET", select "Back" and "Quit".

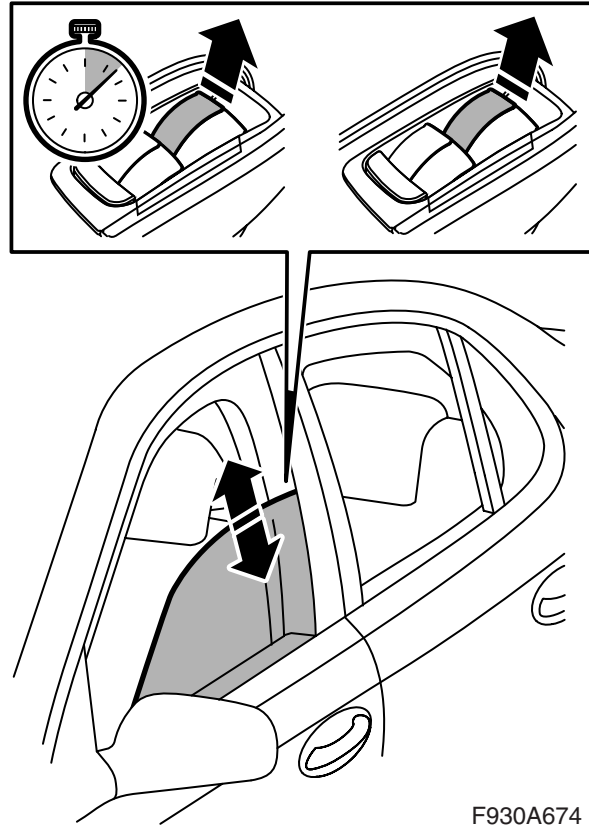
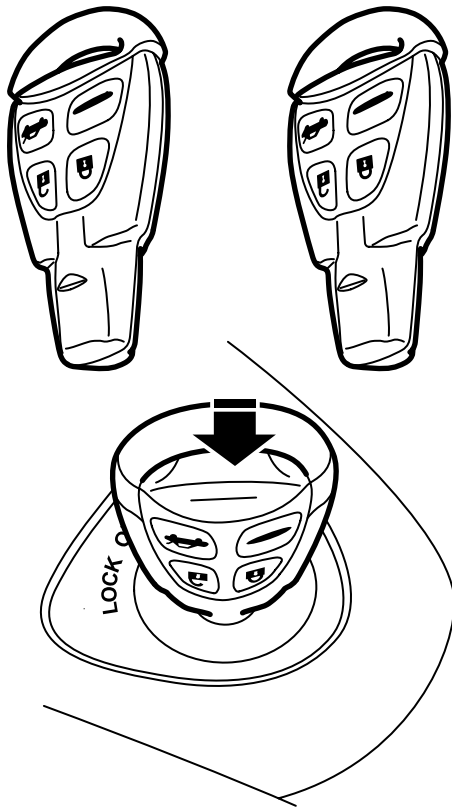

F930A674

Synchronising the remote control code

Synchronise the remote control code by inserting the key into the ignition switch.

Important

Repeat this procedure with all keys. Otherwise, the remote controls will not function.

Calibration of pinch protection

⚠ WARNING

Anti-Pinch is not active until the power windows have been calibrated following power disconnection.

Note

Only one control module is to be calibrated at a time due to voltage variations.

- 1 Close the window.
CV: Close the door and the soft top.
- 2 Reset the pinch protection by removing and fitting fuse F5 from the instrument panel electrical centre (IPEC). The pinch protection for both door modules is now reset and both front windows can be programmed.
- 3 Start the car.
- 4 Lower the window fully. Hold the button depressed during the entire operation.

- 5 Raise the window fully. Hold the button up during the entire operation. Wait for at least 1 second when the window is in the top position.
- 6 Lower the window fully. Hold the button depressed during the entire operation.
- 7 Raise the window fully. Hold the button up during the entire operation. Wait for at least 1 second when the window is in the top position.
- 8 When calibration has been completed an audible confirmation is heard. In the event that no audible confirmation is heard, repeat the procedure.

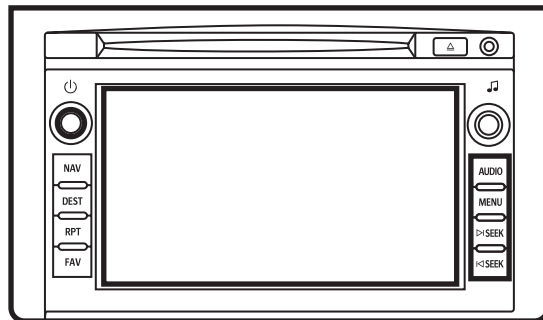
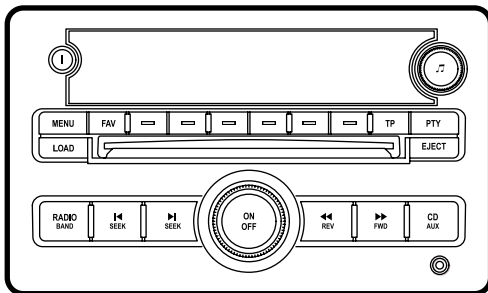

F930A675

Setting the clock

Cars with audio system without navigation

Manual setting of audio system without CD changer:

- Press the clock button.
- Press the menu button directly underneath the menu option you wish to change.
- Press the menu button again to increase time or date one increment at a time. You can also adjust time and date by pressing the SEEK, FWD or REV buttons.

Manual setting of audio system with CD changer:

- Press the MENU button.
- Press the menu button directly underneath the clock symbol in the display.
- Press the menu button directly underneath the menu option you wish to change.
- Press the menu button again to increase time or date one increment at a time. You can also adjust time and date by pressing the SEEK, FWD or REV buttons.

Automatic setting - RDS time:

To obtain RDS time (Clock Time, CT), the reception must be good and the currently tuned station must be transmitting RDS time signals.

- In the clock menu, press the menu button directly underneath the arrow symbol in the display.
- Press the menu button directly underneath RDS time menu option.
- Adjusting the clock now takes place automatically and the display shows: "Adjusting to RDS time...". In the event of poor RDS reception or if there is no time information the display shows: No RDS time available.

Setting the clock

Cars with audio system and navigation

Note

This unit has a touch-panel and only displays time. The navigation system receives the correct date via a GPS signal. The date is used by other car functions, e.g. service, and is not shown in the display.

- 1 Ignition in ON position.
- 2 Activate the audio system.
- 3 Press MENU until the tab for the clock is activated.
- 4 Select RDS time or manual setting on the touch screen. To obtain RDS time (Clock Time, CT), the reception must be good and the currently tuned station must be transmitting RDS time signals.

Adapting the alarm

If the car is equipped with theft protection with movement detector then there is a risk that the car will trigger false alarms when the heater is activated.

To avoid this there is the option to set the movement detector using the diagnostic tool so that it is deactivated when the heater is active in order to then be reactivated when the heater is inactive.

Note

The customer must be informed of the option to adapt the alarm and then decide how the alarm should be configured.

Implementation

Connect the diagnostic tool and navigate as follows:

Fault diagnosis - Vehicle type - Model year - Body - Theft Protection - Anti Theft - Adjustments - Anti Theft, - Disable Detection.

Select configuration of alarm.

User instructions

- The extension cable must be made of oil-resistant rubber and approved for outdoor use with a cross-sectional area of at least 3x1.5 mm².
- The heater system must only be connected to a grounded socket.

 **WARNING**

Handle all cables with care.

- Pay particular attention to the risk of pinching between the bonnet and the body of the car and the risk of cuts on sharp metal components.
- Check the ground connection between the connecting plug ground pin, the heater casing and the car body regularly to prevent electric shocks.
- Regularly inspect the extension cable for damage or ageing. Damaged cables must be replaced immediately, otherwise there is a risk of personal injury.

Note

The function of the heater will be at risk if:

- there are impurities in the coolant
- the coolant level is too low or if there is air in the system
- there is ice slush in the system
- radiator sealant is used

Adapting the alarm

If the car is equipped with theft protection with movement detector then there is a risk that the car will trigger false alarms when the heater is activated.

To avoid this there is the option to set the movement detector so that it is deactivated when the heater is active in order to then be reactivated when the heater is inactive.

Contact a Saab workshop for adapting the alarm.