



**MONTERINGSANVISNING · INSTALLATION INSTRUCTIONS
MONTAGEANLEITUNG · INSTRUCTIONS DE MONTAGE**

Saab 900 M94-, Saab 9-3, Saab 9-5 4D

12 V socket in luggage compartment

Accessories Part No.	Group	Date	Instruction Part No.	Replaces
400 112 314 86 90 372	9:37-02	Sept 06	86 92 238	86 92 238 Jan 99

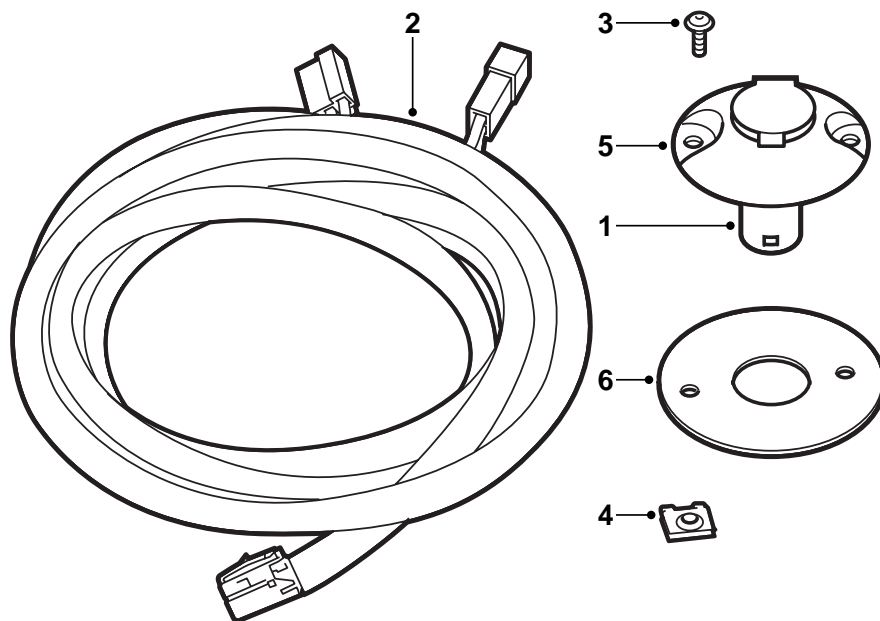

E930A090

- 1 12 V socket
- 2 Wiring harness
- 3 Screws (2)
- 4 Clips (2)
- 5 Cover
- 6 Attaching frame

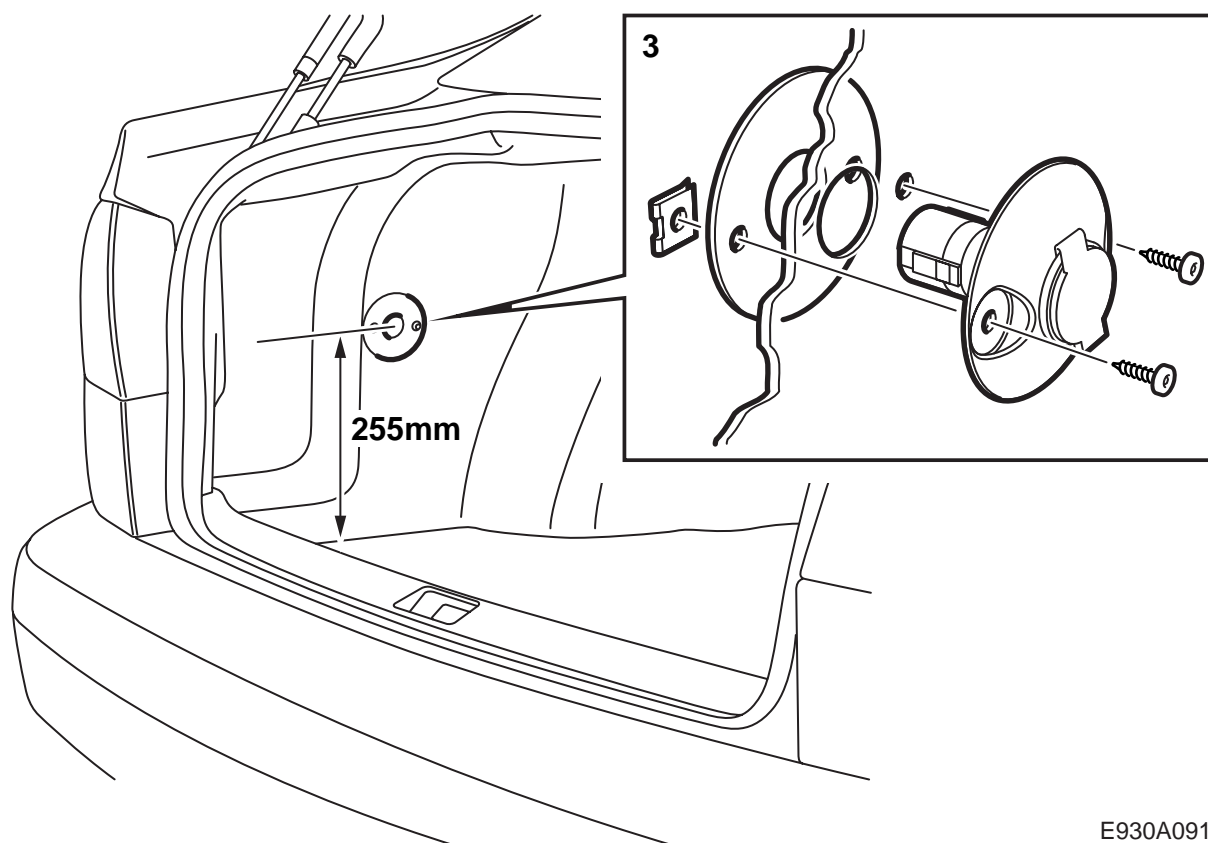

E930A091

9-5

- 1 Place the attaching frame just in front of the pressed part of the side trim, see illustration, with its centre 255 mm above the floor. Make sure the attaching frame does not protrude from the flat part of the trim. Cut out a 30 mm hole at the centre.
- 2 Remove the luggage compartment sill scuff plate.
- 3 Undo the three plastic nuts and bend out the luggage compartment trim. Fit the 12 V socket with the 2 screws, cover, attaching frame and 2 clips. Make sure the hinged cap opens upwards.
- 4 Remove the sill scuff plates on the left-hand side.
- 5 Remove the cover panel under the left-hand side of the dashboard.

- 6 **RHD:** Remove the side trim on the centre console.
- 7 Remove the ACC unit, alternatively the heating and ventilation panel.
- 8 Disconnect the cigarette lighter and plug it into the male connector on the wiring harness. Then, plug the female connector on the wiring harness into the cigarette lighter.

Important

Adjust the length of the wiring harness so that it will be possible to disconnect it.

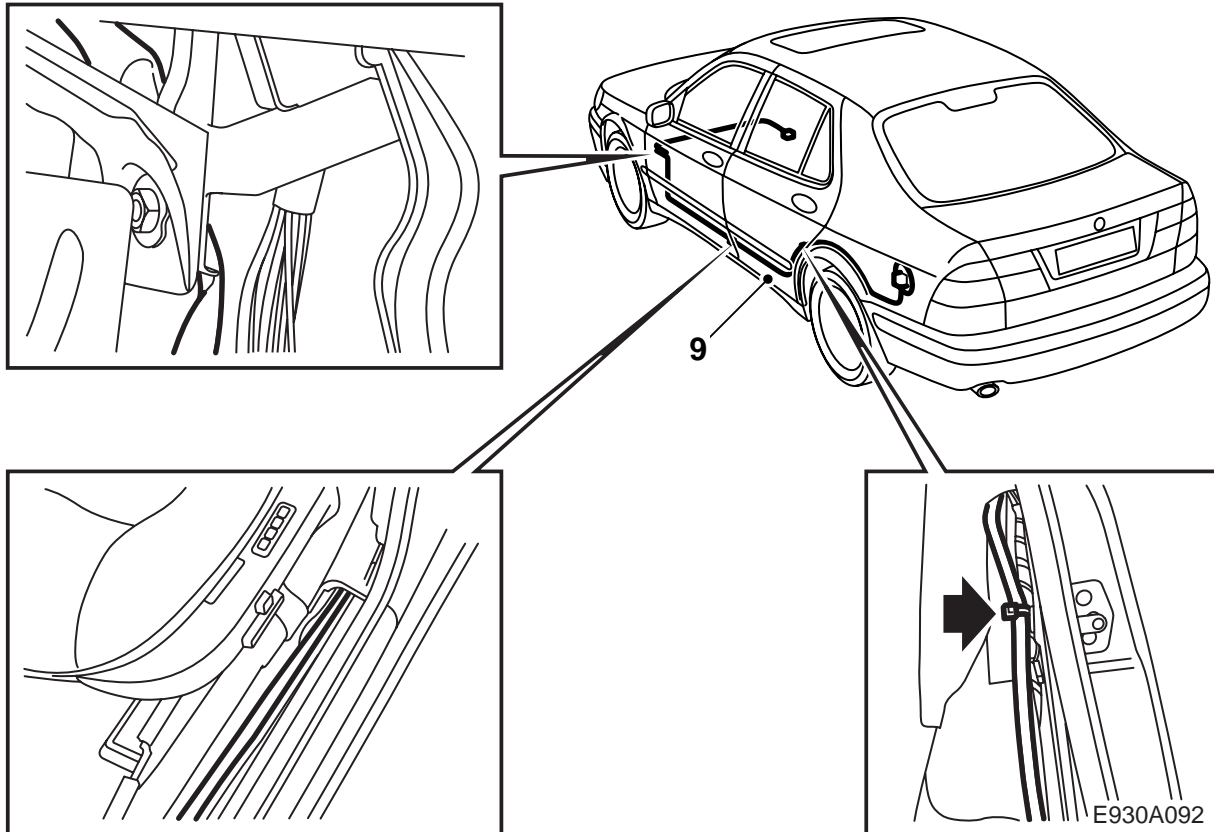

- 9 Lay the wiring harness along the car's wiring harness (it must be inserted into the wiring harness channel along the sills). The wiring harness must pass under the foam block and air duct by the left-hand B-pillar.

The rear edge of the rear door weatherstrip must be loosened to enable the wiring harness to be inserted into the luggage compartment.

- 10 Connect the wiring harness to the 12 V socket and check that 12 V is present in the socket in the luggage compartment.

Important

Adjust the length of the wiring harness so that it will be possible to disconnect it.

- 11 Secure the wiring harness at suitable locations so that it will not become pinched or damaged.

WARNING

Make sure the wiring harness is not close to sharp objects that could cause a short circuit and it will not become pinched when adjusting the steering wheel.

- 12 Position the luggage compartment trim and fit the sill scuff plate.
- 13 Fit the sill scuff plates on the left-hand side.
- 14 **RHD:** Fit the side trim on the centre console.
- 15 Fit the cover panel under the dashboard, alternatively the glove box.
- 16 Refit the ACC unit, alternatively the heating and ventilation panel.

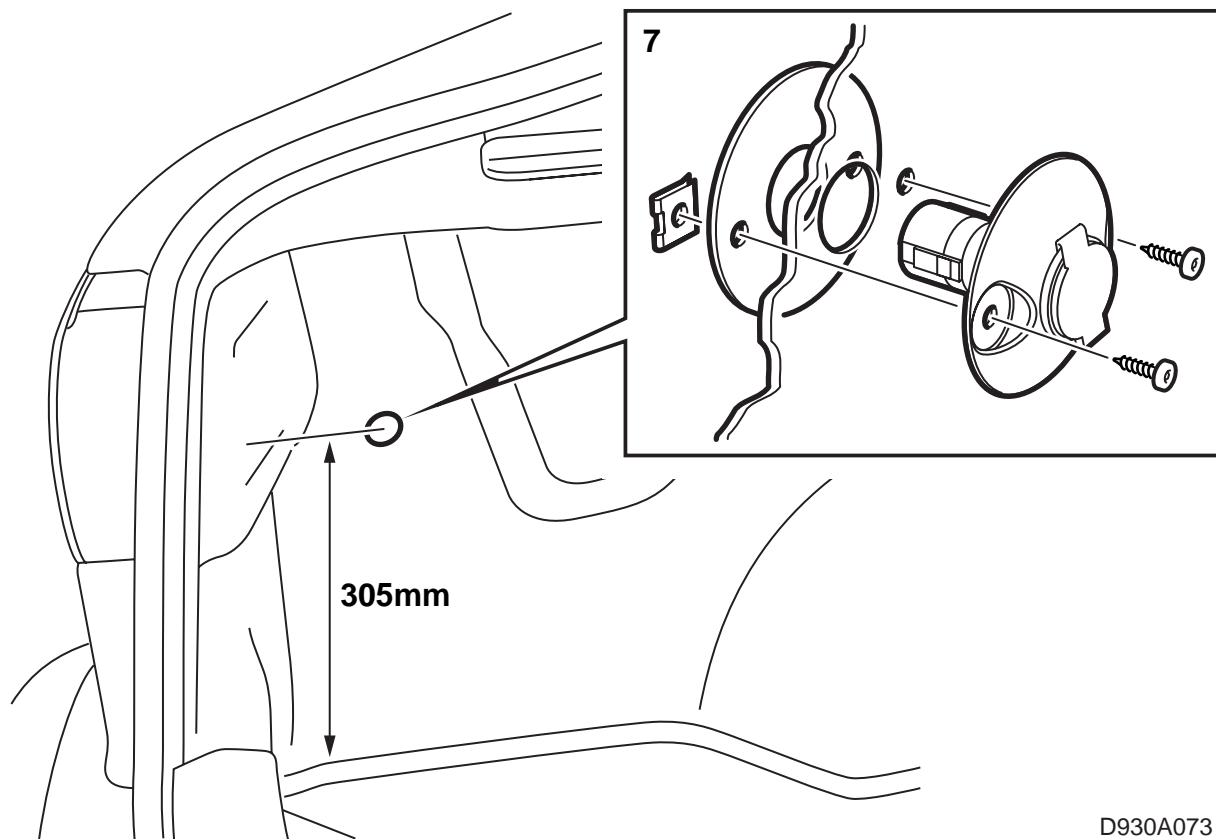

D930A073

900/9-3

- 1 Fold forward the rear seat cushions and backrest.
- 2 Pull loose the bottom part of the door seal on the left-hand side.
- 3 Place the attaching frame just behind the pressed part of the side trim, see illustration, with its centre 305 mm above the floor. Cut out a 30 mm hole at the centre.
- 4 Remove the rear load retainer loops and sill scuff plate in the luggage compartment.
- 5 Lift out the parcel shelf.
- 6 Remove the screws securing the attaching frame for the rear left speaker.
- 7 Undo the plastic nut on the rear left lamp and bend out the left-hand section of the luggage compartment trim. Fit the 12 V socket with the 2 screws, cover, attaching frame and 2 clips. Make sure the hinged cap opens upwards, see illustration.

Important

Secure the antenna cable so that is not damaged.

- 8 **5D:** Remove the sill scuff plate on the left-hand side and the lower section of the B-pillar trim.
2D/3D: Remove the left-hand side trim and the sill scuff plate on the left-hand side.

- 9 **LHD:** Undo the data link connector and remove the cover under the left-hand side of the dashboard (7 screws and 2 clips).

RHD: Remove the glove box.

- 10 Remove the ashtray and ashtray insert.
- 11 Disconnect the cigarette lighter and plug it into the male connector on the wiring harness. Then, plug the female connector on the wiring harness into the cigarette lighter.

Important

Adjust the length of the wiring harness so that it will be possible to disconnect it.

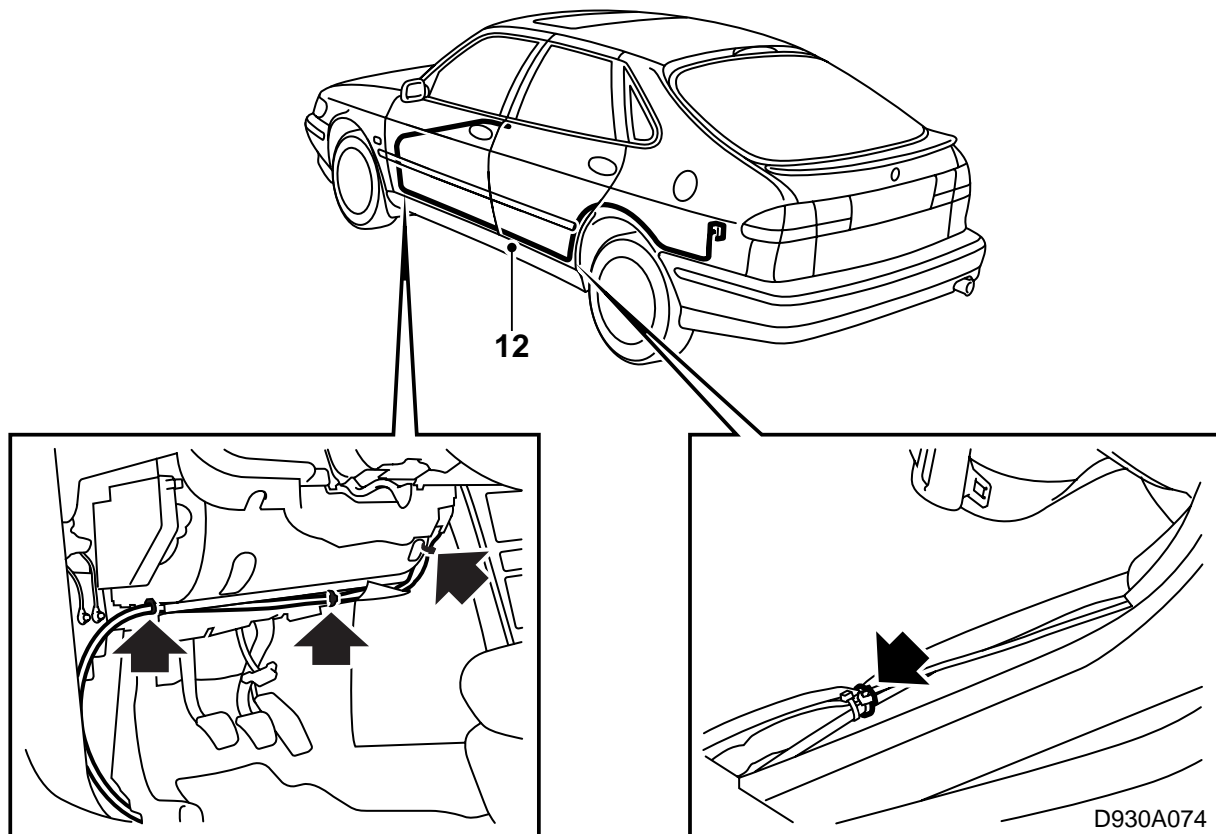

- 12 Lay the wiring harness along the car's wiring harness (it must be inserted into the wiring harness channel along the sills) up to the luggage compartment.
- 13 Connect the wiring harness to the 12 V socket and check that 12 V is present in the socket in the luggage compartment.

Important

Adjust the length of the wiring harness so that it will be possible to disconnect it.

- 14 Secure the wiring harness at suitable locations so that it will not become pinched or damaged.

WARNING

Make sure the wiring harness is not close to sharp objects that could cause a short circuit and it will not become pinched when adjusting the steering wheel.

- 15 Position the luggage compartment trim and tighten the screws to the speaker attaching frame and luggage compartment trim.
- 16 Fit the luggage compartment sill scuff plate and rear load retainer loops.
- 17 **5D**: Fit the lower section of the left-hand B-pillar trim.
- 18 **LHD**: Fit the cover under the left-hand side of

the dashboard (7 screws and 2 clips) and refit the data link connector.

RHD: Fit the glove box.

- 19 Refit the ashtray insert and ashtray.
- 20 Press on the door seals on the left-hand side.
- 21 **5D**: Fit the sill scuff plates on the left-hand side.
2D/3D: Fit the side trim and sill scuff plate.
- 22 Fold back the rear seat backrest and cushions.
- 23 Lift the parcel shelf in place.