



**MONTERINGSANVISNING · INSTALLATION INSTRUCTIONS
MONTAGEANLEITUNG · INSTRUCTIONS DE MONTAGE**

Saab 9-5 5D -M01

Seat belt, rear seat centre

Accessories Part No.	Group	Date	Instruction Part No.	Replaces
52 06 776 52 06 784 55 53 516 55 53 557	8:53-21	Nov 04	52 06 859	Mar 01

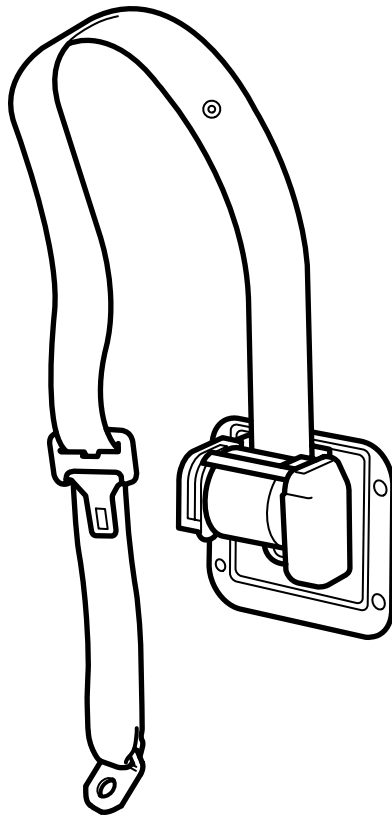

E980A295

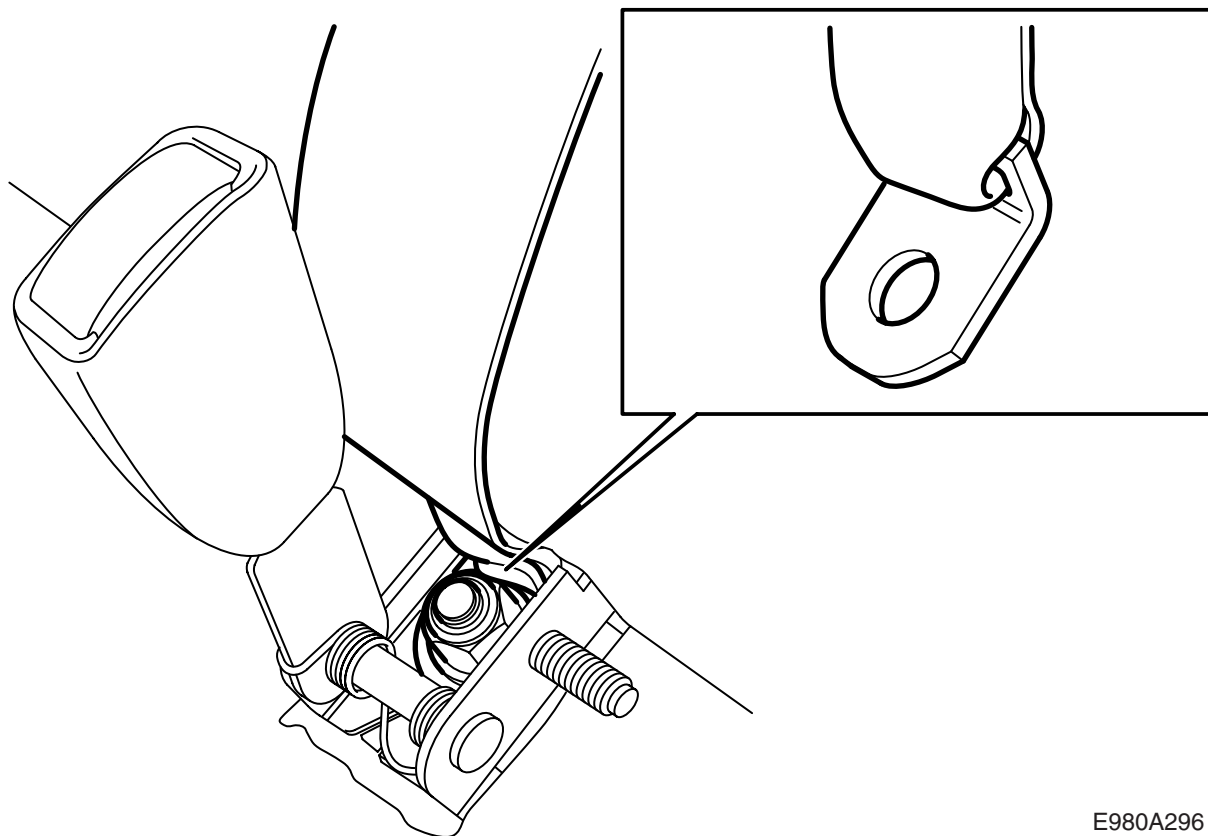

E980A296

Supplement to description in WIS

When fitting the lower anchorage for the centre seat belt, the new belt must be mounted using the same nut as the one securing the seat belt buckle.

- 1 Remove the seat belt buckle nut and place the centre seat belt lower anchorage over the weld screw for the belt buckle.
- 2 Fit the seat belt buckle nut.

Tightening torque 45 Nm (33lbf ft)