

**MONTERINGSANVISNING · INSTALLATION INSTRUCTIONS
MONTAGEANLEITUNG · INSTRUCTIONS DE MONTAGE****Saab 9-3 4D/CV M03-**

(EC 94/20, E4 00 1958)

Accessories Part No.	Group	Date	Instruction Part No.	Replaces
12 804 701 32 026 047	9:86-02	2007 10	12 797 882	Jun 07

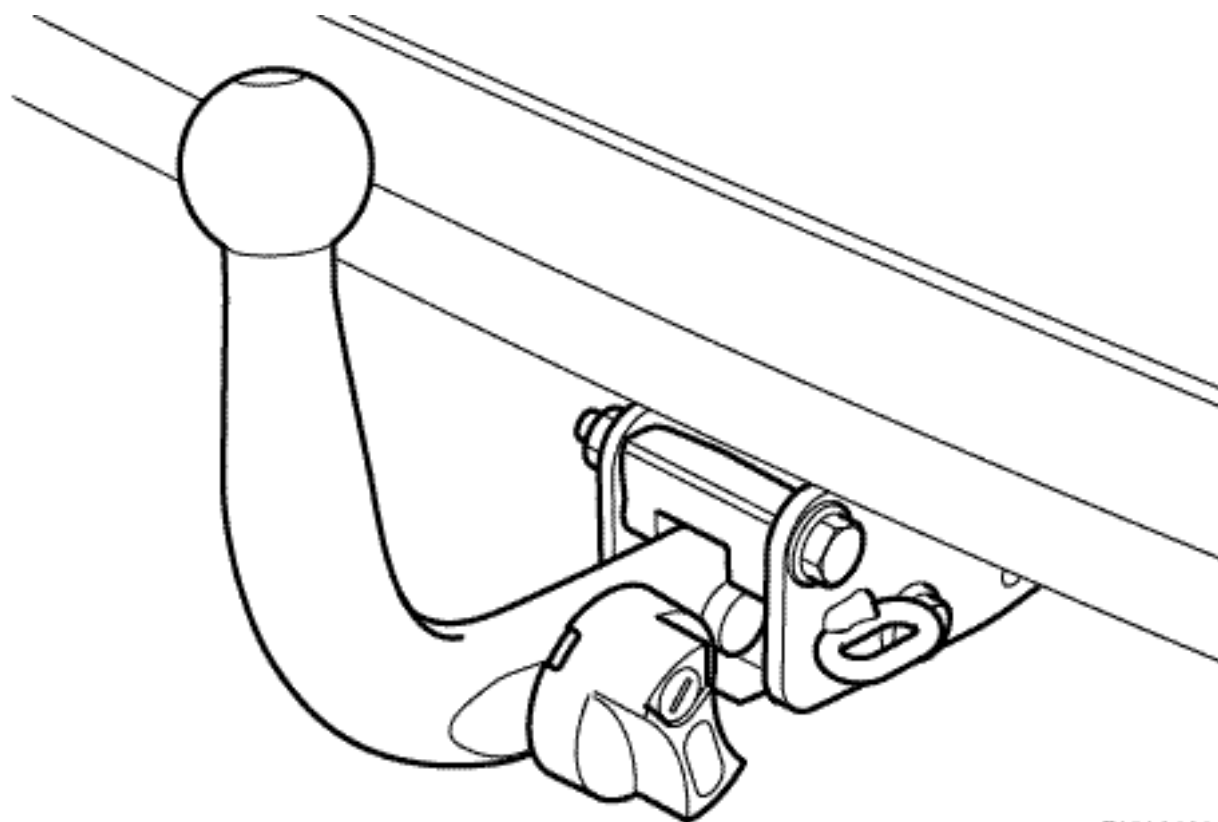

F980A020

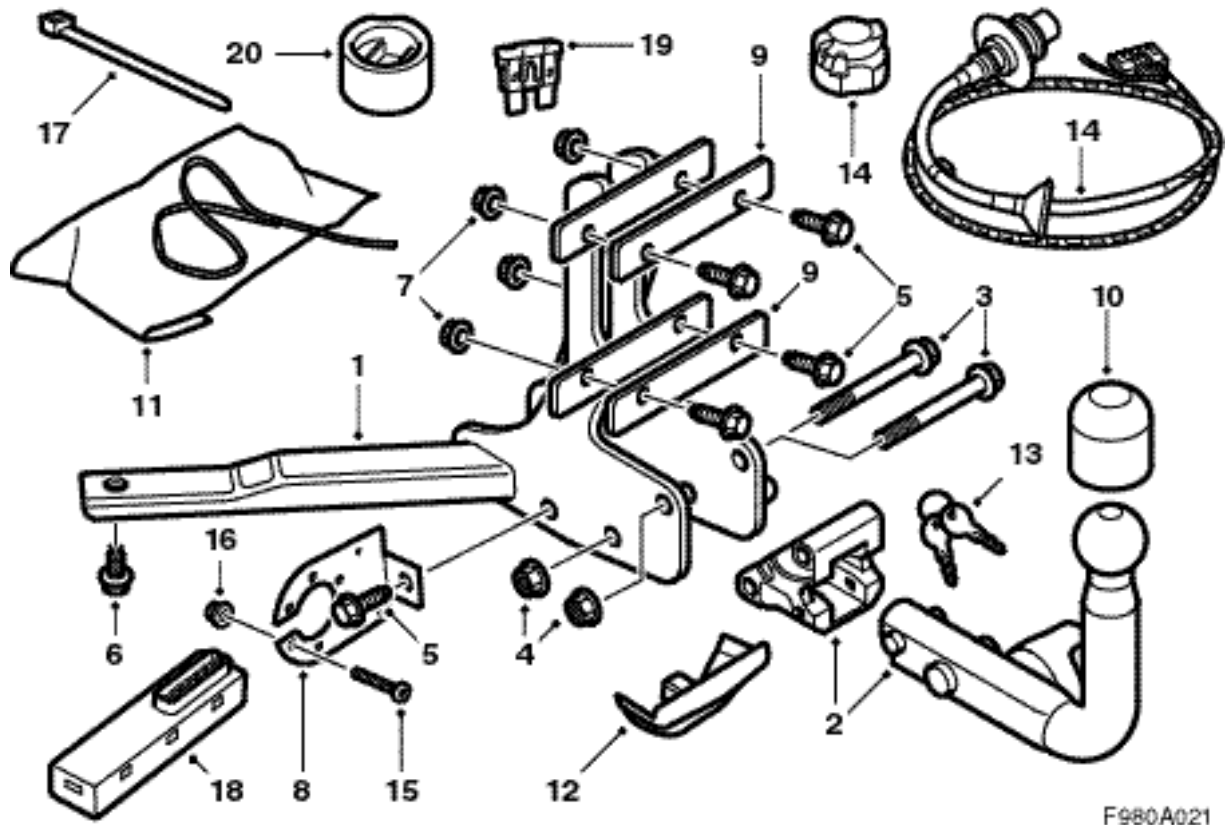

F980A021

- 1
- 2
- 3 (2)
- 4 (2)
- 5 (5)
- 6 (2)
- 7 (5)
- 8
- 9 (2)
- 10
- 11
- 12 ()
- 13 (2)
- 14 , 13
- 15 (3)
- 16 (3)
- 17 (4)
- 18
- 19
- 20

가 .

94/20/EEC .

:

: 1600kg (3500lbs)

:

50%, 750kg (1650 lbs).

: 75kg

: 8.91kN

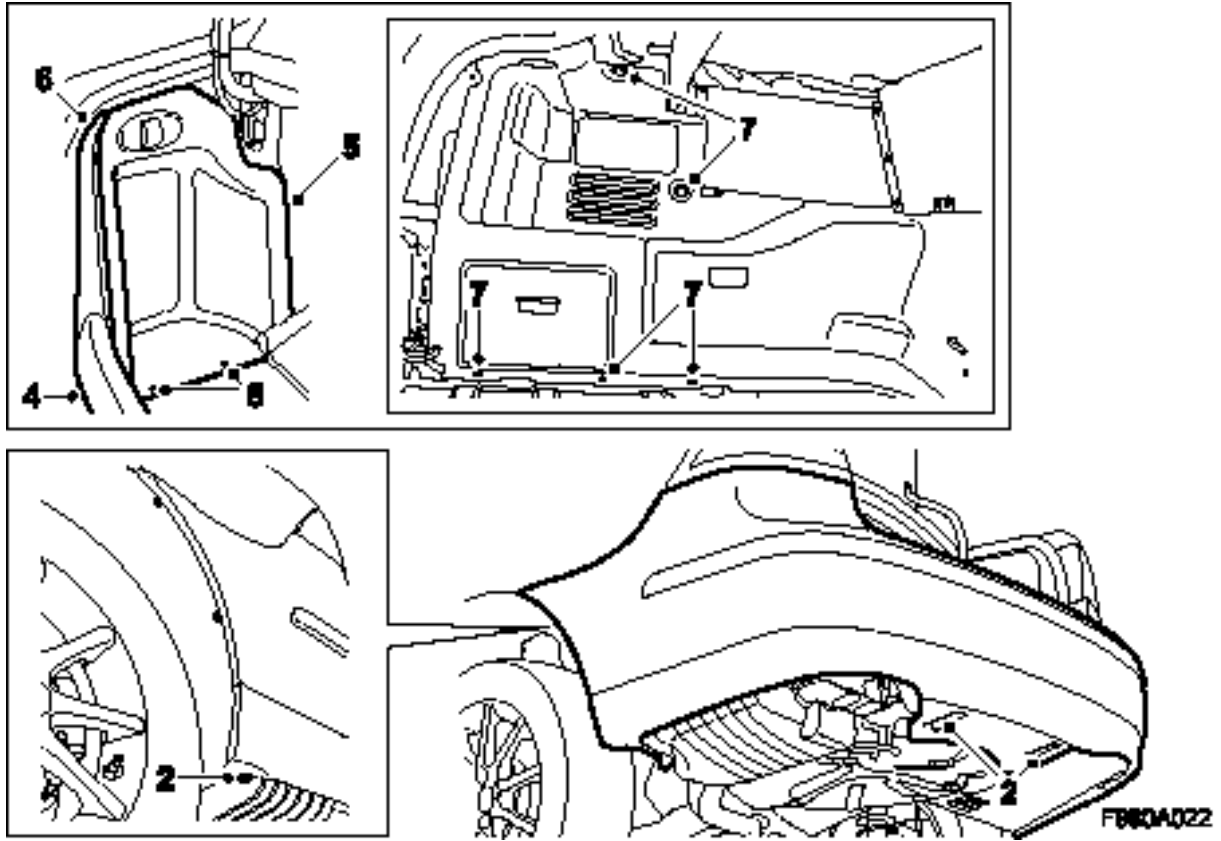

1

2

3

CV:

4

5 4D:

6

7

CV:

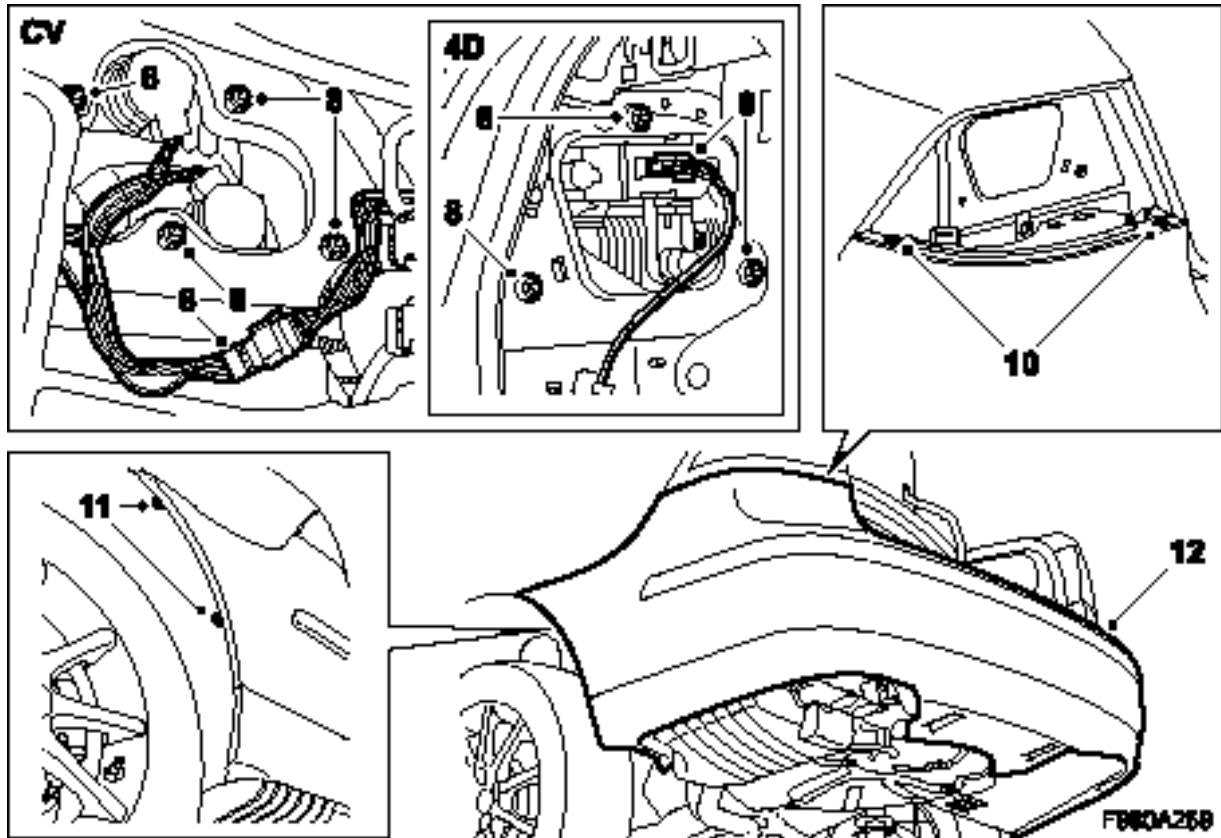

- 8
- 9 SPA:
- 10
- 11
- 12

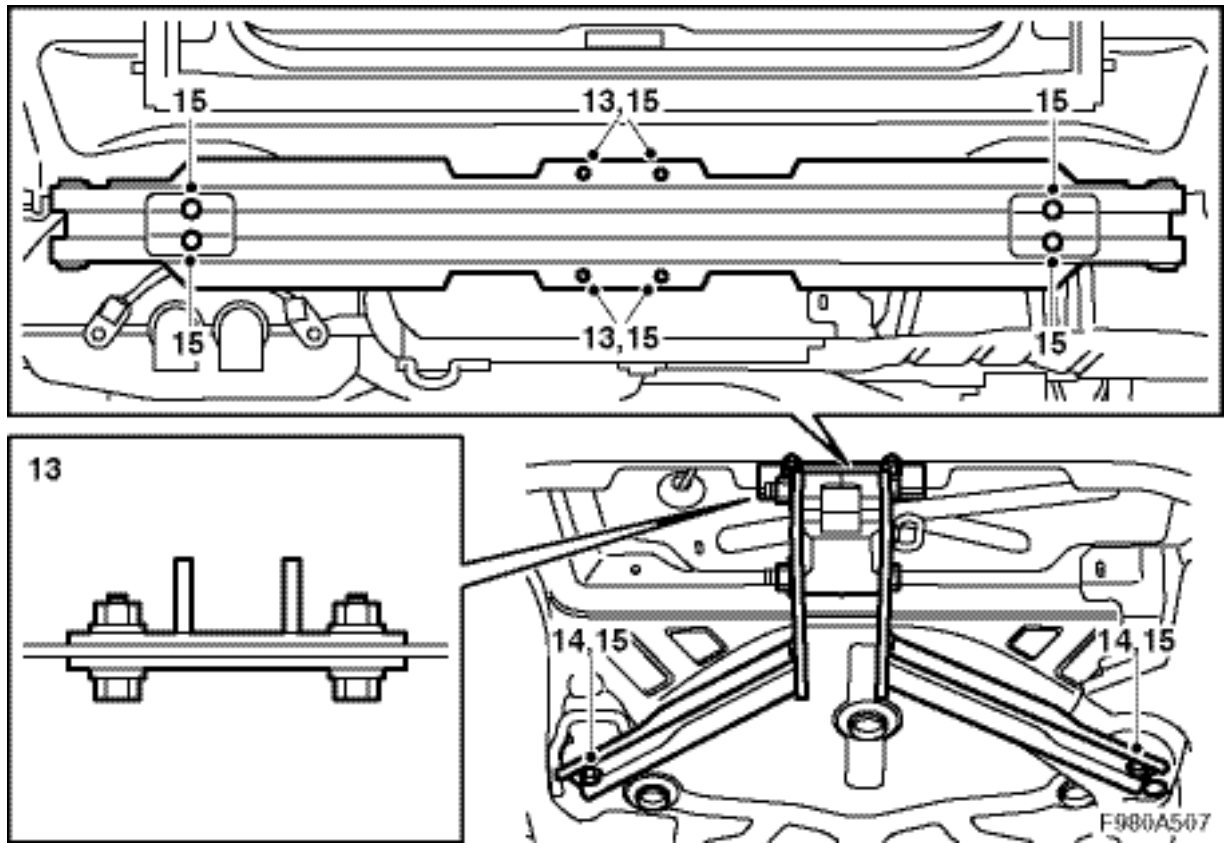

13

14

15

(37lbf ft) : 50Nm

(37lbf ft) : 50Nm

(37lbf ft) : 50Nm

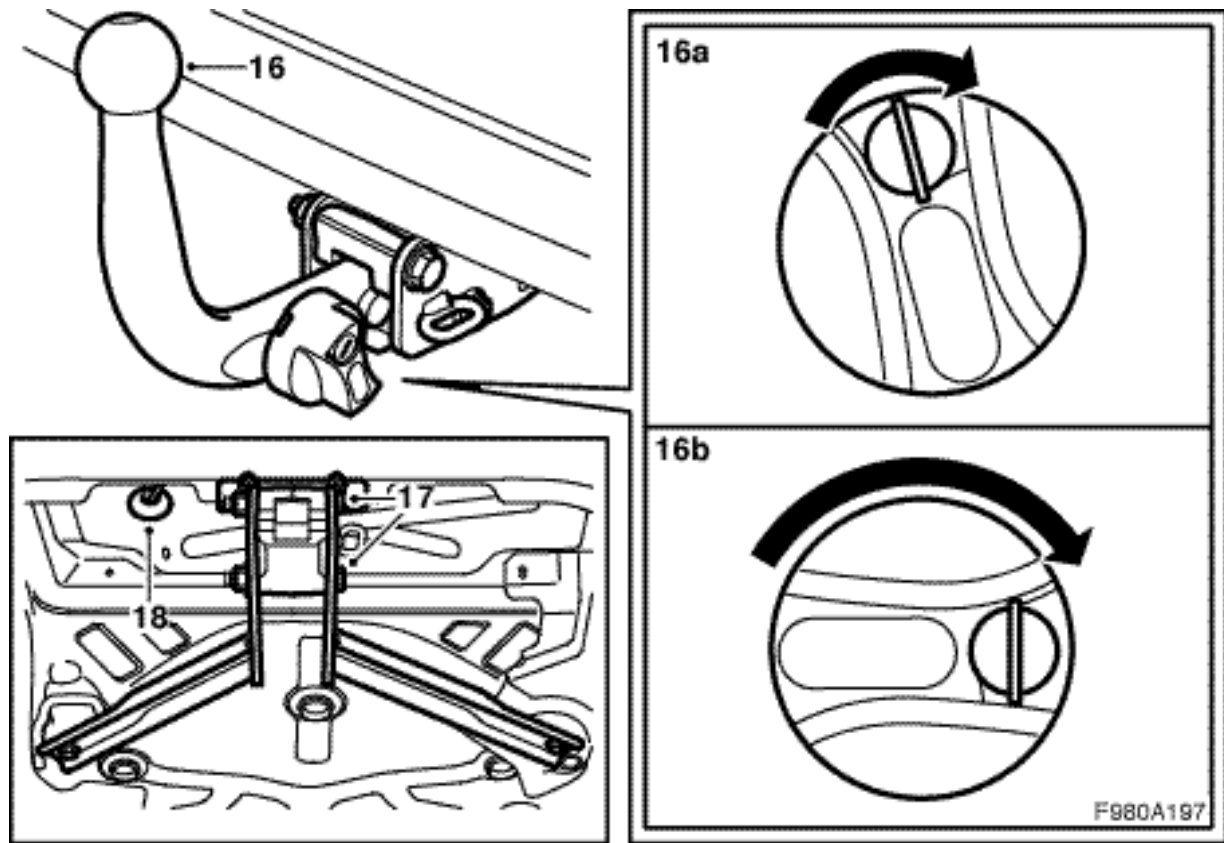

16

a

b

가

c

17

: 90Nm (66.5lbf ft).

18

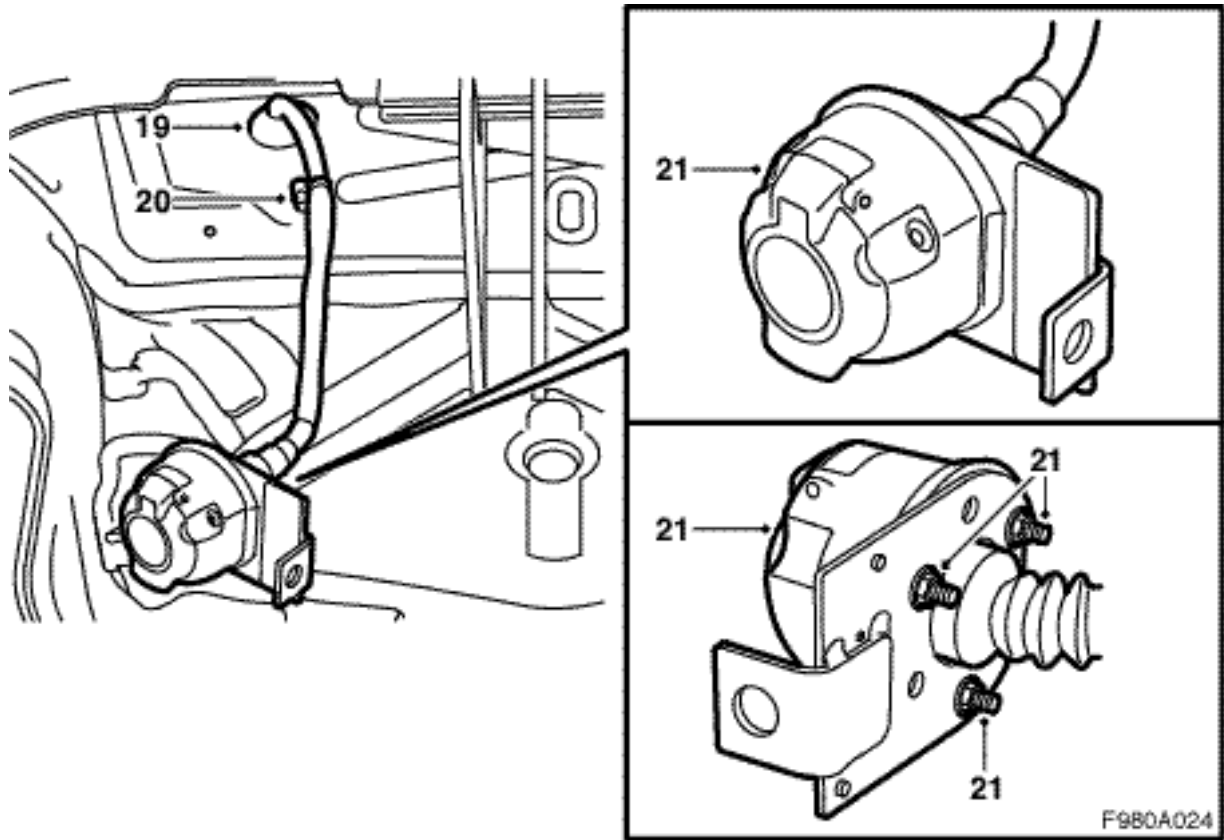

19

20

21

13

가

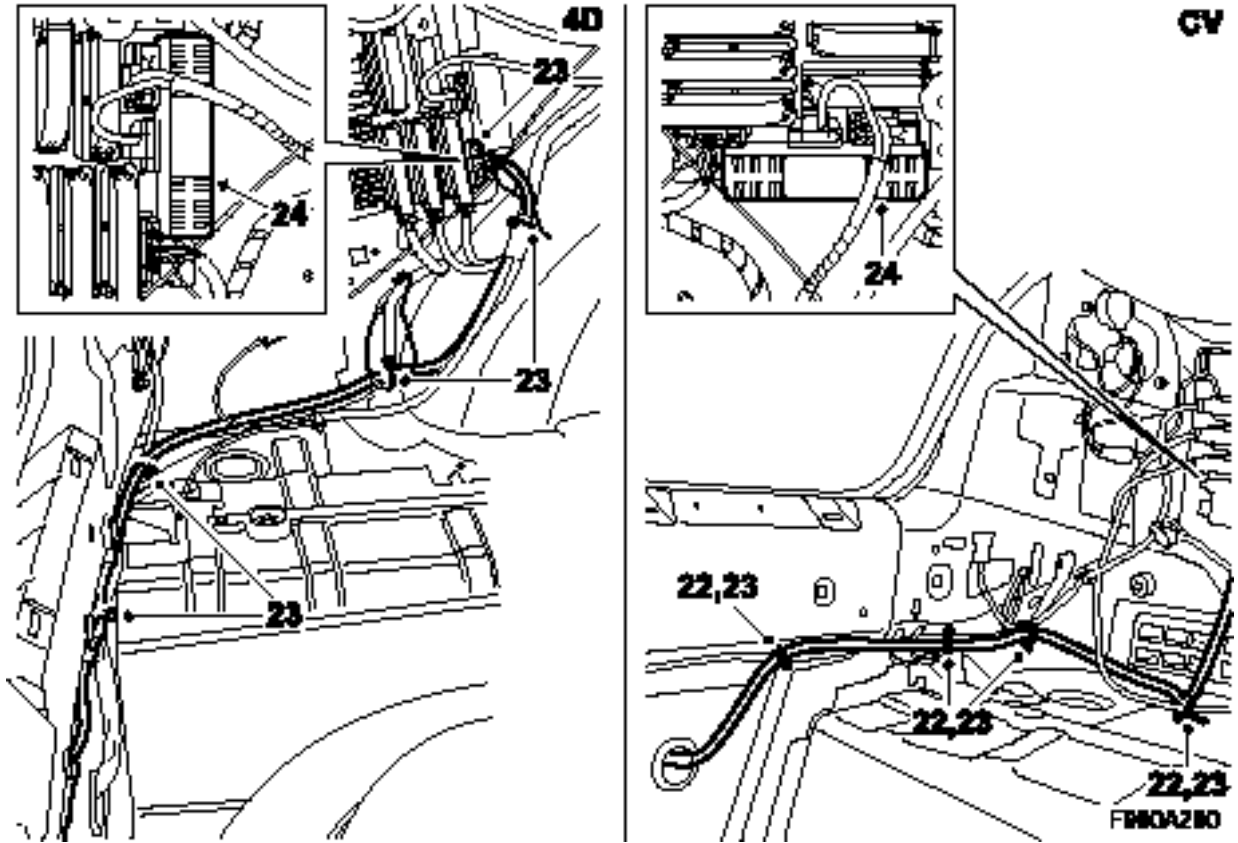

22 가

23 4

(BU/WH) 가 가 /

24 8

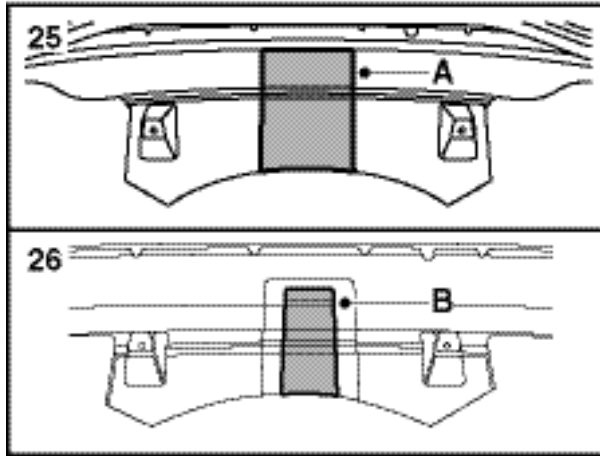
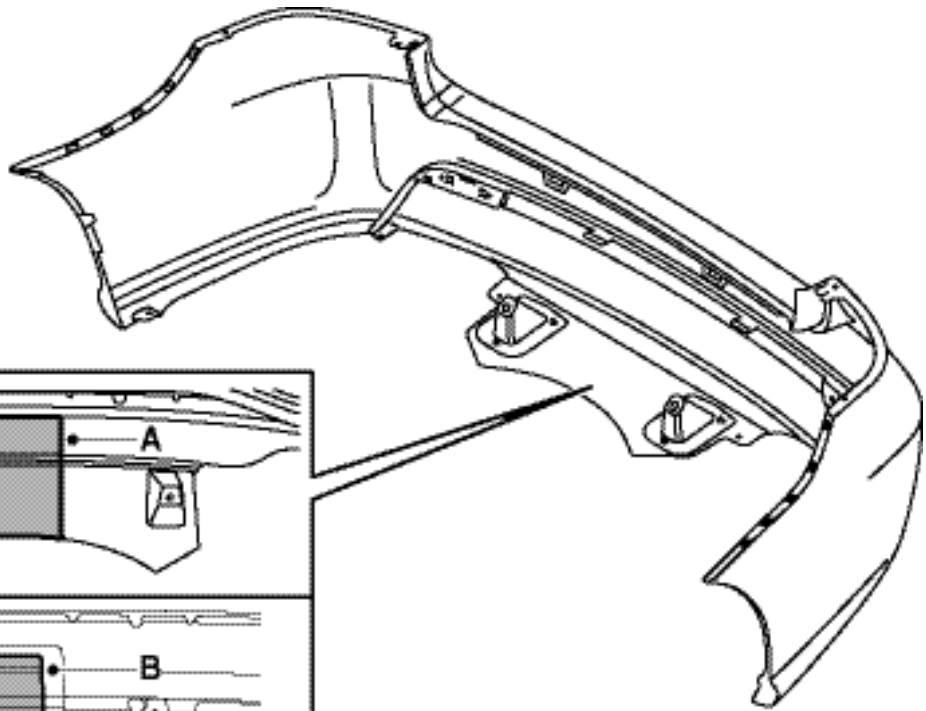

F980A523

25 M03-07,
(A)

26 M03-07,
(B)

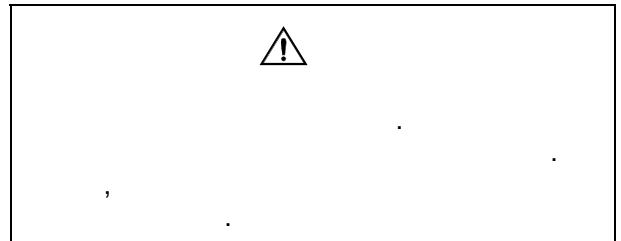
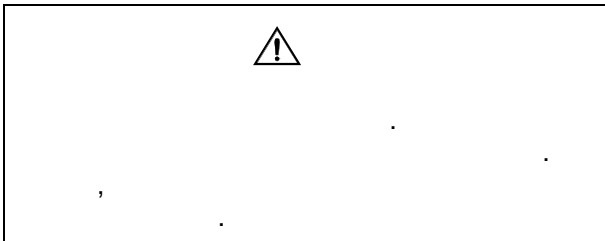

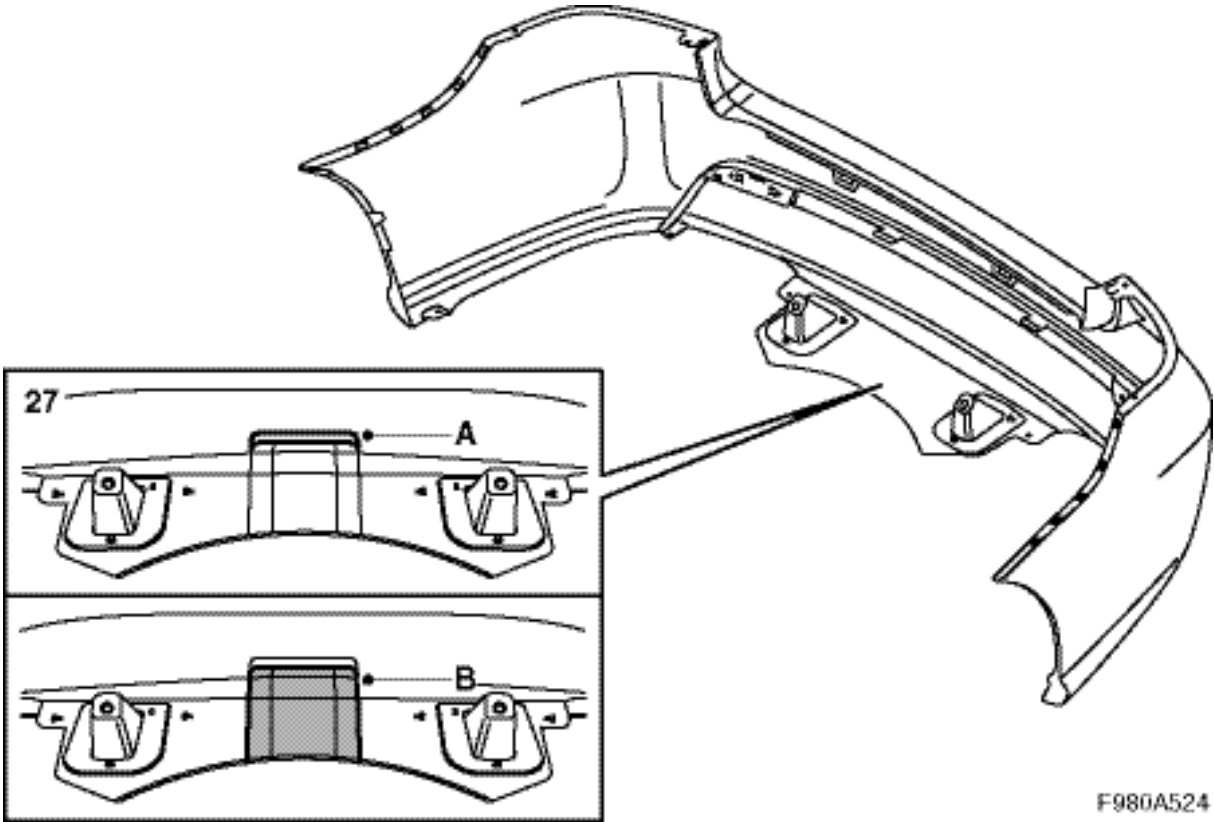

27 M08, :
 27.1 1

가

27.2
 1(A)

27.3 (B) /

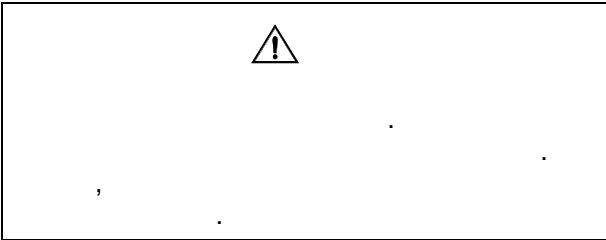

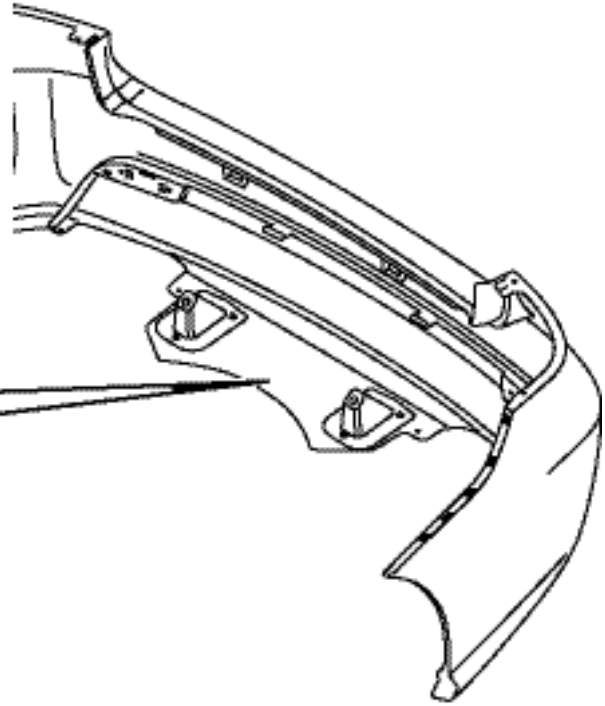
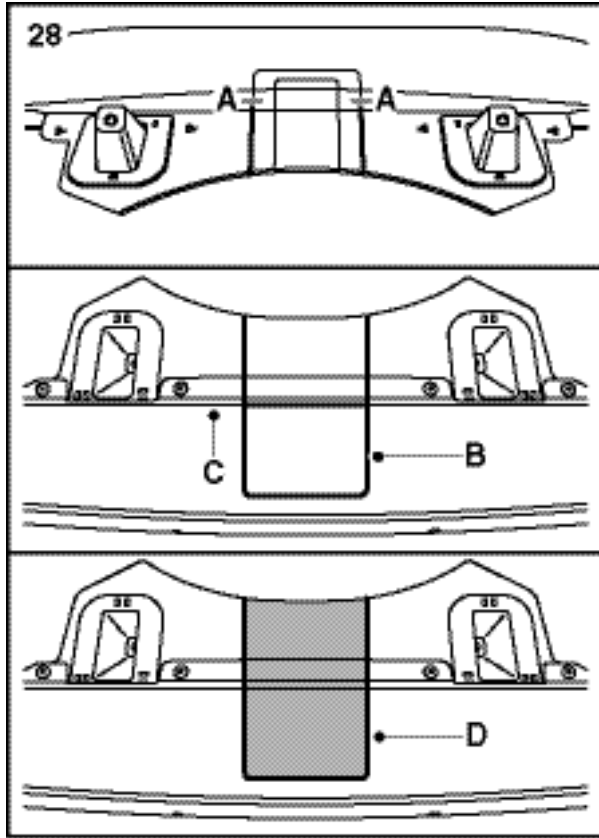

F980A525

28 M08,
28.1 2

28.5 (D)

가

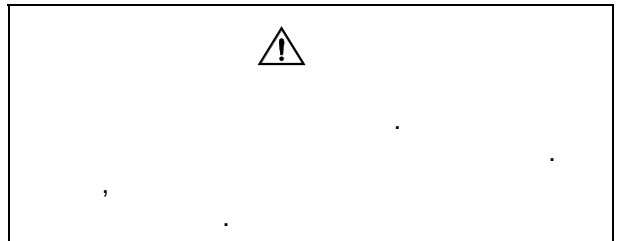

28.2
(A)
28.3
28.4 (C)
2(B)

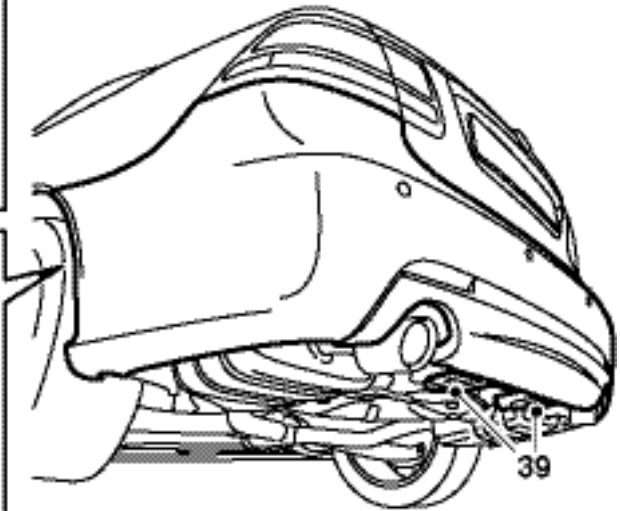
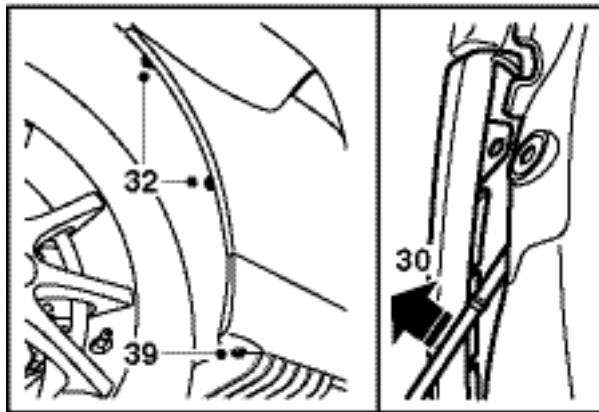
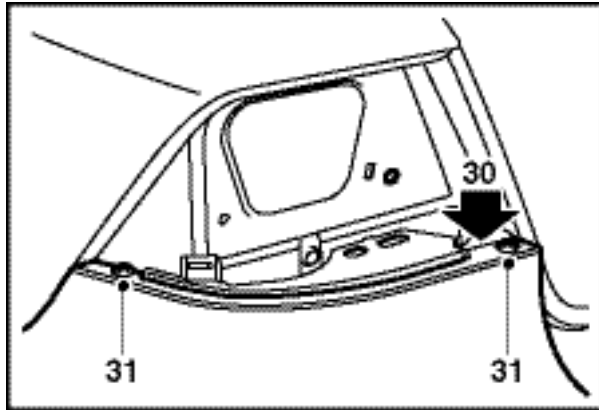

F980A526

29 SPA:

30

31

32

33

34

CV:

35

36

37 4D:

CV:

38

39

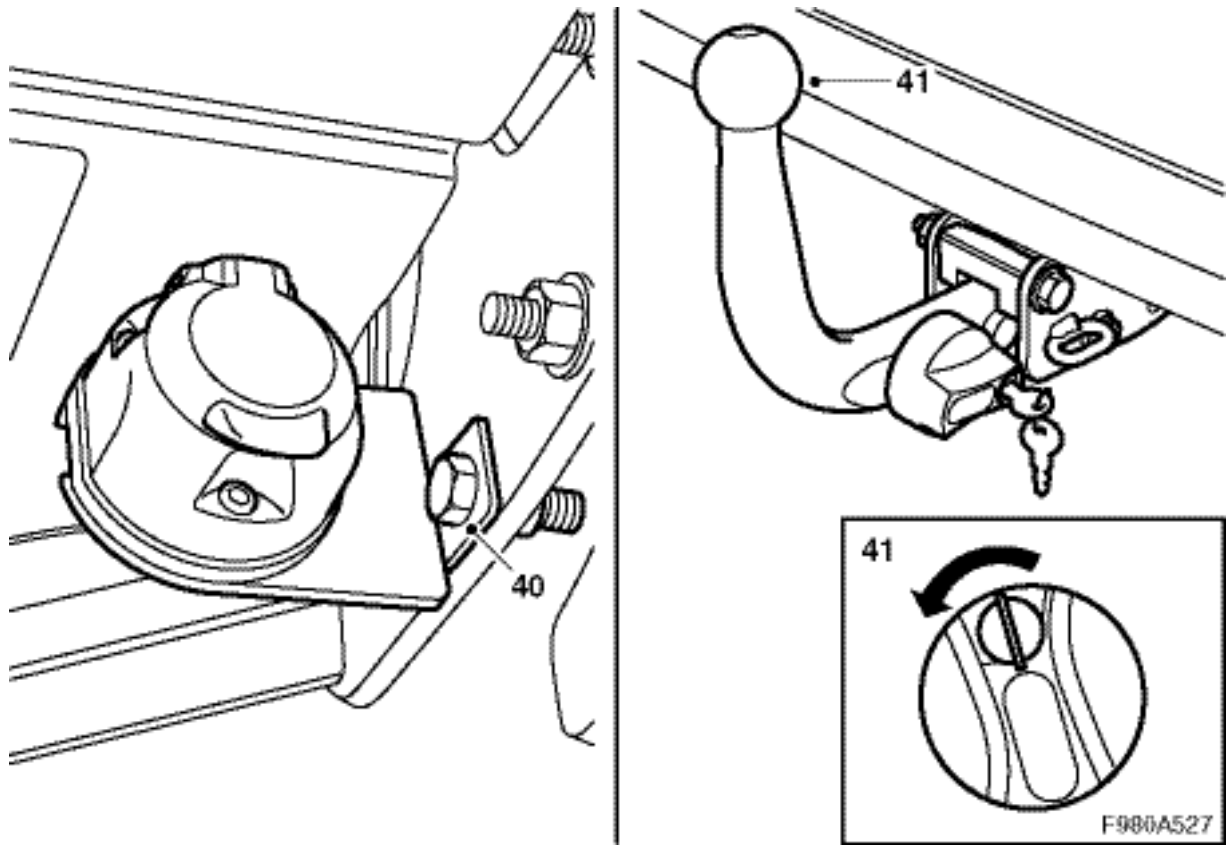

40 가

41 가
가

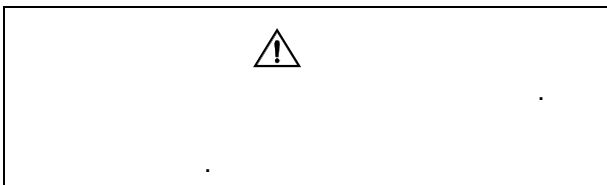

42

43

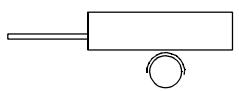
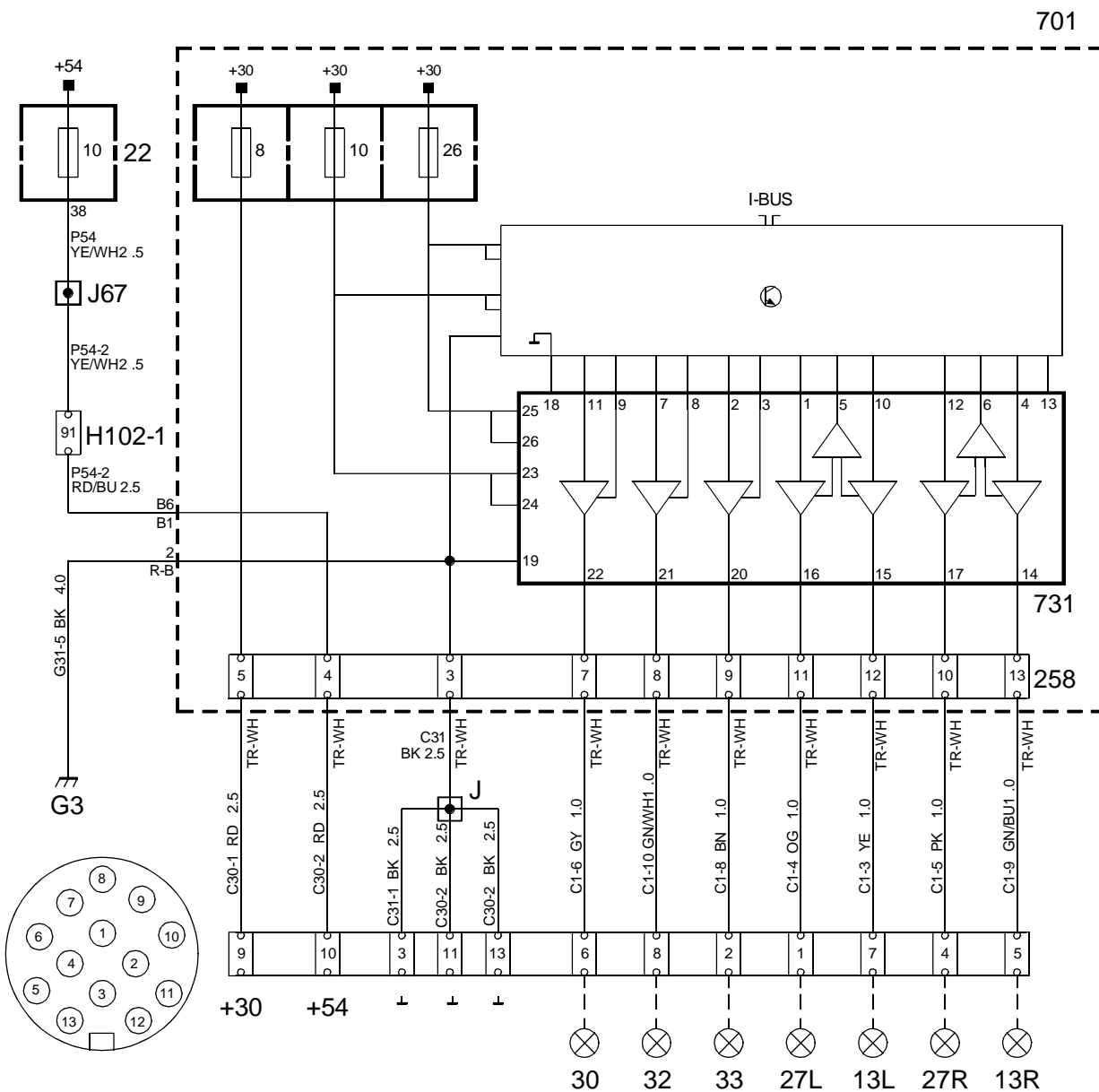

F3L12
021212

13	,	,
22	,	,
27	,	,
30	,	,
32	,	,
33	,	,
258	,	,
701	,	,
731	,	,
102		
H102-1	A	
J	13	160mm
J67	LHD: H102 - 1	150mm
	RHD: G41	G40 50mm
G3		

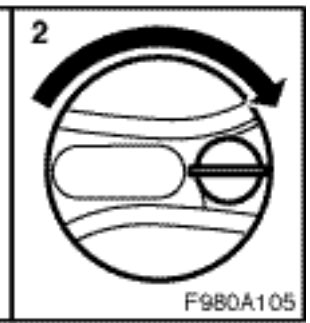
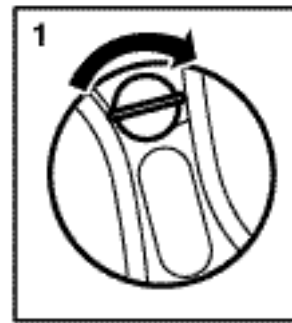
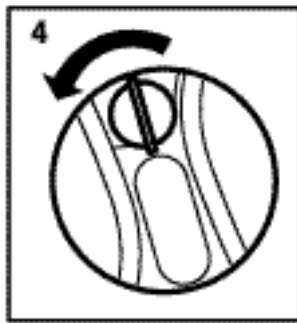
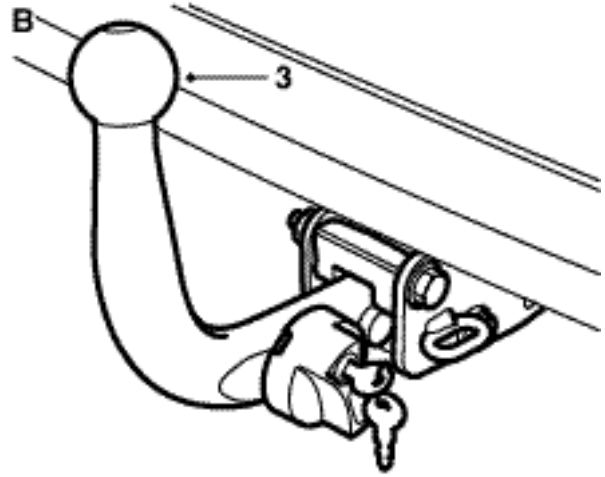
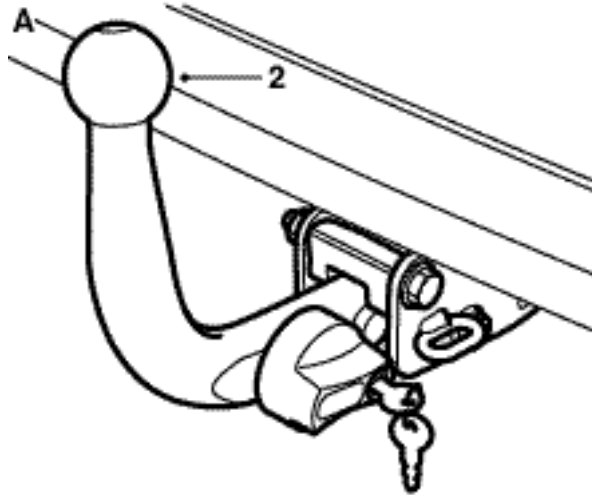

()

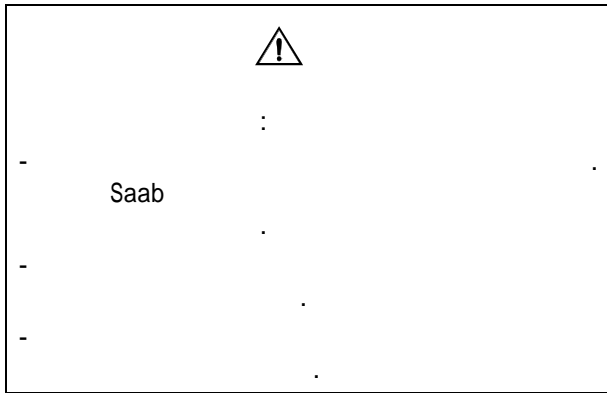

A.

- 1
- 2
- 3

가
가

- 4

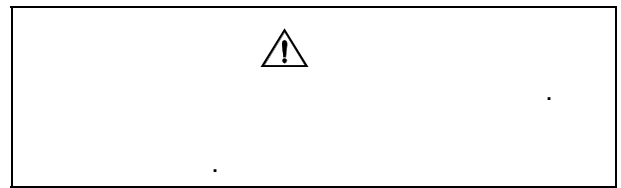

B.

- 1

- 2

가

- 3

- 4

()

가 ISO 11446

13

SPA가

:SPA

1

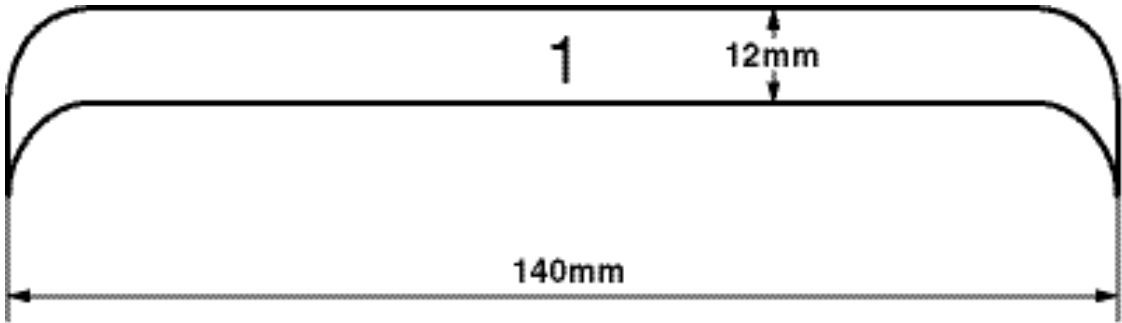

F980A514

