

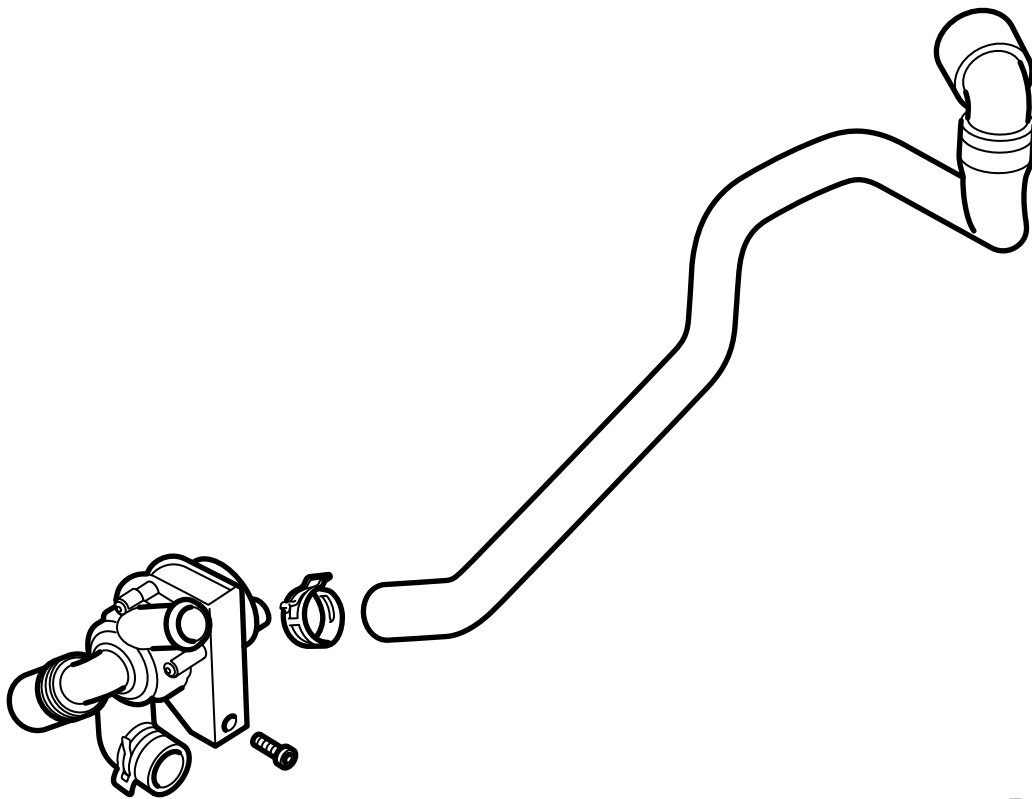

**MONTERINGSANVISNING · INSTALLATION INSTRUCTIONS
MONTAGEANLEITUNG · INSTRUCTIONS DE MONTAGE**

Saab 9-3 D223L M03-
Parking Heater Accessory

Accessories Part No.	Group	Date	Instruction Part No.	Replaces
12 787 160	9:87-37	Feb 03	12 789 068	12 789 068 Mar 02



F920A030

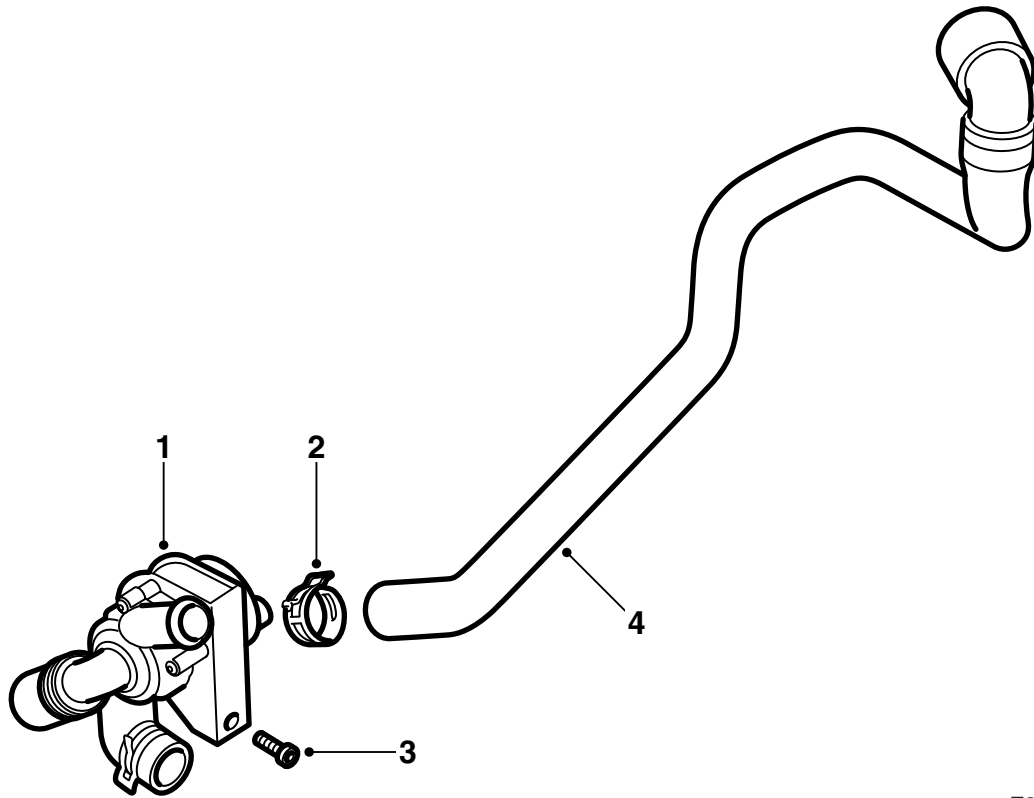

F920A031

- 1 Engine coolant pump
- 2 Hose clip
- 3 Screw
- 4 Hose
- 5 Label (not shown in illustration)

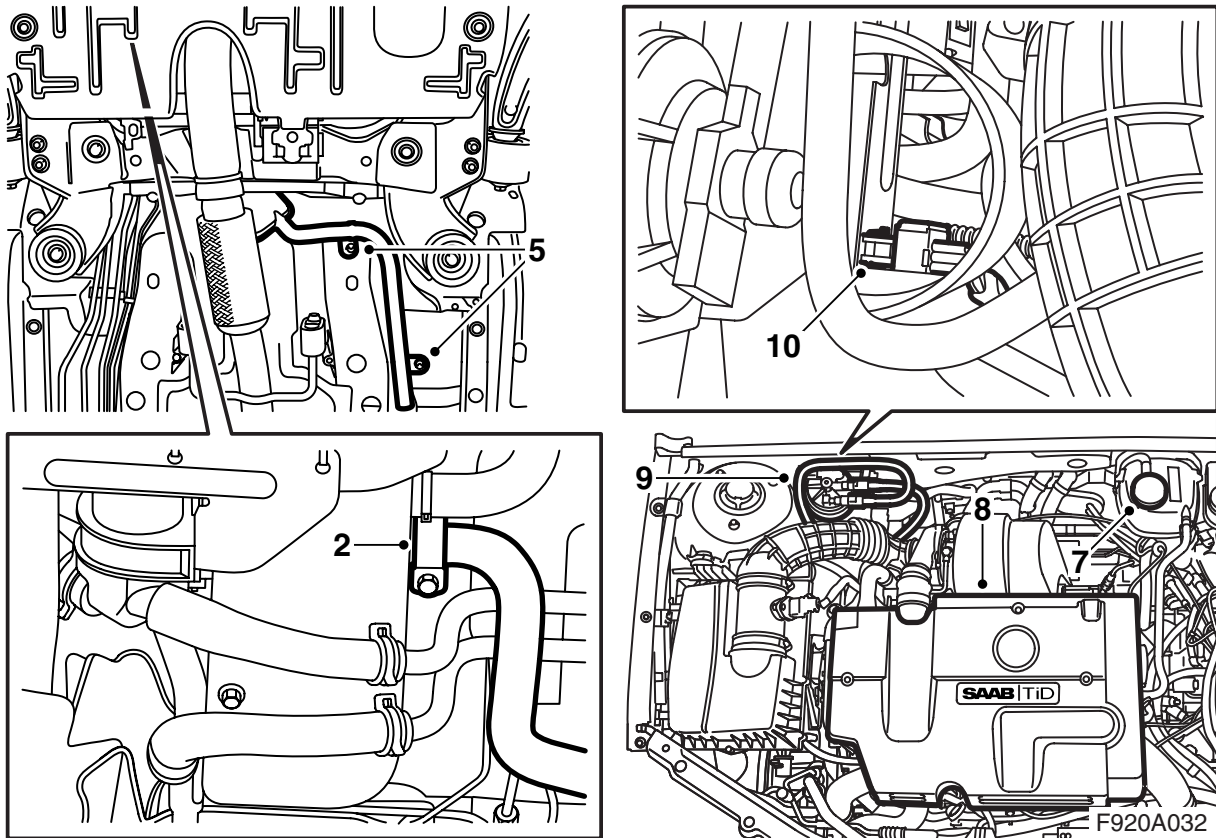

- 1 Disconnect the negative battery cable.
- 2 Undo the clamp on the heater accessory exhaust pipe at the heater.
- 3 Raise the car and remove the spoiler shield. Unplug the bumper connector and remove it from the holder on the spoiler shield.
Cars with headlamp washers: Unhook the hose from the spoiler shield.
- 4 Place a receptacle under the engine, fit a hose to the radiator drain nipple, open the radiator drain plug and drain the coolant.
- 5 Remove the heater exhaust pipe.
- 6 Lower the car.
- 7 Remove the expansion tank cap.
- 8 Remove the engine cover.
- 9 Unplug the fuel filter connector, lift up the filter from its holder and place it to one side.
- 10 Unplug the heater connector.

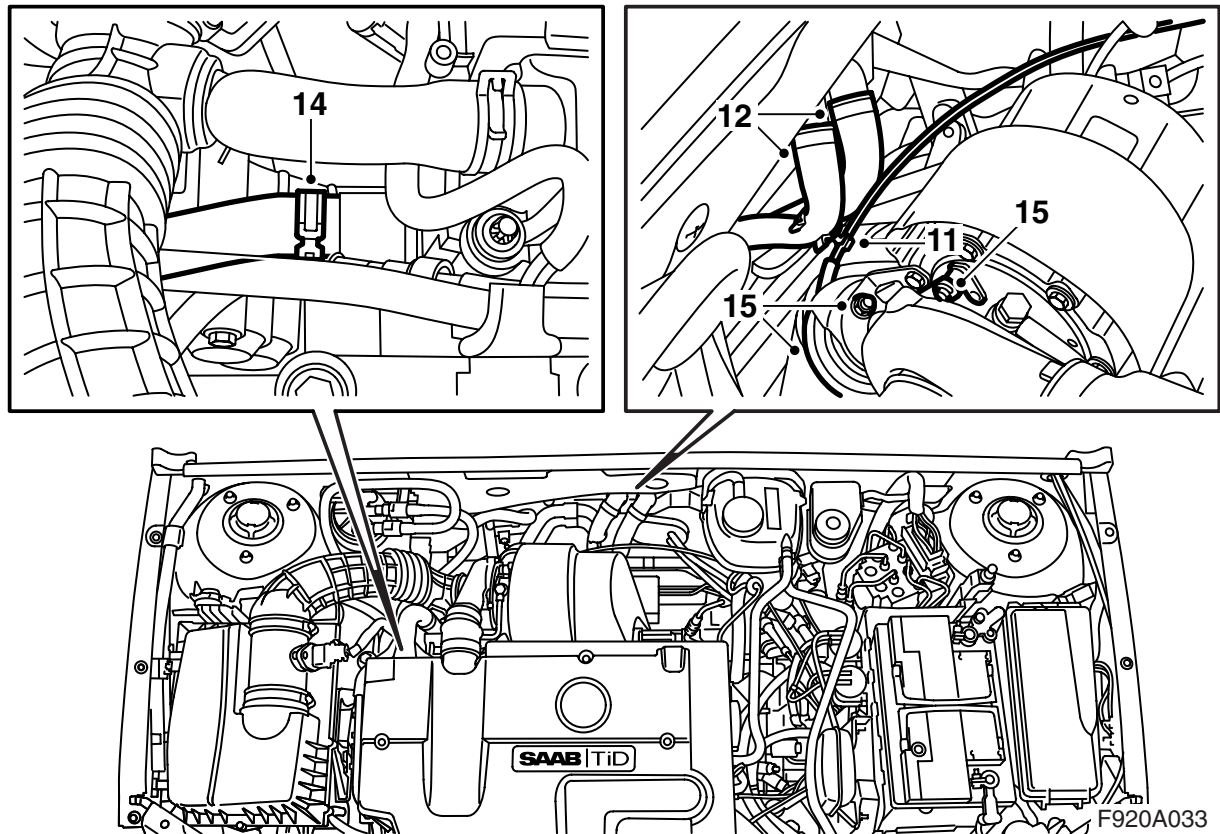

- 11 Remove the hose for the boost pressure regulator diaphragm box from the clip on the coolant hose.
- 12 Detach both coolant hoses from the connection to the cabin and unclip them from the bulkhead wall.
- 13 Bend the coolant hose connected to the engine out of the way.
- 14 Disconnect the coolant hose running between the heater and the cylinder head from its connection on the cylinder head and unclip it from the fuel filter hose.
- 15 Remove the boost pressure regulator diaphragm and put it to one side.

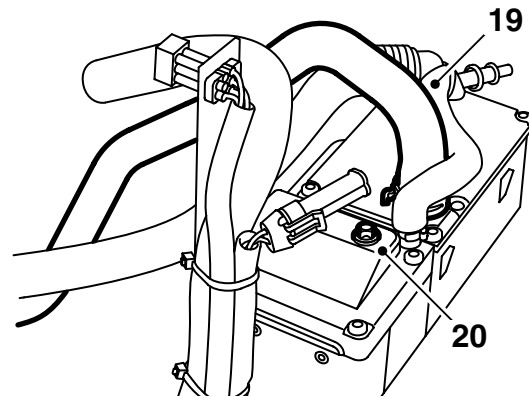
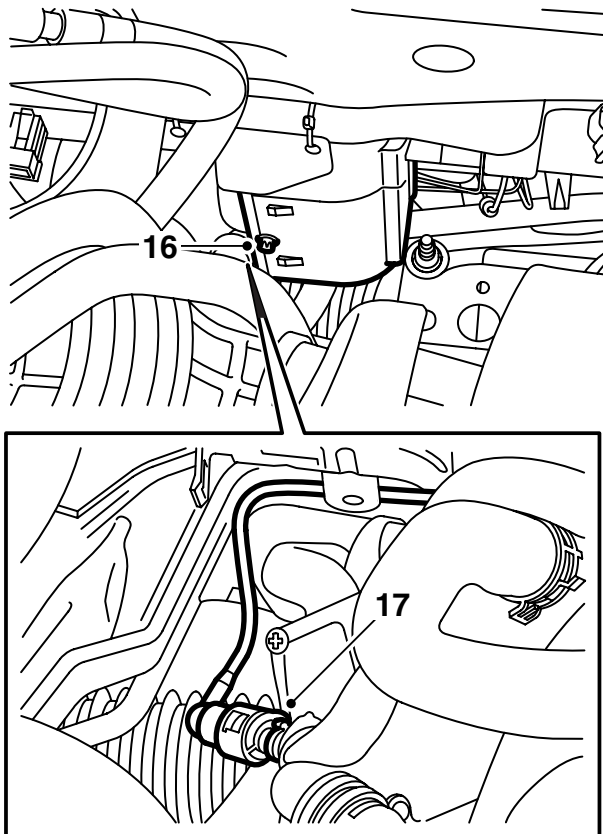

F920A034

- 16 Remove the heater from the mounting on the bulkhead wall.
- 17 Remove the fuel hose from the heater using special tool 83 95 261.

- 19 Remove the coolant hose for the heat exchanger in the cabin.
- 20 Unscrew the connector bracket (the screw will not be used again).

⚠ WARNING

Removing the fuel hose involves work on the car's fuel system. The following points must therefore be observed in conjunction with these measures:

- Provide good ventilation. If approved fuel fume extractors are available, then they should be used.
- Wear protective gloves. Prolonged contact with petrol can cause skin irritation.
- Keep a class BE fire extinguisher close to hand! Pay attention to the risks caused by sparks, e.g. in conjunction with breaking power circuits, short circuiting, etc.
- Smoking is absolutely forbidden.
- Use protective goggles.

- 18 Lift out the heater and place it on a workbench.

Important

There is still coolant in the heater.

Take care not to deform the heater's intake hose.

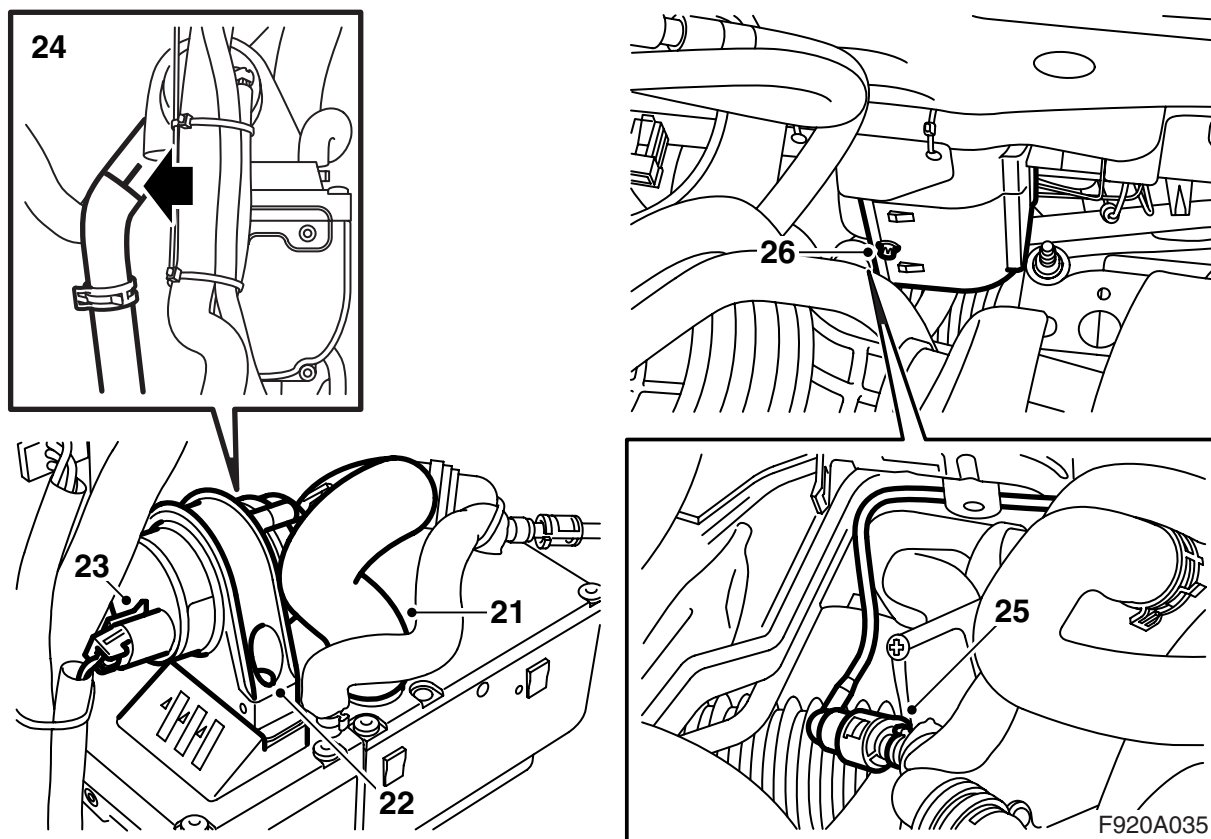

- 21 Connect the circulation pump coolant hose to the heater.
- 22 Fit the circulation pump to the heater with the screw included in the kit.
- 23 Remove the moisture protection from the connector and connect the circulation pump.
- 24 Connect the coolant hose to the heater.
- 25 Lower the heater into the engine bay and connect the fuel line.

Important

Take care not to deform the heater's intake hose.

- 26 Fit the heater to the mounting on the bulkhead wall.

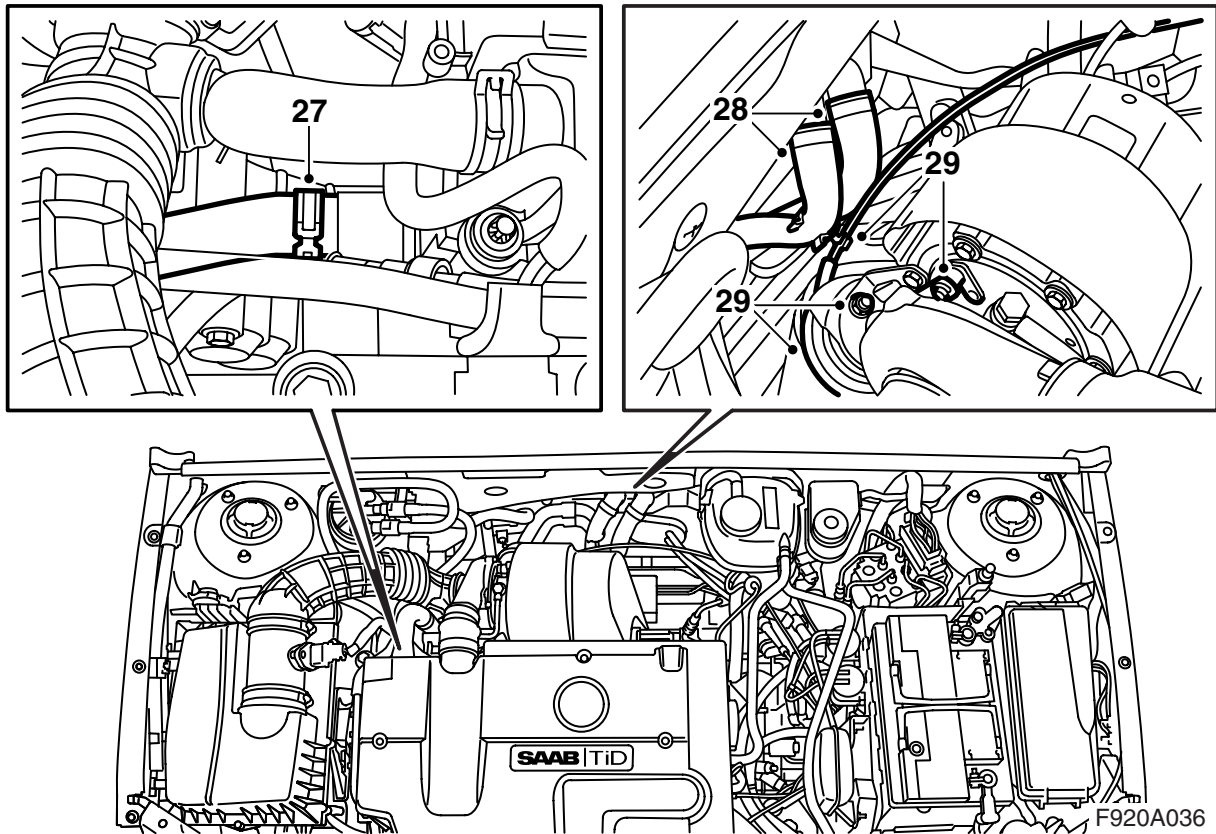

- 27 Connect the coolant hose to the cylinder head.
- 28 Connect the coolant hoses to the connection for the cabin and clip them to the bulkhead wall.
- 29 Fit the boost pressure regulator diaphragm box and clip its hose to the coolant hose.

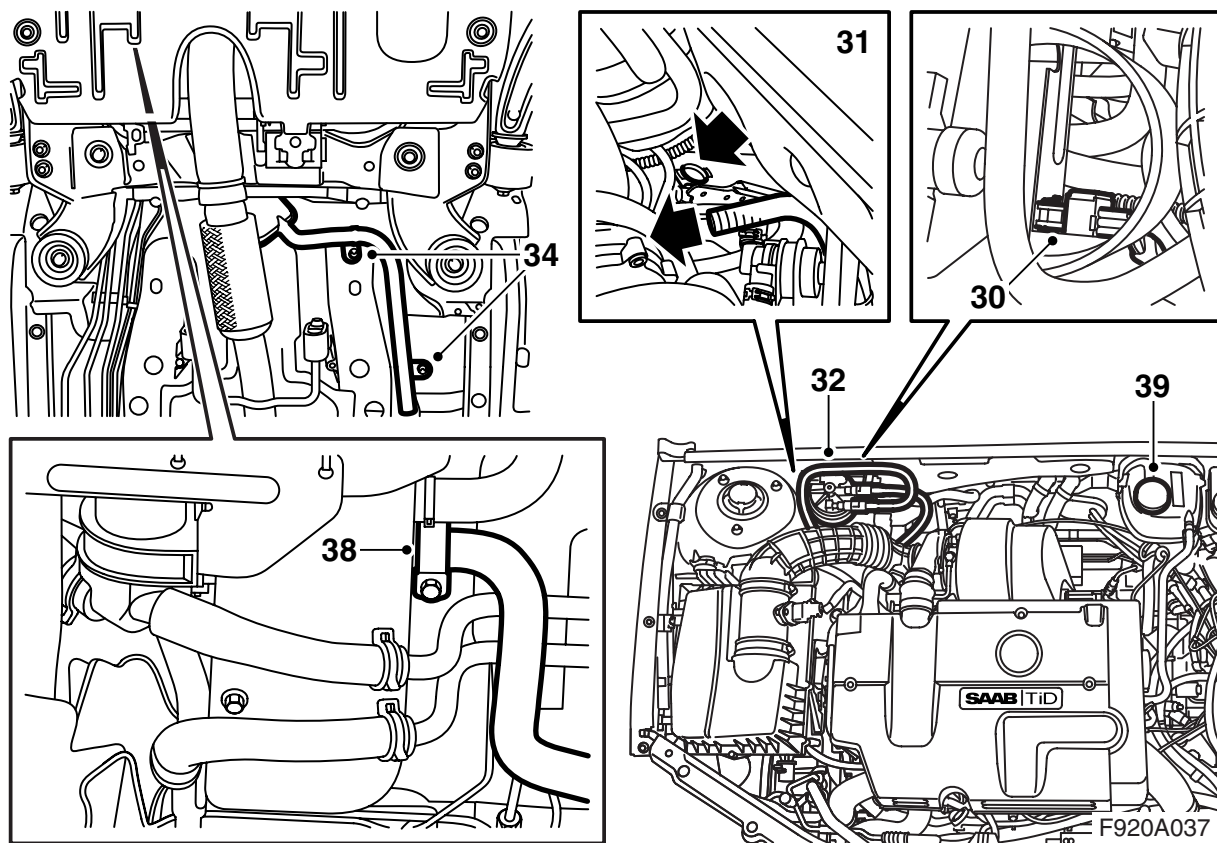

- 30 Plug the connector into the heater.
- 31 Run the heater intake hose through the hole in the longitudinal member.
- 32 Fit the fuel filter and connect it.
- 33 Raise the car.
- 34 Position the heater exhaust system and fit it to the floor of the car.
- 35 Close the radiator drain plug and remove the hose.
- 36 Lift up the spoiler shield, fit the bumper connector into the holder and plug in the connector.
- Cars with headlamp washers:** Hook the hose to the spoiler shield.
- All:** Fit the spoiler shield.
- 37 Lower the car.
- 38 Connect the exhaust pipe to the heater.
- 39 Fill with coolant and check the system for leaks. Fit the expansion tank cap.
- 40 Connect the negative battery cable.
- 41 Mount the engine cover.
- 42 Adjust the time and date.
- 43 Synchronise remote control code by inserting the key into the ignition.
- 44 Activate window lift pinch protection function by operating the side windows up and down twice. An audible confirmation will sound when activation is complete.

Important

Repeat this procedure with all keys. Otherwise, the remote controls will not function.

45 Bleed the cooling system in the following way:

Note

The A/C or ACC should be turned OFF.

Fill the cooling system to the MAX level. Close the expansion tank cap. Start the engine and run at varying engine speeds until the radiator fan cuts in. Carefully open the expansion tank cap and top up to the MAX level. Close the cap. Switch off the engine and if necessary top the coolant up to the MAX level.

46 Clean an area in the centre of the fuel filler flap hinge with benzine. Remove the label from the kit, adjust the size of the label if necessary and affix the label to the cleaned area.

Important

Under no circumstances may this label conceal any part of another label or plate.

-
- 47 **Cars with headlamp washers:** Check the function of the headlamp washers.
- 48 Connect the diagnostic tool, select car and model year, select "All", select "Add/Remove", select the accessory and then "Add".

Note

The diagnostic tool will on some occasions need to retrieve a security code in TIS. Information on what to do will be displayed on the diagnostic tool display.

- 49 Start the heater by pressing the SIDC button "CUSTOMIZE", select "Parking heater", press "SET", select "Manual control", press "SET", select "Heater on", press "SET" and make sure the heater starts (it has a delay of about 1 minute). Select "Manual control", press "SET", select "Heater off", press "SET" and check that the heater stops. Select "Back", press "SET", select "Finish" and press "SET".
- 50 Check the coolant level and top up as necessary.

Wiring diagram

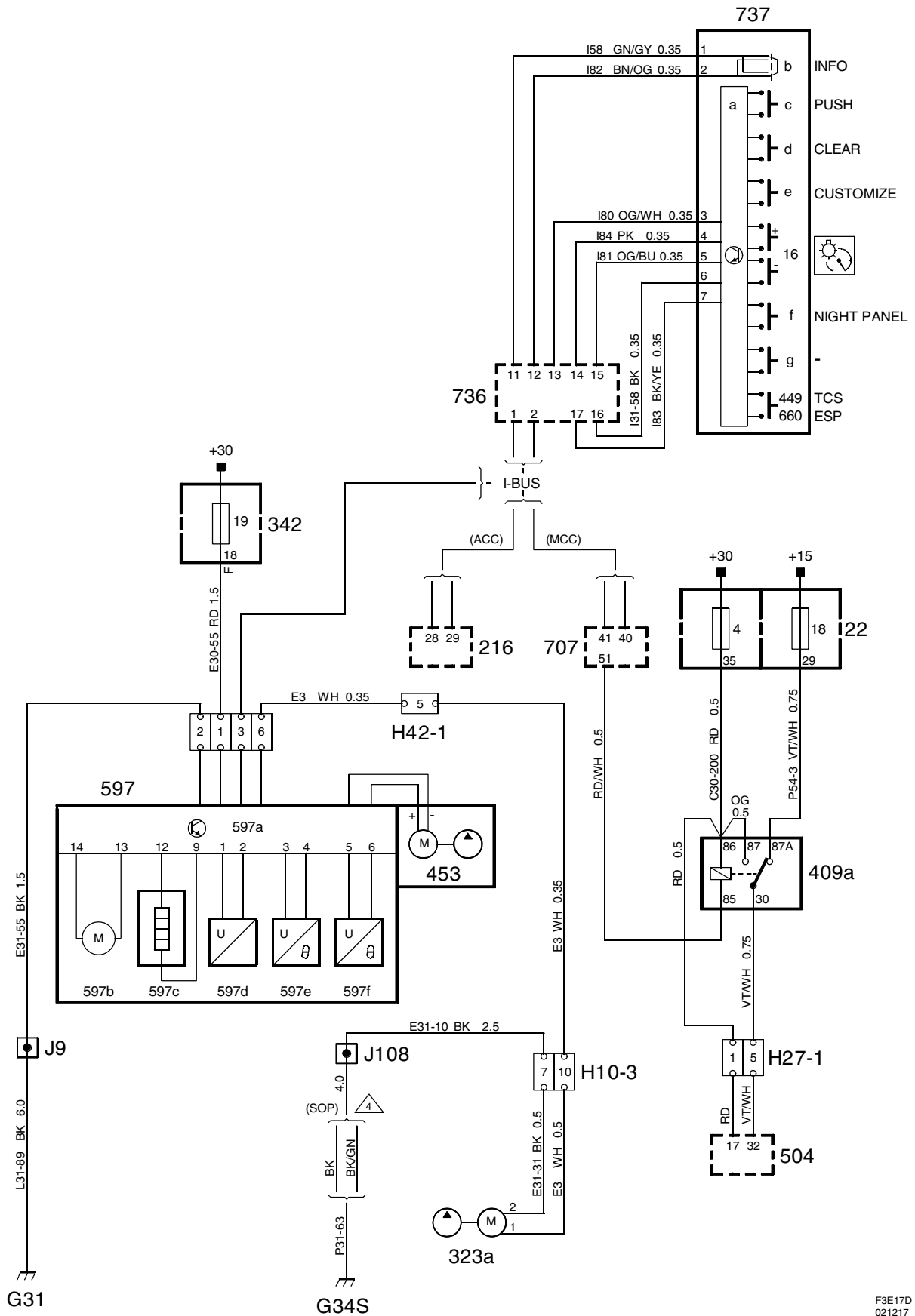

F3E17D
021217

List of components

No.	Name position
Components	
22	Main dashboard fuse box, on the short side of the instrument panel near the left-hand door
216	Control module, ACC, in the centre of the dashboard
323a	Motor, fuel pump, parking heater, in the fuel tank
342	Electrical distribution unit, engine bay, next to the battery
409a	Relay, parking heater, in the centre console on the dashboard support
453	Motor, pump, coolant circulation, on the parking heater
504	Control panel, heating&ventilation, in the centre of the dashboard
597	Parking Heater, in the engine bay on the right-hand side of the bulkhead partition
597a	Control module, parking heater, in the parking heater
597b	Motor, blower fan, parking heater, in the parking heater
597c	Glow plug, parking heater, in the parking heater
597d	Flame detector, parking heater, in the parking heater
597e	Temperature sensor, parking heater, in the parking heater
597f	Temperature sensor, parking heater, in the parking heater
707	Body Control Module, in the main dashboard fuse box
736	Control panel, infotainment, under the SID
737	Control panel, SID, on the dashboard next to the main instrument unit
10-pin connector	
H10-3	On a bracket near the tank strap on the front side of the fuel tank

No.	Name position
27-pin connector	
H27-1	Near the MCC control module
42-pin connector	
H42-1	Black connector in front of the battery on the side of the left-hand structural member
Crimp connections	
J9	Approx. 150 mm from branching point grounding point G31 towards LH headlamp
J108	Approx. 50 mm from branching point grounding point G34P/S towards the right-hand front door
Grounding points	
G31	In the engine bay on the side plate above the right-hand wheel housing
G34S	Near the floor below the right-hand A-pillar (green tape)