



**MONTERINGSANVISNING · INSTALLATION INSTRUCTIONS  
MONTAGEANLEITUNG · INSTRUCTIONS DE MONTAGE**

## Saab 9-5 5D -M01

Seat belt, rear seat centre

Accessories Part No.	Group	Date	Instruction Part No.	Replaces
52 06 776 52 06 784 93 185 776 93 185 777 93 186 998 93 186 999	8:53-21	Nov 05	52 06 859	52 06 859 Nov 04

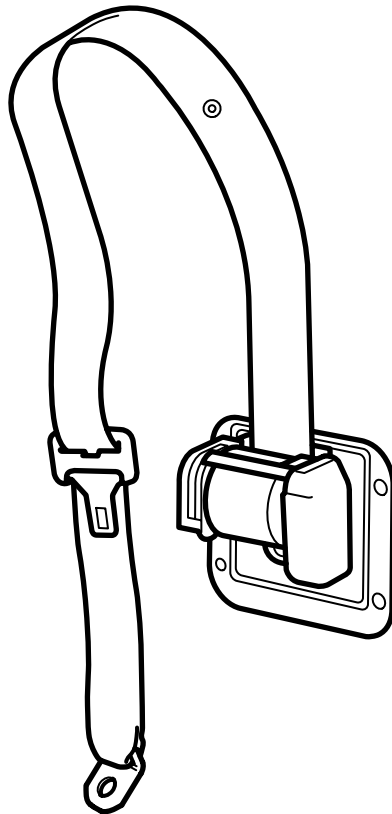

E980A295

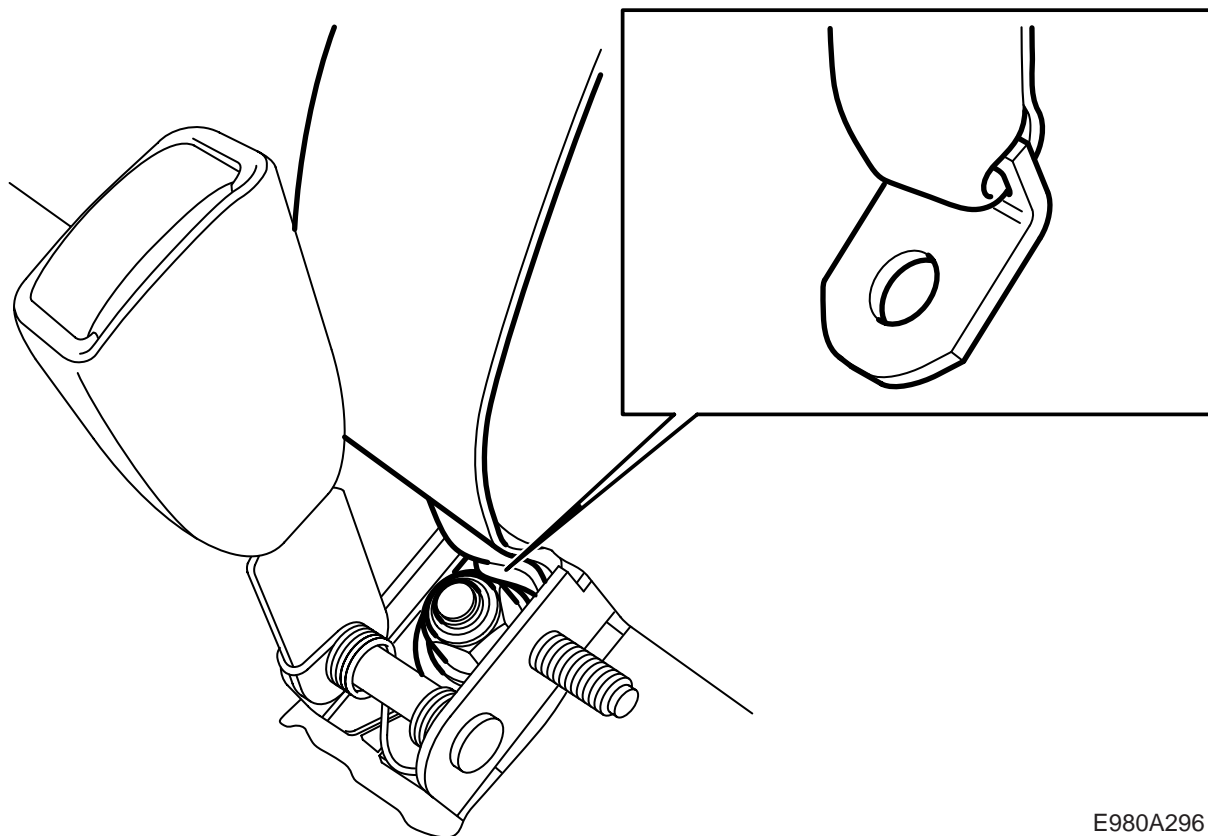

E980A296

### Supplement to description in WIS

When fitting the lower anchorage for the centre seat belt, the new belt must be mounted using the same nut as the one securing the seat belt buckle.

- 1 Remove the seat belt buckle nut and place the centre seat belt lower anchorage over the weld screw for the belt buckle.
- 2 Fit the seat belt buckle nut.

**Tightening torque 45 Nm (33lbf ft)**